

LAK-I-4.02

This sheet supersedes
Sheet No 213
Added 3-24-60 R.E.C.

Lt. Edge Pav't	Rt. Edge Median	Rt. Edge Pav't
0°30' Curve	1°30' Curve	0°30' Curve
Δ = 1°05'18"	Δ = 6°07'38"	Δ = 1°54'33"
D = 0°30'	D = 1°30'	D = 0°30'
R = 11,459.16	R = 3,819.72	R = 11,459.16
T = 108.84	T = 204.44	T = 190.95
L = 217.67	L = 408.48	L = 381.83
E = 0.52	E = 5.47	E = 8.37
P.C. Opp. 258+91.16	P.C. Opp. 268+44.21	P.C. Opp. 267+35
P.T. Opp. 261+08.82	P.C. Opp. 272+49.97	P.C. Opp. Sta. 271+17.09

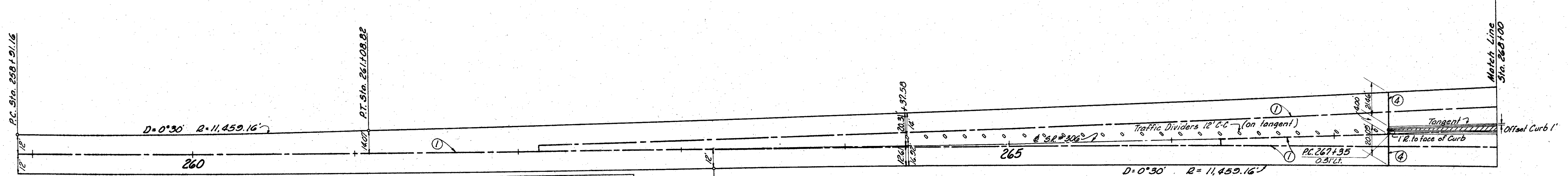

Station	Profile Grade	Lt. Pav't Edge	Lt. Median Edge	Rt. Median Edge	Rt. Pav't Edge
258+91.16	785.46	12.00	785.27	12.00	785.27
259+00	785.28	12.00	785.09		785.09
+25	784.75		784.56		784.56
+50	784.23	12.15	784.04		784.04
+75	783.70		783.51		783.51
260+00	783.18	12.52	782.98		782.98
+25	782.65		782.45		782.45
+50	782.13	13.10	781.93		781.93
+75	781.60		781.39		781.39
261+00	781.08	13.90	780.86		780.86
+25	780.55		780.33		780.33
+50	780.03	14.85	779.80		779.80
+75	779.50		779.26		779.26
262+00	778.98	15.80	778.73		778.73
+25	778.45		778.20		778.20
+50	777.93	16.75	777.67		777.67
+75	777.40		777.13		777.13
263+00	776.88	17.70	776.60	12.00	776.60
+25	776.35		776.07		776.16
+50	775.83	18.65	775.54	12.04	775.64
+75	775.31		775.01		775.12
264+00	774.80	19.60	774.44	12.29	774.56
+25	774.28		774.02		774.13
+50	773.77	20.55	773.45	12.75	773.57
+75	773.25		772.92		773.05
265+00	772.74	21.50	772.40	13.43	772.53
+25	772.23		771.89		772.01
+50	771.72	22.45	771.37	14.33	771.50
+75	771.22		770.86		770.99
266+00	770.71	23.40	770.34	15.45	770.47
+25	770.21		769.84		769.96

- ~LEGEND~
- ① Standard Longitudinal Joint
 - ② Standard Key Joint Without Tie Bars
 - ③ Expansion Joint Without Dowels (Located on radial lines.)
 - ④ Expansion Joint With Dowels.

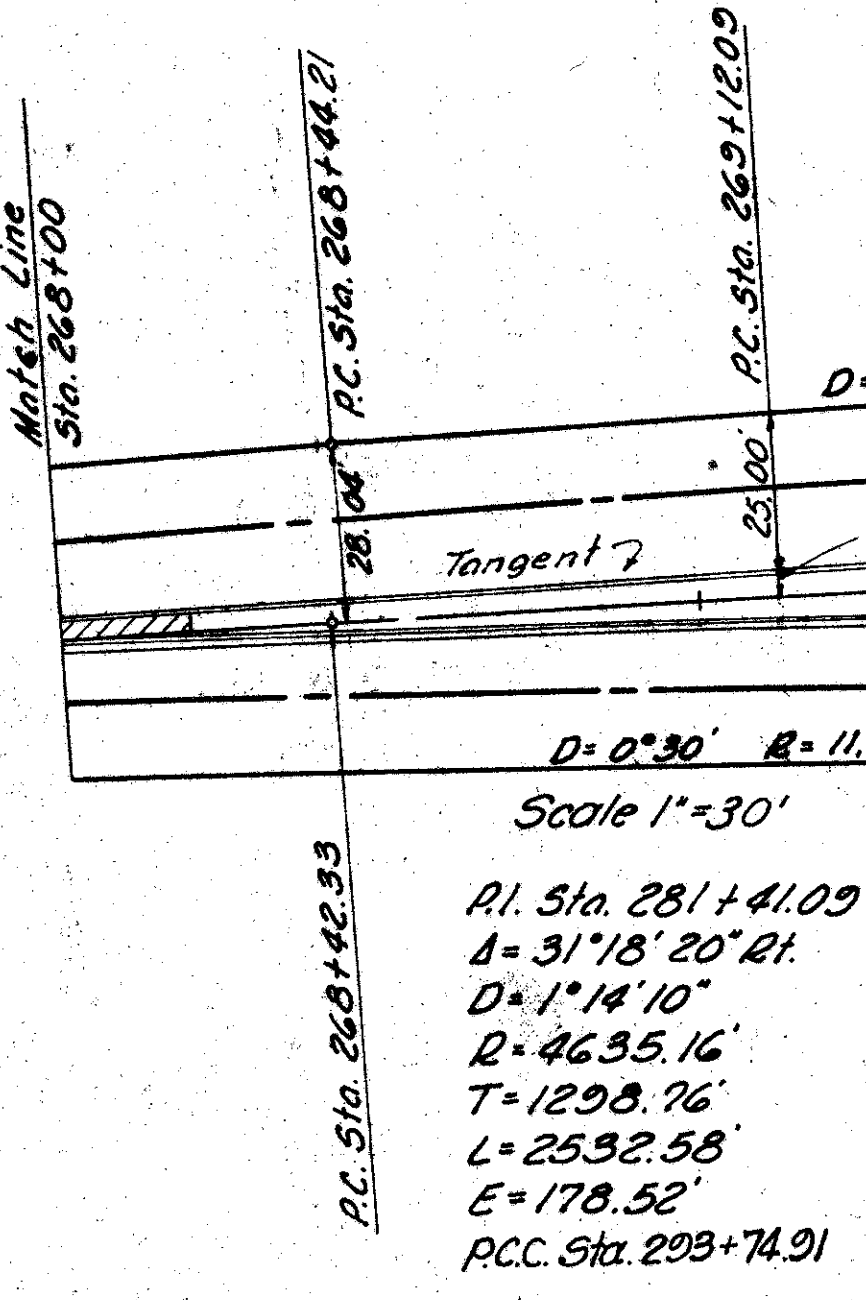
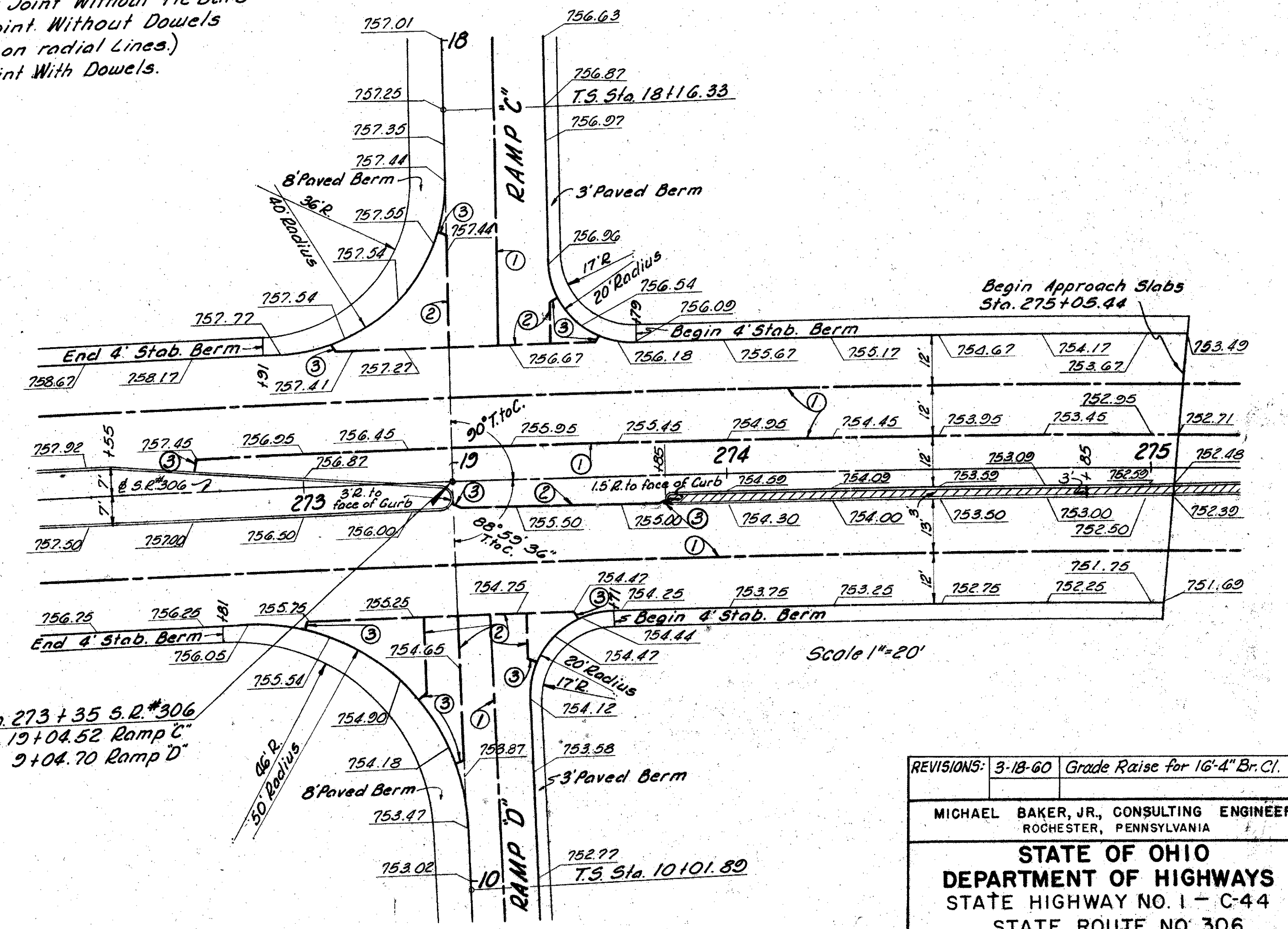

Station	Profile Grade	Lt. Pav't Edge	Lt. Median Edge	Rt. Median Edge	Rt. Pav't Edge
266+50	769.71	24.35	769.41		769.45
+75	769.21		768.96		768.94
267+00	768.71	25.30	768.53	18.34	768.42
+25	768.21		768.09		768.01
+50	767.71	26.25	767.66	3.51	767.70
+75	767.21		767.24	3.53	767.21
268+00	766.71	27.20	766.90	3.59	766.70
+25	766.21		766.52	0.73	766.37
+50	765.76	28.00	766.28	7.68	765.96
+75	765.21	28.15	766.18	2.15	765.96
269+00	764.71	29.05	765.80	2.42	765.50
+25	764.21		765.84	29.96	765.30
+50	763.71	29.83	765.40	765.77	764.65
+75	763.21		765.09	765.30	764.00
270+00	762.71	30.50	765.62	765.14	763.39
+25	762.21		765.37	764.82	762.87
+50	761.71	31.04	765.64	3.97	762.34
+75	761.21		765.14	6.12	761.82
271+00	760.71	31.46	765.65	6.98	761.31
+25	760.21		765.37	761.51	760.79
+50	759.71	31.96	765.66	761.00	760.28
+75	759.21		765.16	760.50	759.77
272+00	758.71	31.94	759.67	7.00	759.26
+25	758.21		759.11	759.50	758.75
+50	757.71	32.00	758.67	759.00	758.25
+75	757.21		758.17	758.50	757.75
+99.97	756.71		757.67	758.00	757.25

REVISIONS: 3-18-60 Grade Raise for 16'-4" Br. C.

MICHAEL BAKER, JR., CONSULTING ENGINEERS
ROCHESTER, PENNSYLVANIA

STATE OF OHIO
DEPARTMENT OF HIGHWAYS
STATE HIGHWAY NO. 1 - C-44
STATE ROUTE NO. 306
PAVEMENT TRANSITION AND
INTERSECTION DETAILS

Designed	Drawn	Traced	Checked	Reviewed Date	Revised
H.V.	A.G.	A.H.	B.R.		