

This sheet supersedes
Sheet No. 186
Added 3-24-60 R.E.C.

LAKE COUNTY
LAK-1-4.02

186-5
333

$P.I. Sta 10+96.03$
 $\Delta = 10^{\circ}00'$
 $Ts = 250.45'$
 $Es = 7.30'$
 $\theta s = 5^{\circ}00'$
 $Ls = 250.00'$
 $p = 1.82'$
 $k = 124.97'$

Note: Pavement Cross Slope
 $\frac{3}{16}$ per ft. from
Sta. 9+00 to Sta. 18+00

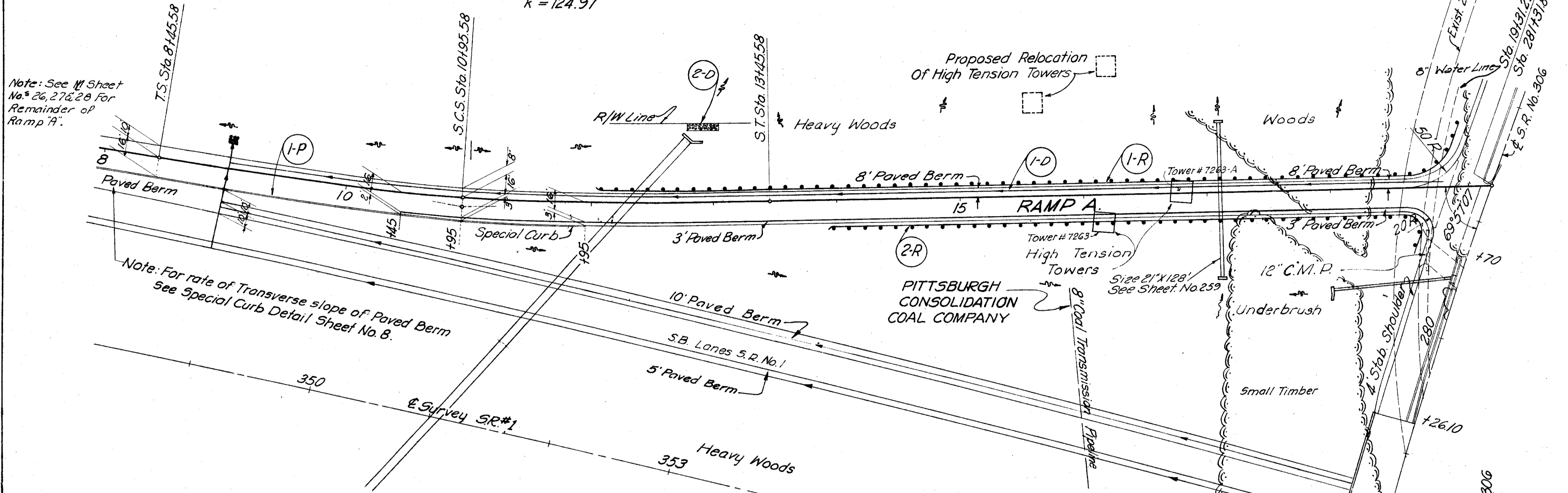

OFFSETS & ELEVATIONS FOR RAMP "A" TAPER

Sta. & S.R. No.	Offset Lt.	El. Lt. Edge	Sta. & S.R. No.	Offset Lt.	El. Lt. Edge
332+41.41	126.50	705.15	341+00	122.22	711.05
150	126.50	705.21	+25	122.74	711.21
+75	126.50	705.39	+50	123.26	711.38
333+00	126.67	705.57	+75	123.78	711.55
+25	126.85	705.74	342+00	124.30	711.72
+50	127.09	705.91	+25	124.82	711.90
+75	127.39	706.09	+50	125.34	712.07
334+00	127.76	706.26	+75	125.86	712.24
+25	128.18	706.44	343+00	126.38	712.41
+49.73	128.67	706.60	+25	126.90	712.57
+50	128.68	706.61	+50	127.43	712.75
+75	128.80	706.78	+75	127.95	712.92
335+00	129.22	706.95	344+00	128.47	713.09
+25	130.24	707.11	+25	128.99	713.26
+50	130.76	707.29	+50	129.51	713.43
+75	131.28	707.46	+75	129.53	713.59
336+00	131.80	707.63	345+00	130.55	713.77
+25	132.32	707.80	+25	131.07	713.94
+50	132.84	707.97	345+45.58 Br	131.50	714.08
+75	133.36	708.15	+545.58 Ah	End Offsets Begin @	El. Lt. Edge
337+00	133.88	708.32	El. Rt. Edge	El. Lt. Edge	
+25	134.40	708.48	+50	714.52	714.10
+50	134.93	708.65	+75	714.46	714.24
+75	135.45	708.82	+100	714.62	714.40
338+00	135.97	708.99	+25	714.75	714.52
+25	136.49	709.17	+50	714.90	714.67
+50	137.01	709.34	+75	715.02	714.79
+75	137.53	709.51	+100	715.15	714.92
339+00	138.05	709.68	+25	715.29	715.05
+25	138.57	709.84	+50	715.42	715.18
+50	139.09	710.02	+75	715.53	715.28
+75	139.61	710.19	+100	715.63	715.38
340+00	140.13	710.36	+25	715.71	715.46
+25	140.65	710.53	+50	715.78	715.53
+50	141.18	710.70	+75	715.84	715.59
+75	141.70	710.87	+100	715.88	715.63

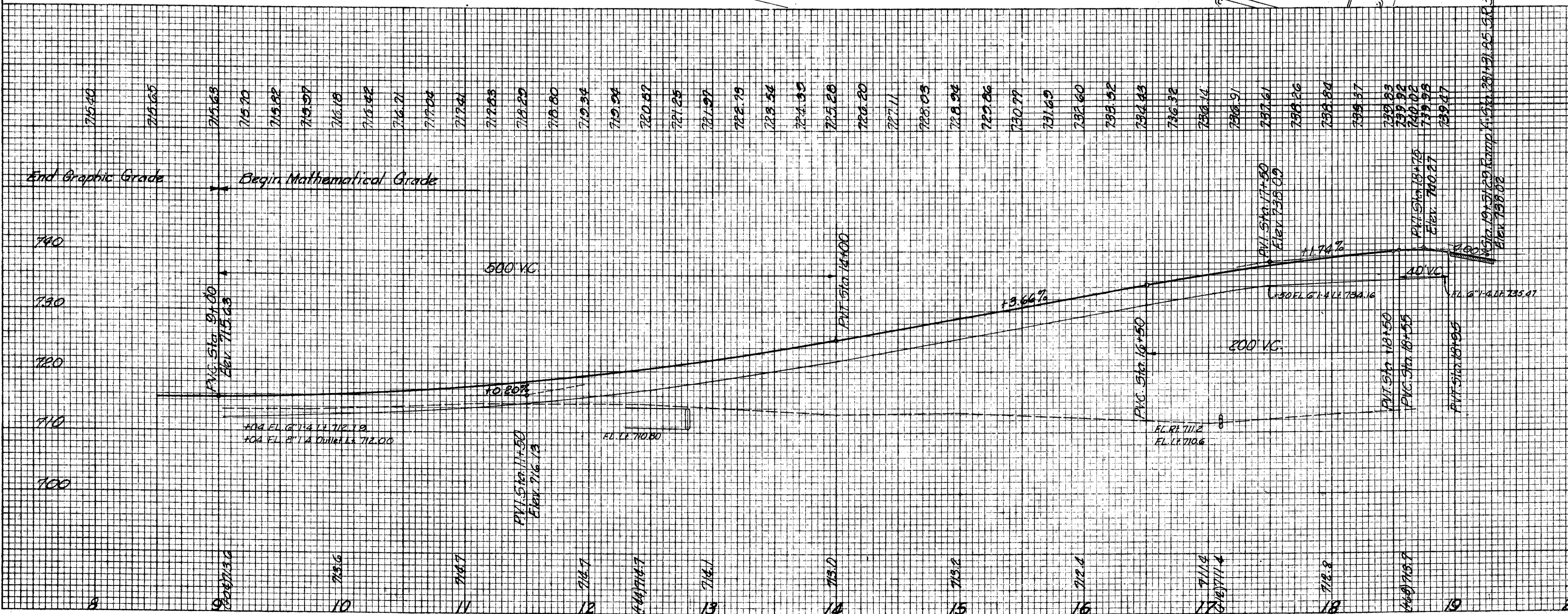

Ref. No.	Station		Side &	I-15 Guard Rail Dwg. No. 28 Lin. Ft.	I-12 Conc. Curb Special Lin. Ft.
	From	To			
1-R	12+07	18+96.59	Lt.	744.50	
2-R	13+76	18+96.59	Rt.	429.50	
1-P	5+45.58	11+95	Rt.		655
Totals				1234.00	655

See Sheet No.	Ref. No.	Station		Side &	I-4 Underdrain (Shallow) Lin. Ft.	I-10 Dumped Back Cr. Protection Cu. Yds.
		From	To			
240	1-D	9+04	18+92 Ramp A	Lt.	288	
244	2-D	9+52+60		Lt.		12
Totals					288	12

REVISIONS: 3-18-60 Grade Raise for 16'-4" Br.C.
 MICHAEL BAKER JR., CONSULTING ENGINEERS
 ROCHESTER, PENNSYLVANIA
 STATE OF OHIO
 DEPARTMENT OF HIGHWAYS
 STATE HIGHWAY NO. 1
 C-44
 S.R. NO. 306 INTERCHANGE RAMP-A
 STA. 8+00 TO STA. 19+00
 Designed: H.V. Drawn: R.P. Traced: R.G. Checked: R.G. Reviewed: Date: Revised:

RAMP A STA. 8+00 TO STA. 19+00

DATE: _____ BY: _____
 ORIGINAL SURVEY PLOTTED _____
 NOTE BOOK TEMPLATE _____
 AREAS CHECKED _____

DATE: _____ BY: _____
 ORIGINAL SURVEY PLOTTED _____
 NOTE BOOK TEMPLATE _____
 AREAS CHECKED _____