

MICROFILMED
DEC 17 1967

FED. RD. DIVISION	STATE	PROJECT
2	OHIO	I-1103 (20) S-46 (7)

1803
333

This sheet supersedes
Sheet No. 180
Added 3-24-60 R.E.C.

LAKE COUNTY
LAK-I-4.02

FINAL SURVEY PLOTTED TEMPLATE NO. 7 AREAS CHECKED

DATE BY

P.I. Sta. 14+40.50
Ls = 250'
θs = 8°45'
p = 3.18'
k = 124.90'
LT = 166.87'
ST = 83.52'

P.I. Sta. 17+19.42
D = 26°54'20"
D = 7°00'
R = 818.51
T = 195.79
L = 384.37
E = 23.05

P.I. Sta. 12+09.07
90° Offset, D = 12°00'

P.I. Sta. 14+42
D = 18°11'

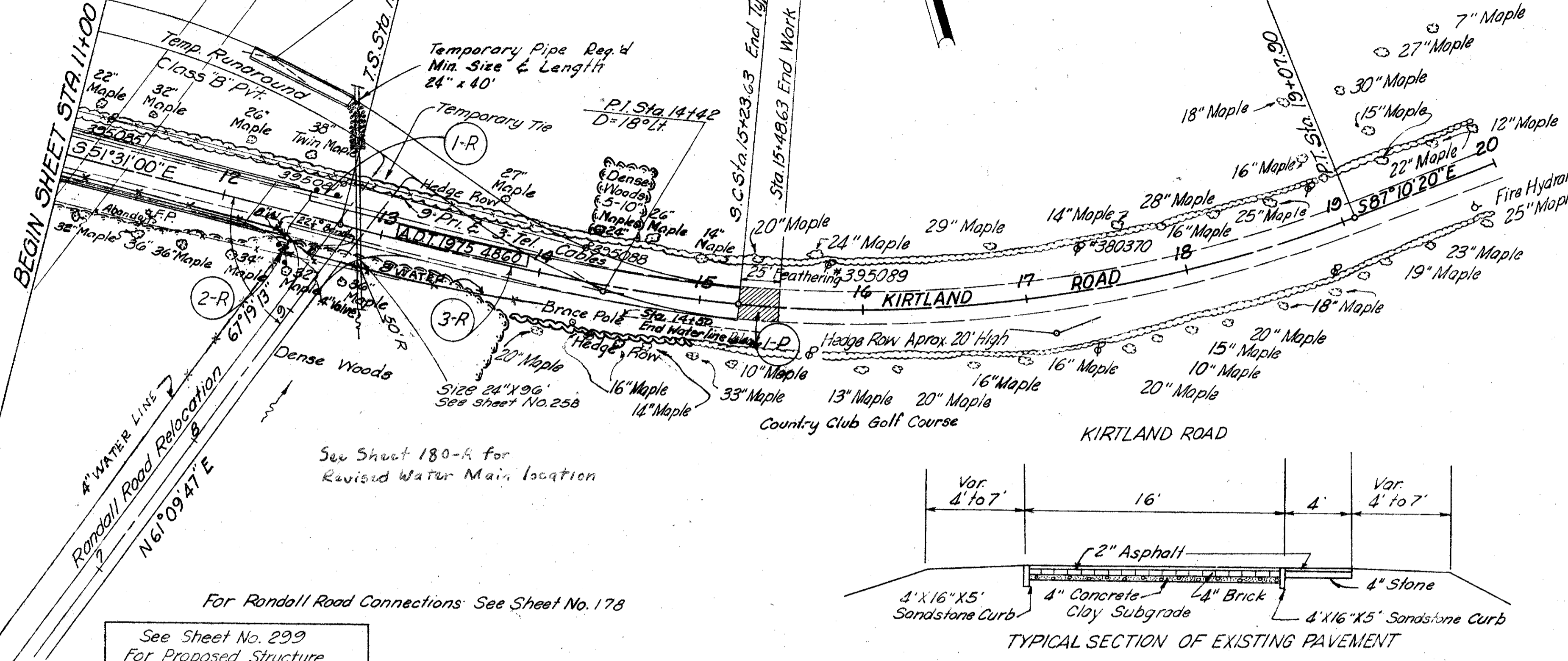

Ref. No.	Station		Side &	I-15 Guard Rail Dwg. No. 2-A Lin. Ft.	E-8 Removal of Exist. Pav't Sq. Yds.	I-9 Stone Undrn. No. 2 Lin. Ft.	T-35 Asphaltic Conc. Surf. Course Cu. Yds.
	From	To					
1-R	12+42.28	12+67.28	Lt.	25			
2-R	12+27.92	12+46	Rt.	25			
3-R	11+00	15+23.63	E		941.4		
1-P	15+23.63	15+48.63	E				116
	12+35	13+50	Rt.			30	
	12+50	15+00	Lt.			60	
Totals				50	941.4	90	116

Sta.	Ledge	Int. Rledge	Rledge
12+13.63	736.21	736.37	736.21
+75	736.26	736.42	736.26
13+00	737.10	737.26	737.17
+25	737.04	738.10	738.07
+50	738.78	738.04	738.98
+75	739.63	739.79	739.88
14+00	740.47	740.63	740.76
+25	741.27	741.47	741.67
+50	742.11	742.31	742.51
+75	742.96	743.16	743.36
15+00	743.80	744.00	744.20
+23.63	744.59	744.79	744.99

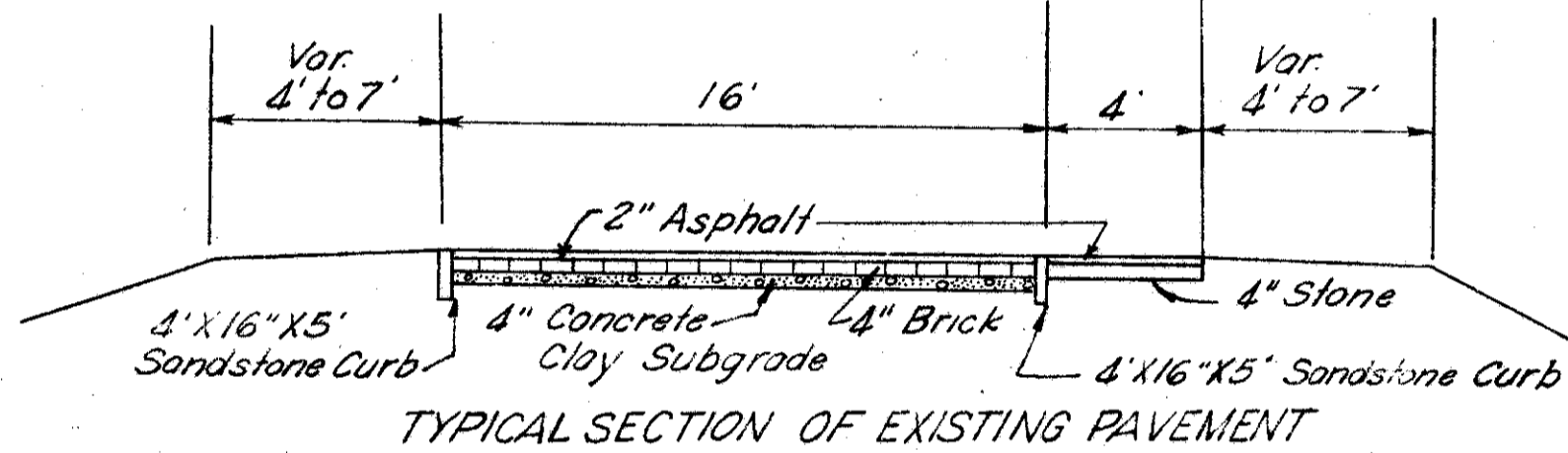

See Sheet No. 299
For Proposed Structure

For Randall Road Connections See Sheet No. 178

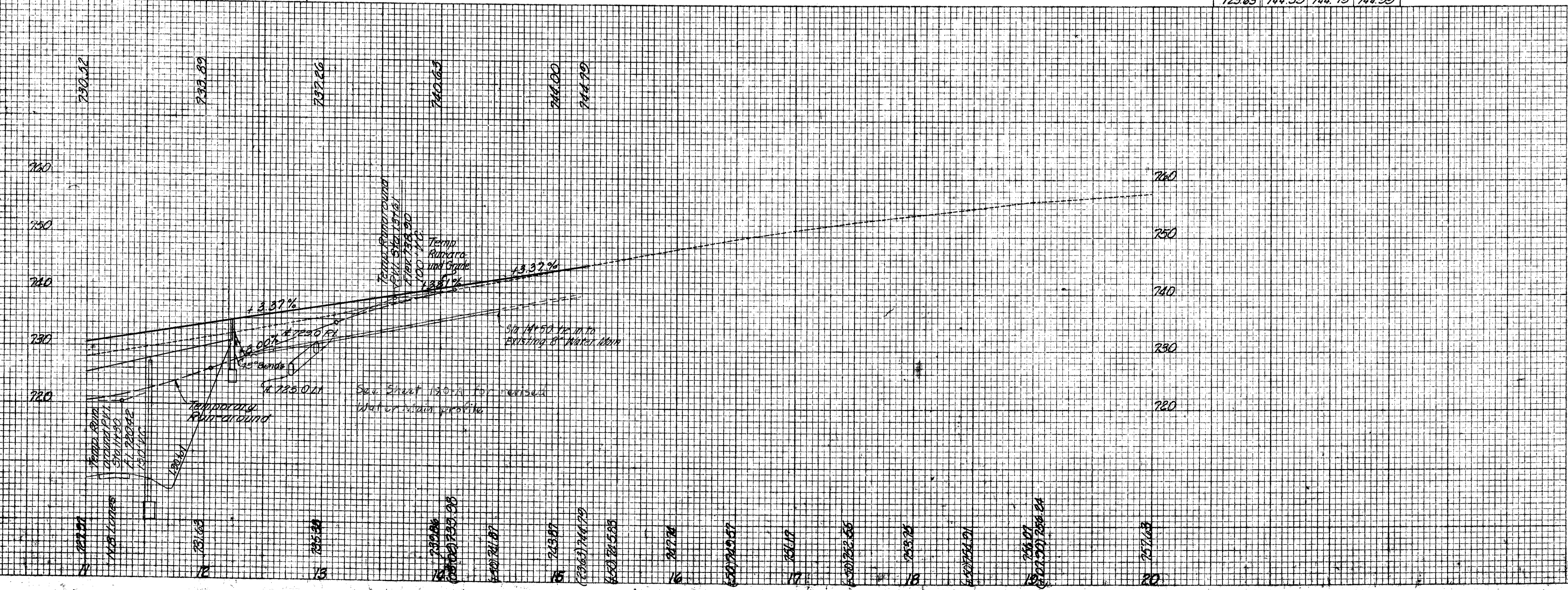

REVISIONS: 5-27-59 Water Main Relocated Sta. 11+00 to 14+50
3-18-60 Grade Raise for 16" 4" Br. Cl.

MICHAEL BAKER, JR., CONSULTING ENGINEERS
ROCHESTER, PENNSYLVANIA

STATE OF OHIO
DEPARTMENT OF HIGHWAYS
STATE HIGHWAY NO. 1
C-44
PLAN & PROFILE
STA. 11+00 - STA. 20+00

Designed	Drawn	Traced	Checked	Reviewed Date	Revised
R.G.	R.P.	K.A.	B.P.		

Rev. 6-24-60
R.E.C.