

Seeding	
End Width	Sp. Vd.
204	
2267	
204	
2267	
204	
2267	
204	
2267	
204	
2267	

End Area		Volume	
Cut	Fill	Cut	Fill
3899	0		
4251	0	15,093	0
4428	0	16,072	0
4484	46	16,577	22
4484	46		
41			
41			
16,839	22		

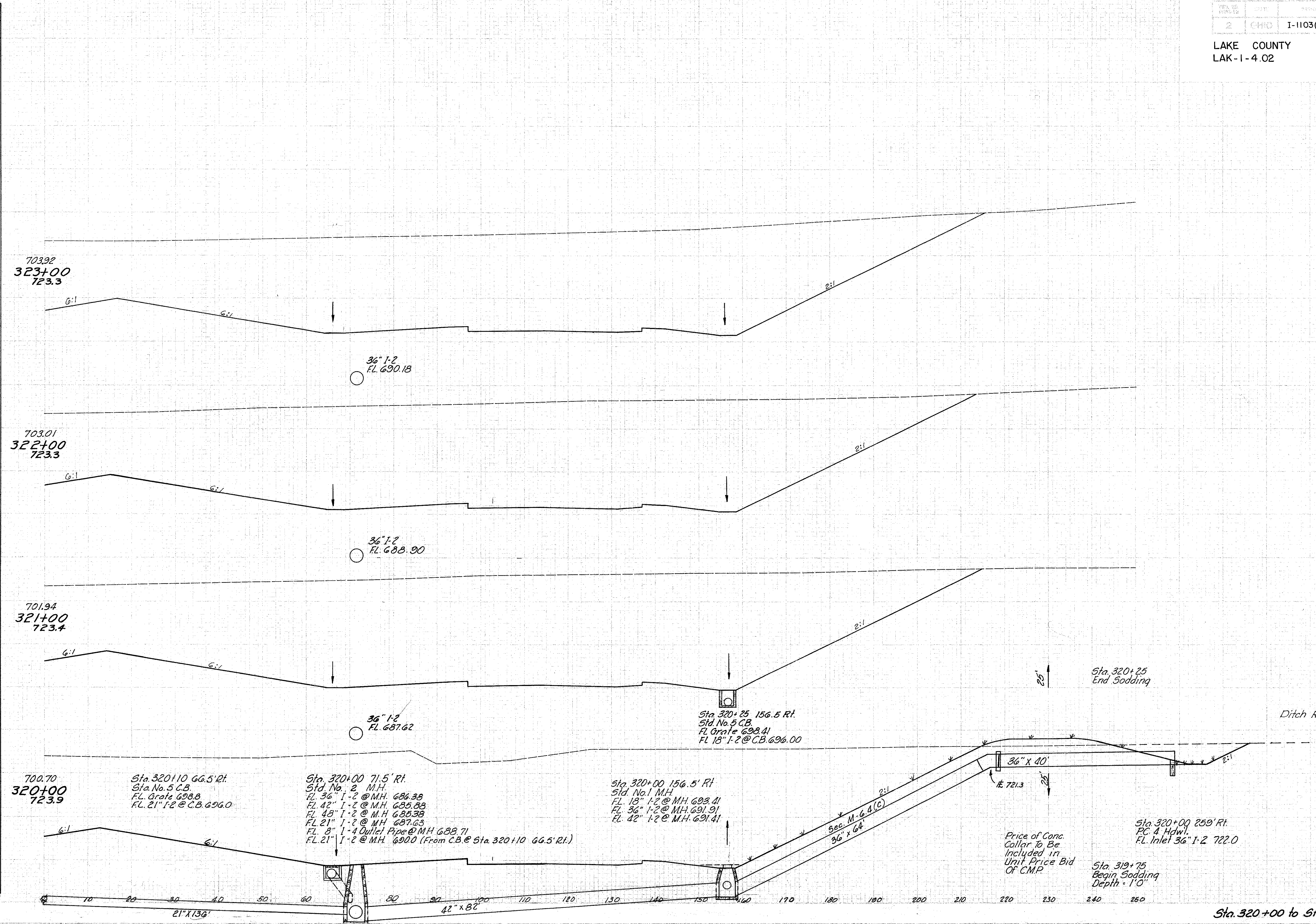

703.92
323+00
723.3

703.01
322+00
723.3

701.94
321+00
723.4

700.70
320+00
723.9

Sta. 320+10 66.5' Rt.
Std. No. 5 C.B.
FL. Grate 698.8
FL. 21" I-2 @ C.B. 696.0

Sta. 320+00 71.5' Rt.
Std. No. 2 M.H.
FL. 36" I-2 @ M.H. 686.38
FL. 42" I-2 @ M.H. 685.83
FL. 48" I-2 @ M.H. 685.38
FL. 21" I-2 @ M.H. 687.63
FL. 8" I-4 Outlet Pipe @ M.H. 688.71
FL. 21" I-2 @ M.H. 690.0 (From C.B. @ Sta. 320+10 66.5' Rt.)

Sta. 320+00 156.5' Rt.
Std. No. 1 M.H.
FL. 18" I-2 @ M.H. 693.41
FL. 36" I-2 @ M.H. 691.91
FL. 42" I-2 @ M.H. 691.41

Sta. 320+25 156.5' Rt.
Std. No. 5 C.B.
FL. Grate 698.41
FL. 18" I-2 @ C.B. 696.00

Sta. 320+25
End Seeding

Price of Conc.
Collar to Be
Included in
Unit Price Bid
Of C.M.P.

Sta. 320+00 250' Rt.
PC 4 Hdwl.
FL. Inlet 36" I-2 722.0

Sta. 319+75
Begin Seeding
Depth = 1'0"

Sta. 320+00 to Sta. 323+00 Rt. 4