

MICROFILMED
DEC 17 1987

FED. RD. DIVISION	STATE	PROJECT
2	OHIO	I-1103 (20) 5-46 (7)

29
333

- LEGEND-
- ① Standard Longitudinal Joint
 - ② Standard Key Joint without Tie Bars
 - ③ Expansion Joint without Dowels (Loc. on rad. line)
 - ④ Expansion Joint with Dowels.

LAKE COUNTY
LAK-1-4.02

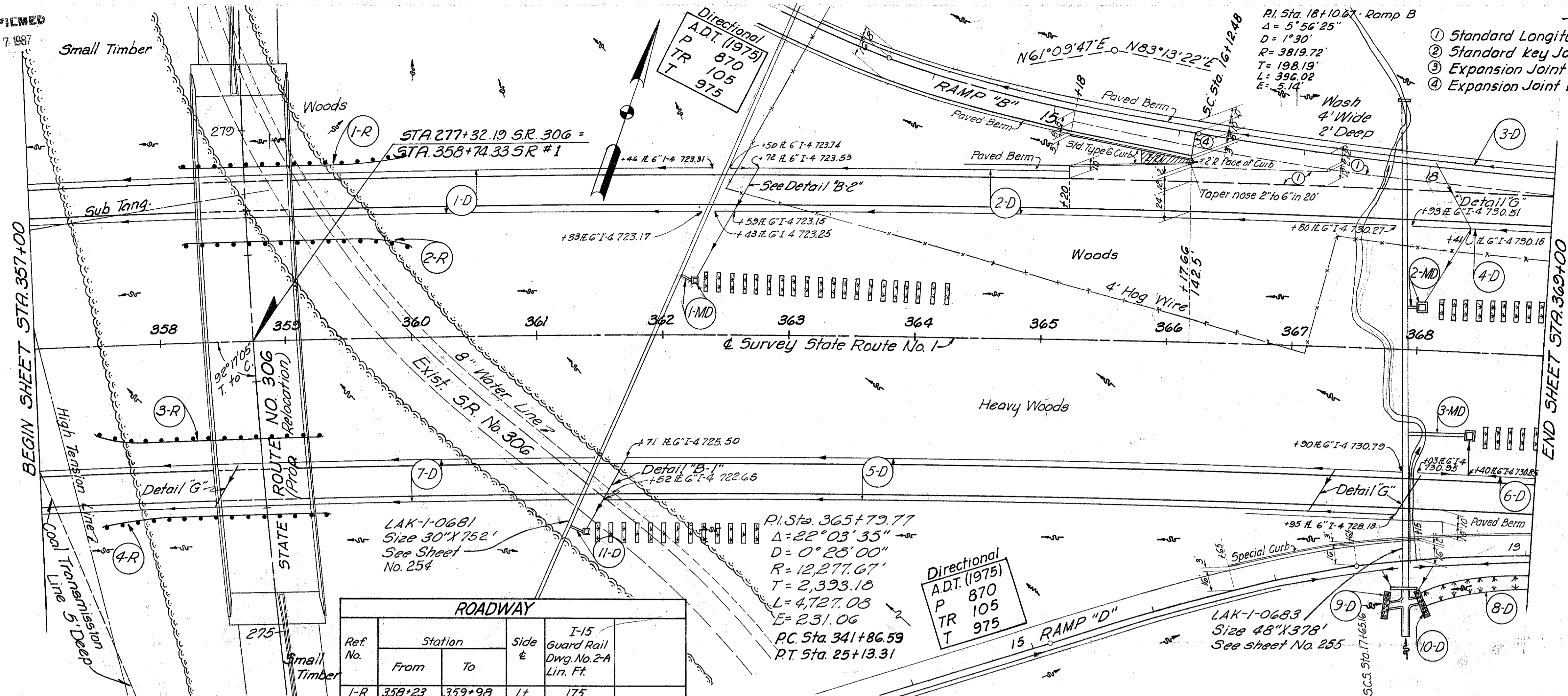

ROADWAY				
Ref No.	Station		Side	I-15 Guard Rail Dwg. No. 2-A Lin. Ft.
	From	To		
1-R	358+23	359+98	Lt.	175
2-R	358+23	359+98	Lt.	175
3-R	357+49	359+24	Rt.	175
4-R	357+49	359+24	Rt.	175
Totals				700

Station	North Bound Lanes	South Bound Lanes
722.10	726.10	722.92
723.63	726.75	723.63
724.35	727.40	724.35
724.63	727.66	724.63
724.82	727.84	724.82
725.06	728.05	725.06
725.15	728.13	725.15
725.27	728.24	725.27
725.44	728.35	725.44
725.60	728.46	725.60
725.78	728.57	725.78
725.92	728.68	725.92
726.14	728.79	726.14
726.33	728.90	726.33
726.54	729.01	726.54
726.75	729.12	726.75
726.98	729.23	726.98
727.21	729.34	727.21
727.46	729.45	727.46
727.70	729.56	727.70
727.97	729.67	727.97
728.24	729.78	728.24
728.52	729.89	728.52
728.78	729.99	728.78
729.11	730.10	729.11
729.42	730.21	729.42
729.74	730.32	729.74
730.06	730.43	730.06
730.40	730.54	730.40
730.75	730.65	730.75
731.11	730.76	731.11
731.43	730.87	731.43
731.86	730.98	731.86
732.24	731.09	732.24
732.63	731.20	732.63
733.06	731.31	733.06
733.44	731.42	733.44
733.73	731.53	733.73
733.95	731.64	733.95
734.28	731.75	734.28
734.56	731.86	734.56
734.92	731.97	734.92
735.25	732.08	735.25
735.61	732.19	735.61
735.98	732.30	735.98

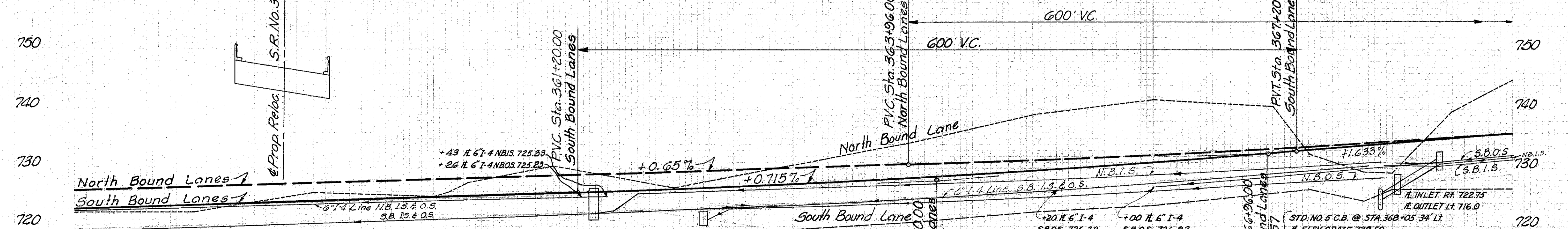

Station	North Bound Lane	South Bound Lane
357	722.1	718.0
358	722.2	717.2
359	725.7	718.1
360	725.2	717.3
361	730.3	718.1
362	726.7	718.5
363	730.5	719.5
364	730.0	720.7
365	729.0	722.3
366	741.6	723.6
367	732.3	725.7
368	729.1	726.4
369	732.6	726.5

See Sheet No.	Station	Side	Station		Type	Depth	Material	Notes
			From	To				
166	362+25	Lt.	362+25	362+25	11"	10'	Underdrain	
170	368+05	Lt.	368+05	368+05	8"	10'	Underdrain	
171	368+40	Rt.	368+40	368+40	8"	10'	Underdrain	
240	362+25	Lt.	362+25	362+25	8"	10'	Underdrain	
240	367+80	Lt.	367+80	367+80	8"	10'	Underdrain	
240	369+00	Lt.	369+00	369+00	8"	10'	Underdrain	
240	367+93	Lt.	367+93	367+93	8"	10'	Underdrain	
240	367+96	Rt.	367+96	367+96	8"	10'	Underdrain	
240	369+00	Rt.	369+00	369+00	8"	10'	Underdrain	
241	357+00	Rt.	357+00	357+00	8"	10'	Underdrain	
244	367+14	Rt.	367+14	367+14	8"	10'	Underdrain	
244	367+83	Rt.	367+83	367+83	8"	10'	Underdrain	
244	368+11	Rt.	368+11	368+11	8"	10'	Underdrain	
165	367+56	Rt.	367+56	367+56	8"	10'	Underdrain	
Total					143	28	54	40+15

MICHAEL BAKER, JR., CONSULTING ENGINEERS
ROCHESTER, PENNSYLVANIA

STATE OF OHIO
DEPARTMENT OF HIGHWAYS
STATE HIGHWAY NO. 1
C-44
PLAN AND PROFILE
STA. 357+00 TO STA. 369+00

Designed	Drawn	Traced	Checked	Reviewed	Date	Revised
B.P.	K.A.	A.H.	E.H.			

PLAN & PROFILE STA. 357+00 - STA. 369+00