

ITEM	DESCRIPTION	QUANTITY	UNIT
001	Dumped Rock Fill, Type C Sta. 362+45, 21' Rt. from Edge of Pavement	12	Cu. Yds.

Ref. No.	Station	Side	202	202	202	606	606	606	606		
			G.R. Removed for Reuse or Storage Painted	G.R. Removed for Reuse Galv.	B.R. for Reuse or Storage Painted	G.R. Type 5 as per plan	Anchor Assembly	Anchor Assembly, Barrier Design	Bridge Terminal Assembly		
	From	To	Lin. Ft.	Lin. Ft.	Lin. Ft.	Lin. Ft.	Each	Each	Type E Each	Type FM Each	
R-1	315+00	316+78	Rt.	178			175			1	
R-2	315+00	317+16	Rt.	216			216			1	
R-3	316+77	318+27	Lt.	150							
R-4	316+88	318+63	Lt.	175							
R-5	318+71	331+33.5	Rt.	1112.5			1237.5	1		1	
R-6	319+09	319+59	Rt.	137.5			25	1		1	
R-7	320+07	322+82	Lt.	287.5			250	1		1	
R-8	320+44	330+56.5	Lt.	937.5			987.5	1		1	
R-9	344+50	355+00	Lt.	1150			1025	1			
R-10	343+75	353+75	Rt.	912.5			950	2			
R-11	367+87.5	371+25	Rt.	250			287.5	2			
R-12	368+78	372+15.5	Lt.	250			287.5	2			
R-13	367+95	372+07.5	Lt.	375		50	72.5		2		
R-14	374+15	375+00	Rt.			85					
Totals				5953.5	178	135	6166	11	2	4	2

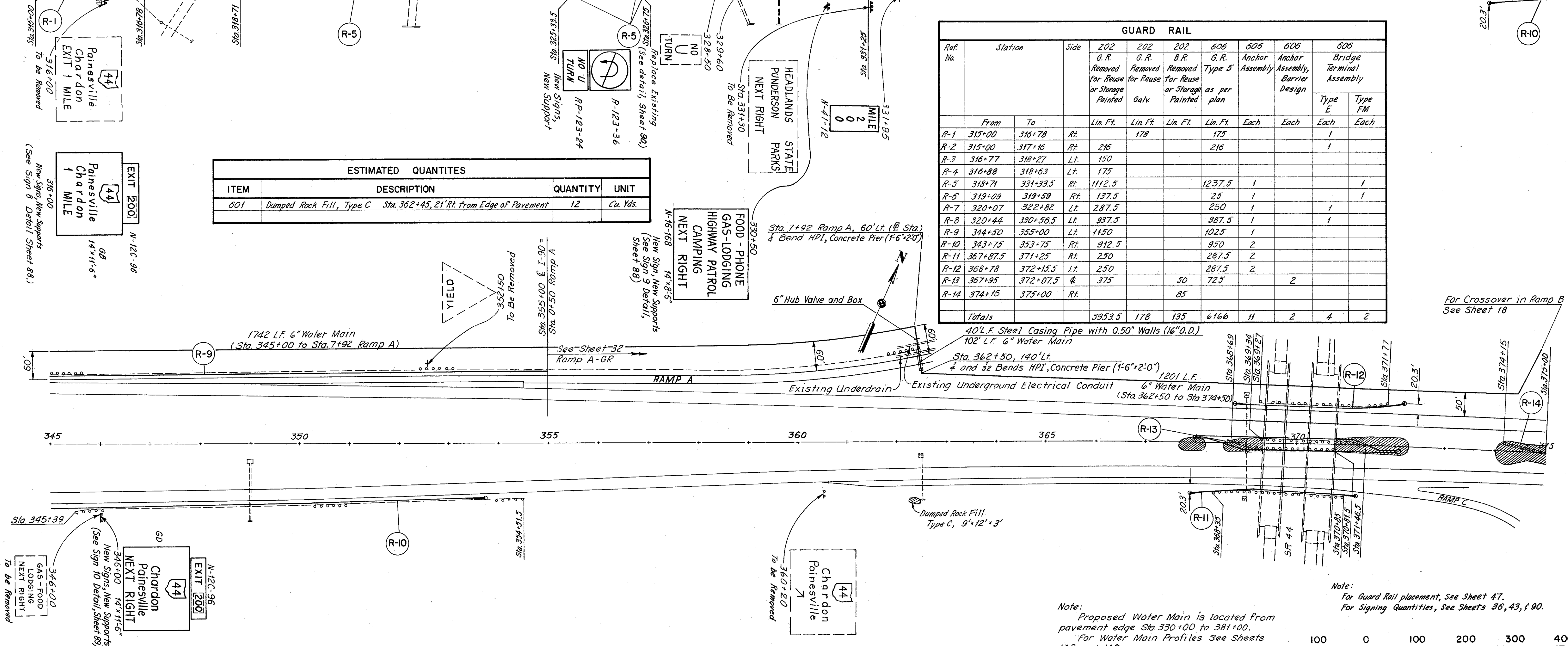

Note:
Proposed Water Main is located from pavement edge Sta. 330+00 to 381+00.
For Water Main Profiles See Sheets 108 and 109.

Note:
For Guard Rail placement, See Sheet 47.
For Signing Quantities, See Sheets 36, 43, & 90.

