

Ref No.	Station	Side	GUARD RAIL				
			202 G.R. Removed for Storage or Storage Painted	202 G.R. Removed for Reuse Galv.	606 G.R. Type 5 as per plan	606 Anchor Assembly	
	From	To	Lin. Ft.	Lin. Ft.	Lin. Ft.	Each	
R-1	327+42	329+54.5	Rt. 125		162.5	2	
R-2	327+70	329+82.5	Rt. 137.5		162.5	2	
R-3	327+33	329+45.5	Lt. 137.5		162.5	2	
R-4	327+61	329+73.5	Lt. 137.5		162.5	2	
R-5	333+72	334+22	Rt.	50			
R-6	357+14	359+64	Rt. 175		200	2	
R-7	357+18	359+68	Rt. 175		200	2	
R-8	357+82	360+32	Lt. 175		200	2	
R-9	357+87	360+37	Lt. 175		200	2	
R-10	14+17	14+67	Lt.	50			
R-11	16+73 Ramp D	18+35.5	Rt.	162.5			
Totals				1400	100	1450	16

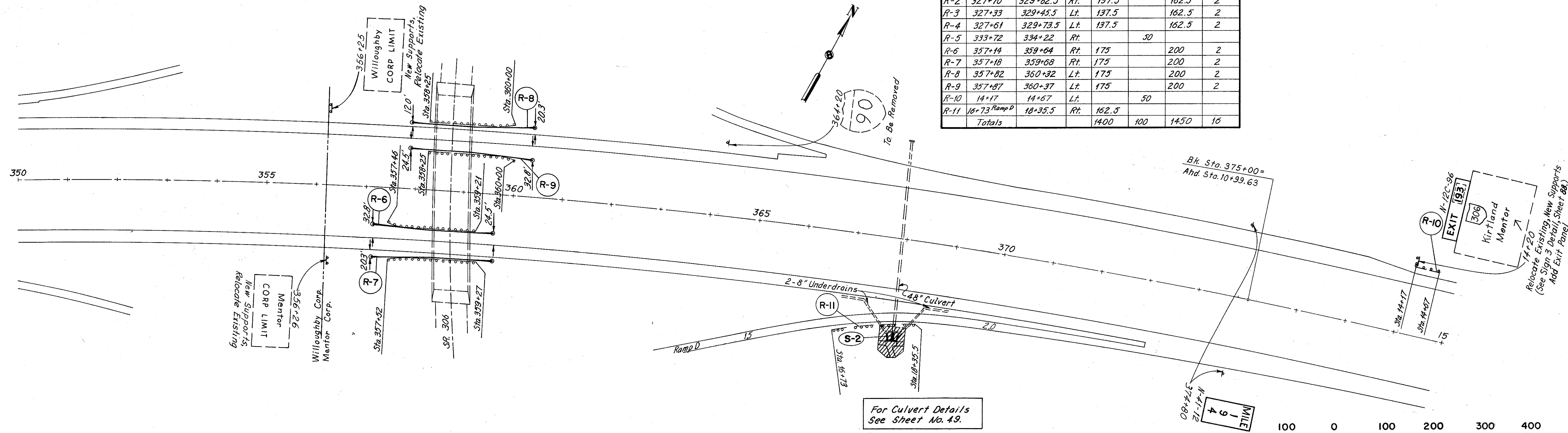

For Culvert Details See Sheet No. 43.

Note:
For Guard Rail placement See Sheet 47.
For Signing Quantities See Sheets 35, 43, & 90.



SCALE IN FEET