

File Name: F:\33\0007\0296\STRUCT\02960210
 Drawn By/Date: SC / 04-11-96 (15:0)

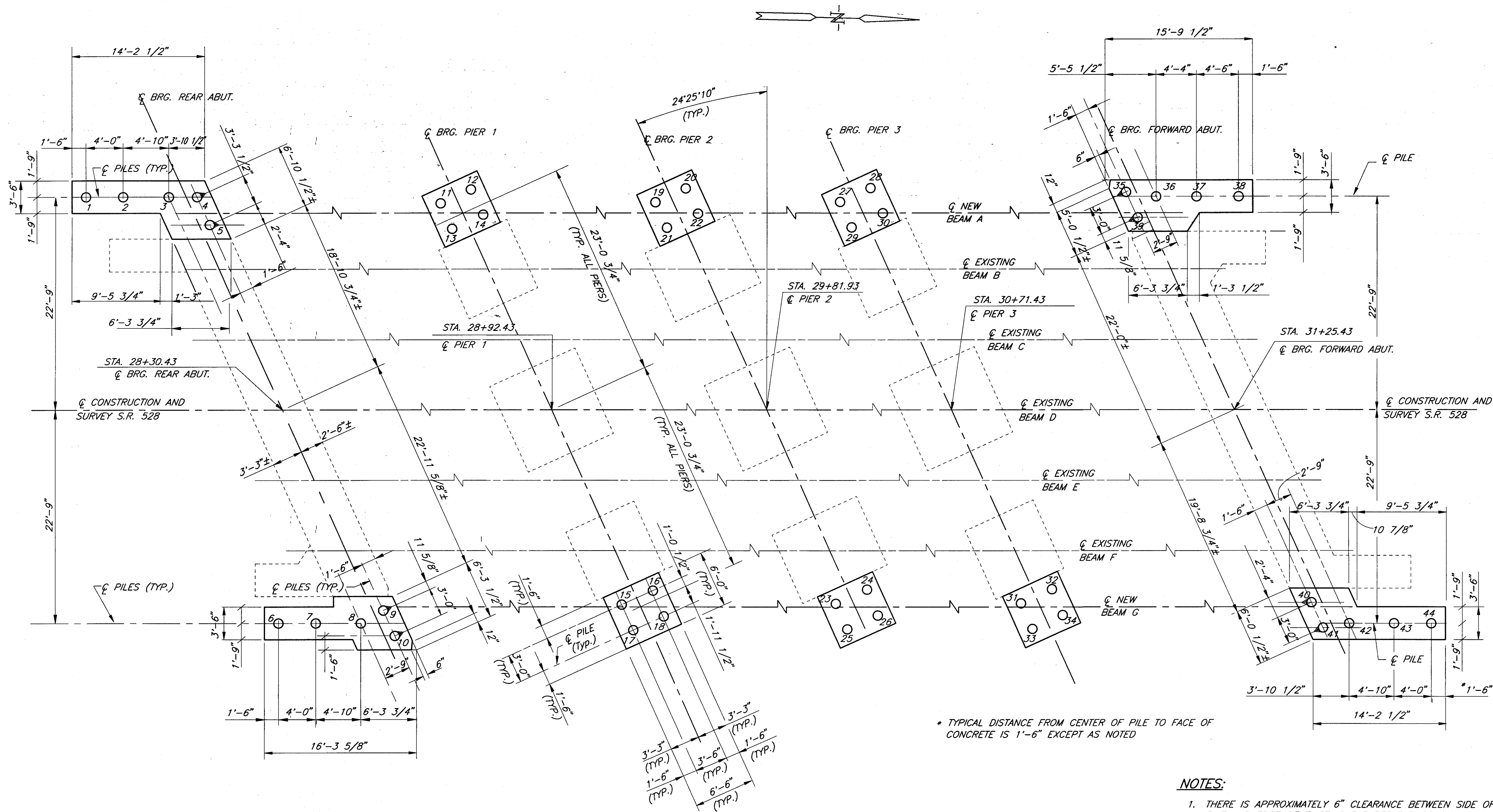

* TYPICAL DISTANCE FROM CENTER OF PILE TO FACE OF CONCRETE IS 1'-6" EXCEPT AS NOTED

NOTES:

1. THERE IS APPROXIMATELY 6" CLEARANCE BETWEEN SIDE OF PILE AND EDGE OF EXISTING PARAPET FOR CONSIDERATION OF FOUNDATION WORK PRIOR TO REMOVAL OF THE EXISTING DECK.
2. PILE LAYOUT DIMENSIONS ARE MEASURED ALONG BOTTOM OF FOOTING.

LEGEND

- 7 ⊙ BATTERED PILE 4:1 W/ PILE NUMBER
- 42 ⊙ VERTICAL PILE W/ PILE NUMBER

DESIGN AGENCY
 THE OSBORN ENGINEERING COMPANY
 668 EUCLID AVENUE
 CLEVELAND, OHIO 44114

DATE	10/95
REVIEWED	CA
DRAWN	VM
DESIGNED	BK
CHECKED	JRS
STRUCTURE FILE NUMBER	4305019

FOUNDATION LAYOUT PLAN
 BRIDGE NO. LAK-90-2687
 OVER INTERSTATE 1-90

LAK-90-26.87

10 / 24

40
54