

LAKE COUNTY
LAK-1-26.51
ASHTABULA COUNTY
ATB-1-0.00

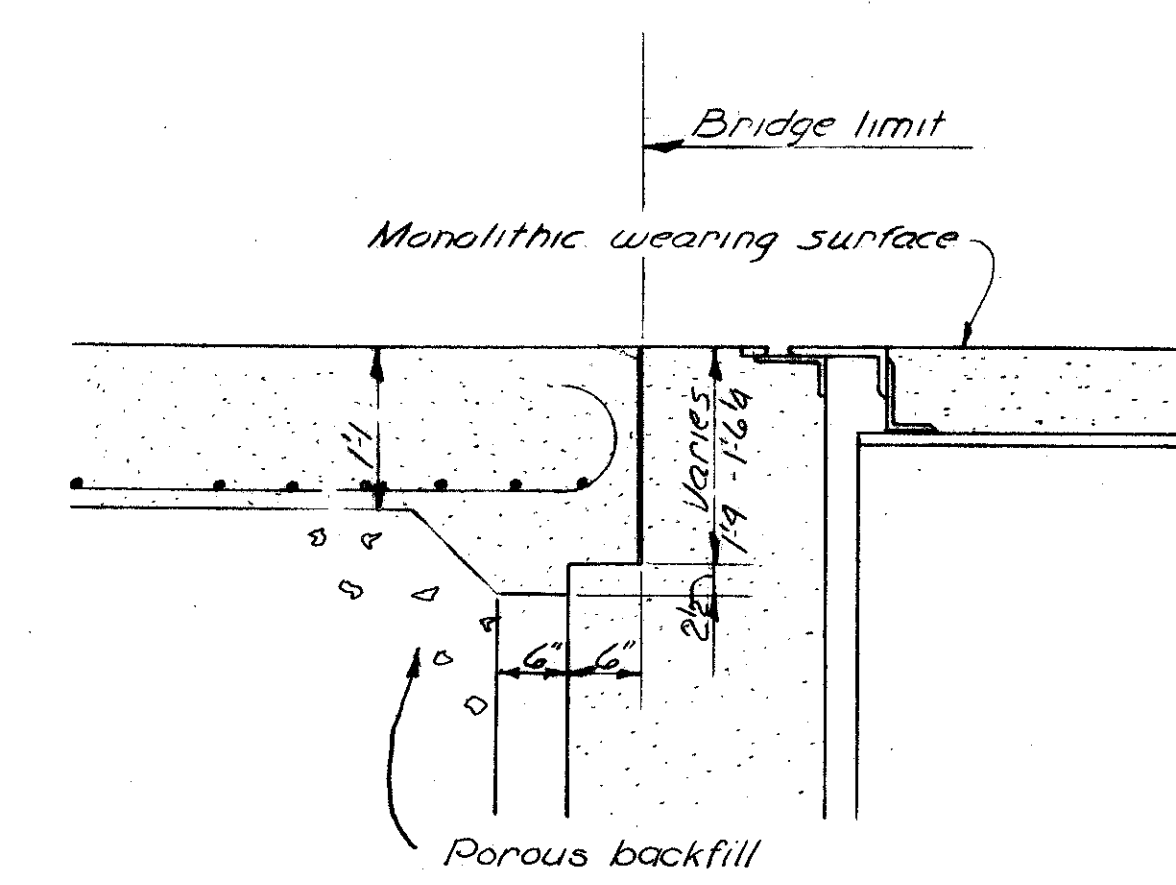
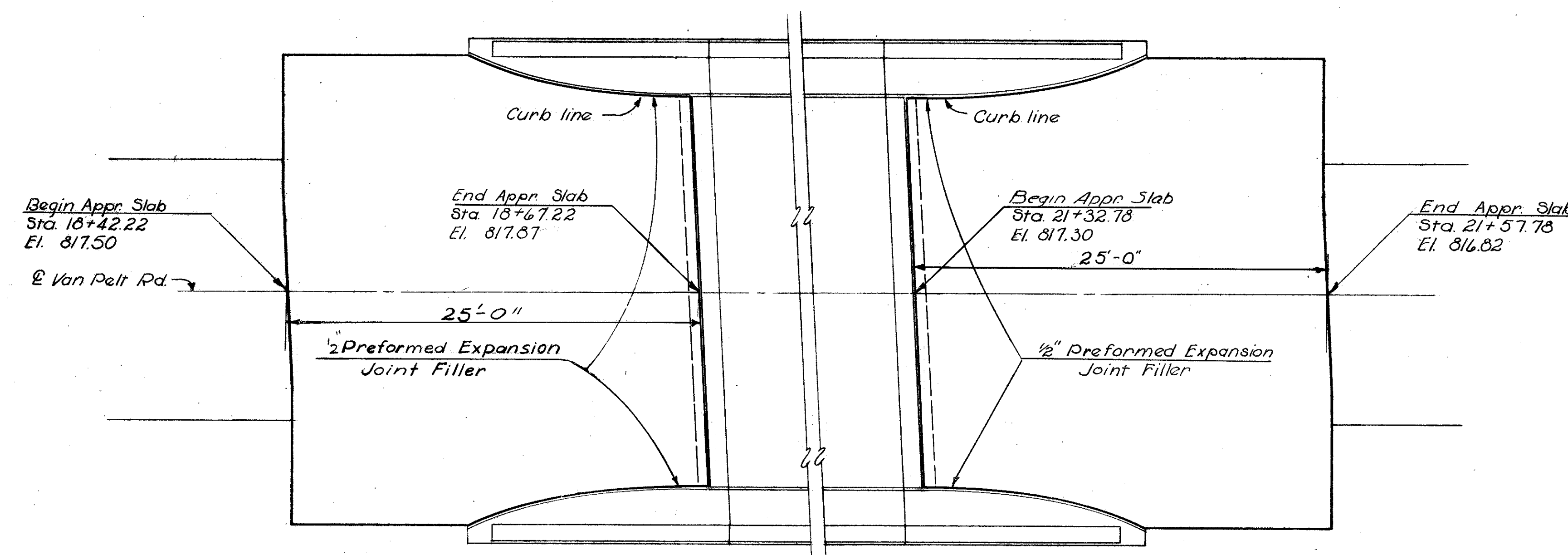

REINFORCING STEEL LIST				BOTH APPROACH SLABS	
Mark	Length	Shape	No.	Wt.	
AS 501	23'-7"	Str.	12	295	
AS 502	23'-9"	"	2	50	
AS 503	25'-11"	"	2	50	
AS 504	24'-3"	"	2	51	
AS 505	24'-7"	"	2	51	
AS 506	25'-1"	"	2	52	
AS 507	25'-7"	"	2	53	
AS 508	26'-1"	"	2	54	
AS 509	26'-9"	"	2	56	
AS 510	27'-5"	"	2	57	
AS 511	28'-4"	"	2	59	
AS 512	28'-4"	"	22	650	
AS 513	8'-0"	"	2	17	
AS 514	28'-4"	Bent	2	59	
AS 801	11'-9"	Str.	2	63	
AS 802	12'-8"	"	2	68	AS 808 - AS 811
AS 803	13'-8"	"	2	73	AS 819 - AS 822
AS 804	14'-10"	"	2	79	AS 823
AS 805	16'-2"	"	2	86	AS 824
AS 806	17'-6"	"	2	93	AS 825
AS 807	19'-11"	"	2	106	AS 826
AS 808 - AS 811	25'-3"	Bent	8	539	AS 827
AS 812	19'-10"	Str.	2	106	AS 828
AS 813	18'-3"	"	2	97	AS 829
AS 814	16'-11"	"	2	90	AS 830
AS 815	15'-6"	"	2	83	AS 831
AS 816	14'-6"	"	2	77	AS 832
AS 817	13'-6"	"	2	72	AS 833
AS 818	12'-6"	"	2	67	AS 834
AS 819 - AS 822	25'-10"	Bent	8	552	AS 835
AS 823	25'-4"	"	2	135	AS 836
AS 824	25'-5"	"	2	136	AS 837
AS 825	25'-5"	"	2	136	AS 838
AS 826	25'-5"	"	2	136	AS 839
AS 827	25'-6"	"	2	136	AS 840
AS 828	25'-6"	"	2	136	AS 841
AS 829	25'-6"	"	2	136	
AS 830	25'-7"	"	2	137	
AS 831	25'-7"	"	2	137	
AS 832	25'-7"	"	2	137	
AS 833	25'-7"	"	2	137	
AS 834	25'-8"	"	2	137	
AS 835	25'-8"	"	2	137	
AS 836	25'-8"	"	2	137	
AS 837	25'-9"	"	2	138	
AS 838	25'-9"	"	2	138	
AS 839	25'-9"	"	2	138	
AS 840	25'-10"	"	2	138	
AS 841	25'-7"	"	48	3279	
Total				9546	

Note: $\frac{1}{2}$ " Preformed expansion joint filler included in Item I-7 for payment.

Notes: Approach Slabs to be class "C" Concrete. In the reinforcing steel bar marks, the numeral following the second letter is the Bar Number which indicates the size of the bar.

* Note: This reinforcing steel is included in the item "Reinforced Concrete Approach Slab Item I-7" and is not paid for separately.

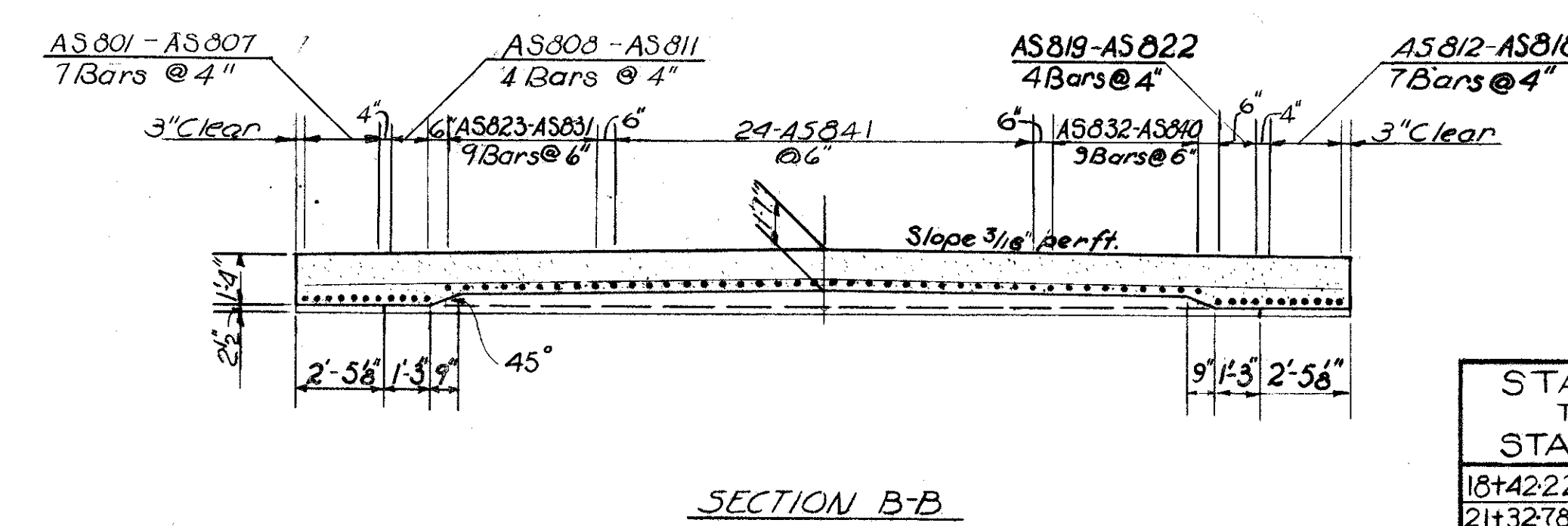
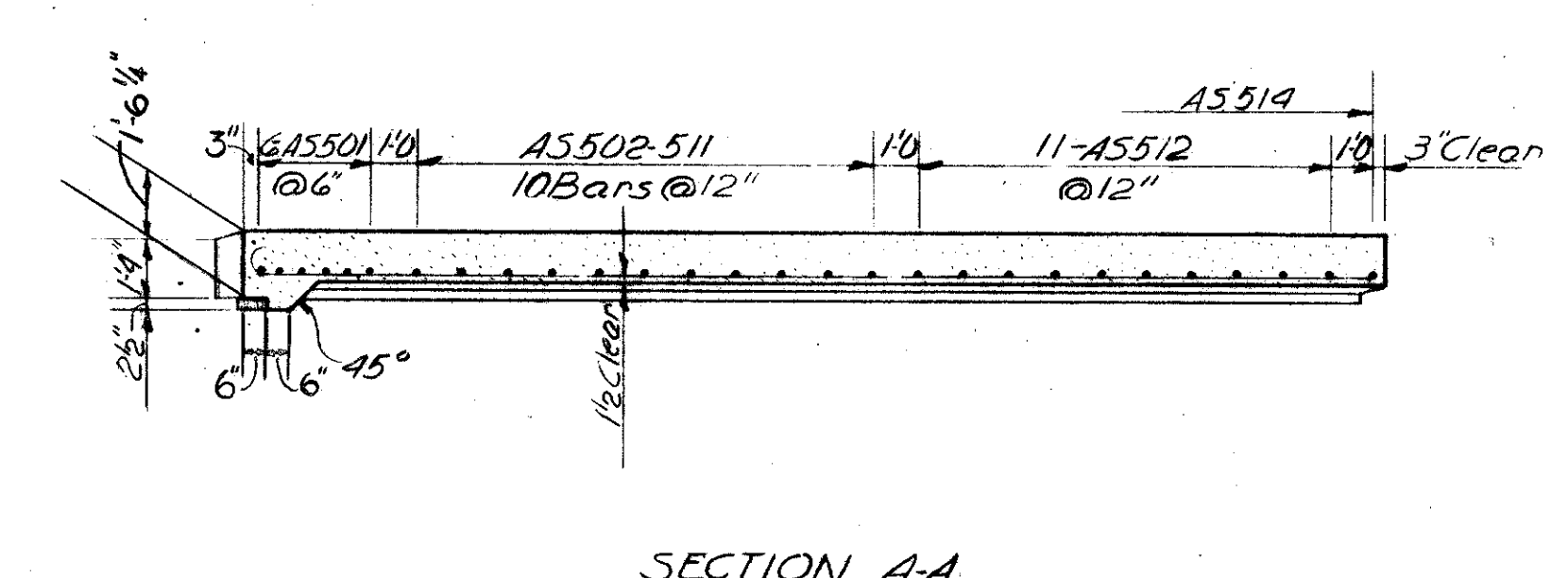
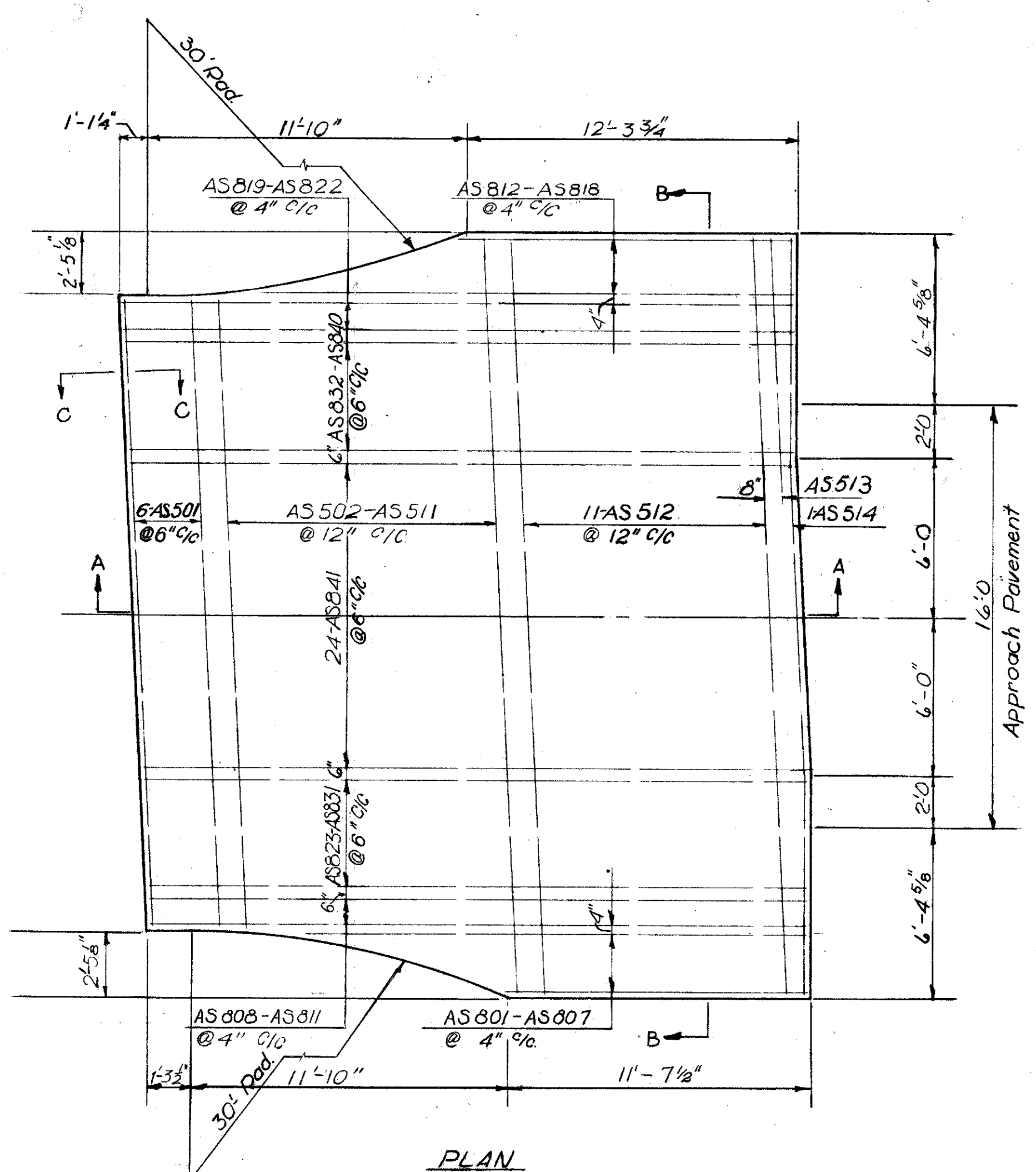

STATION TO STATION	REINFORCED CONCRETE APPROACH SLABS ITEM I-7
18+42.22 to 18+67.22	76 Sq. yd.
21+32.78 to 21+57.78	76 Sq. yd.
TOTAL	152 Sq. yd.

CHARLES L. BARBER AND ASSOCIATES
HARRY BALKE ENGINEERS
TOLEDO, OHIO

APPROACH SLAB DETAILS

BRIDGE NO. ATB-1-0138
SRI UNDER VANPELT RD.
ASHTABULA CO. SRI
STA. 73+04.80

DESIGNED	DRAWN	TRACED	CHECKED	REVIEWED	DATE	REVISED
R.T.S.	M.S.		J.P.R.	ACA	8/28/57	