

FED. DIST.	STATE	FED. AID PROJECT	FISCAL YEAR	145
2	OHIO	I-1103(15)		176

LAKE COUNTY  
LAK-1-26.51  
ASHTABULA COUNTY  
ATB-1-0.00

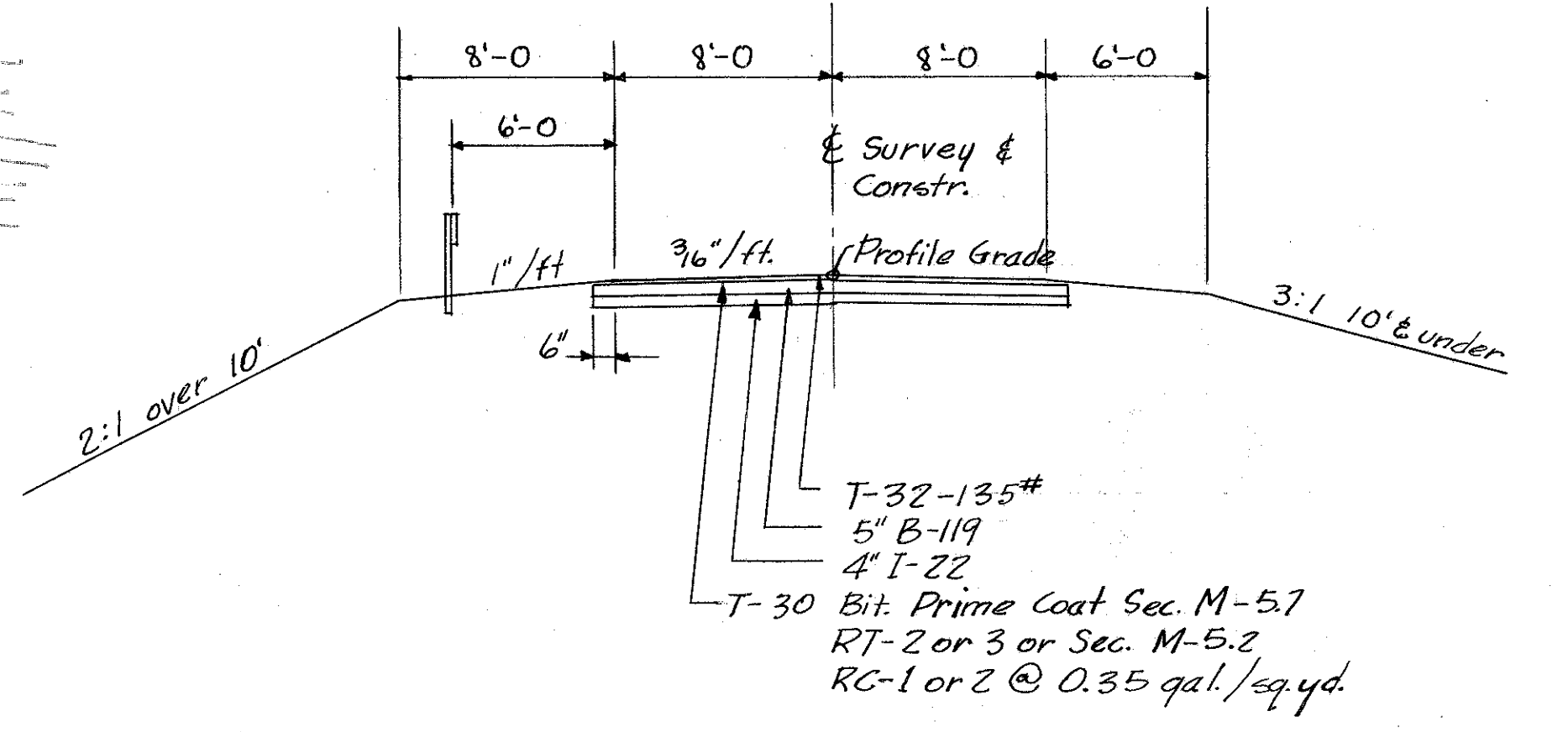
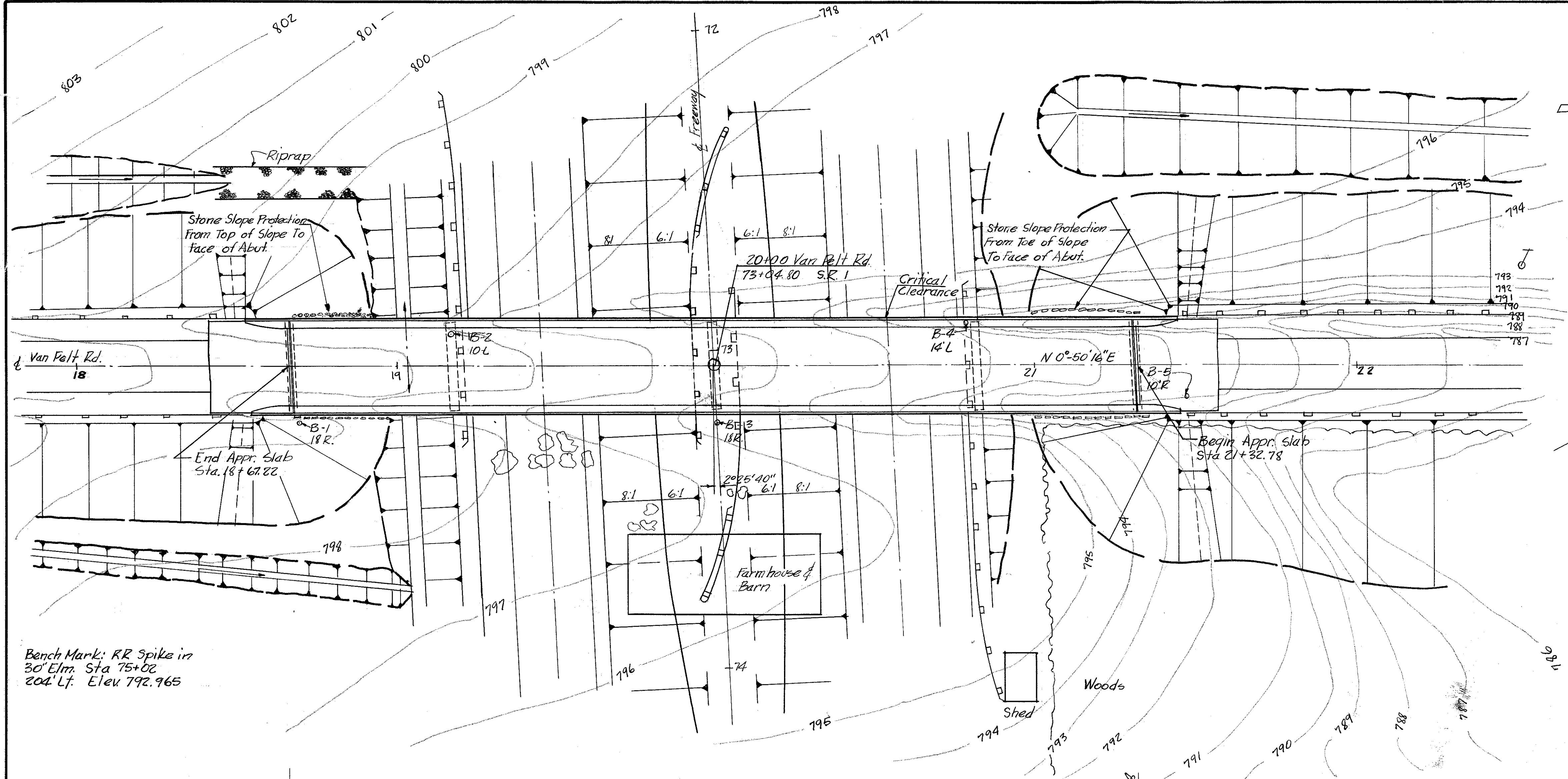

TYPICAL SECTION THRU APPROACH PAVEMENT

Bench Mark: RR Spike in  
30' Elm. Sta 75+02  
204' Lt. Elev 792.965

PLAN

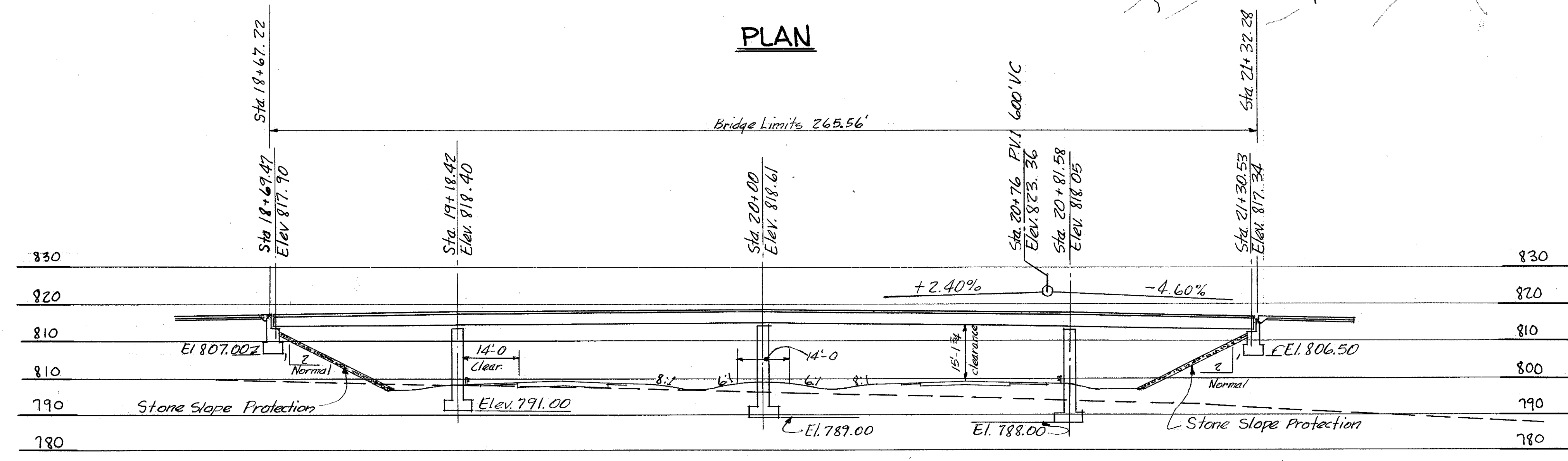

SECTION ALONG C

PROPOSED STRUCTURE	
Type:	Continuous Steel Beam with Reinforced Concrete Deck and Substructure.
Span:	48'-11 3/4", 81'-7", 81'-7", 48'-11 3/4" % Brq.
Roadway:	24'-0" 1/2 Safety Curbs
Load Frequency:	C.F. = 30 (51)
Skew:	2° 25' 40" R.F.
Wearing Surface:	2" Monolithic Conc.
Approach Slabs:	25'-0" Long
Alignment:	Tangent
Safety curb:	2'-0" each side

NOTES  
Foundation Soundings - Foundation design and foundation quantities are based on a study of soil sampling soundings made of the site. This sounding information may be inspected at the Interstate Projects Office in Columbus or in the Division office, but the State assumes no responsibility for the accuracy thereof.

1965 TRAFFIC 60VPD with under 30 combination trucks

CHARLES L. BARBER AND ASSOCIATES  
HARRY BALKE ENGINEERS  
TOLEDO, OHIO

**SITE PLAN**  
BRIDGE No. ATB-1-0138  
SRI UNDER VAN PELT RD.  
ASHTABULA CO. SK1  
STA: 73+04.80

SCALE: 1" = 20'-0"

PRESENT TOPOGRAPHY		PROPOSED WORK			
SURVEYED	DRAWN	DESIGNED	DRAWN	CHECKED	REVIEWED
VAL	DAP	RGE	DKM	JJB	ACA