

FED. RD. DIVISION	STATE	PROJECT
2	OHIO	I-1103(15)

122
176

LAKE COUNTY
LAK - 1-26.51
ASHTABULA COUNTY
ATB - 1-0.00

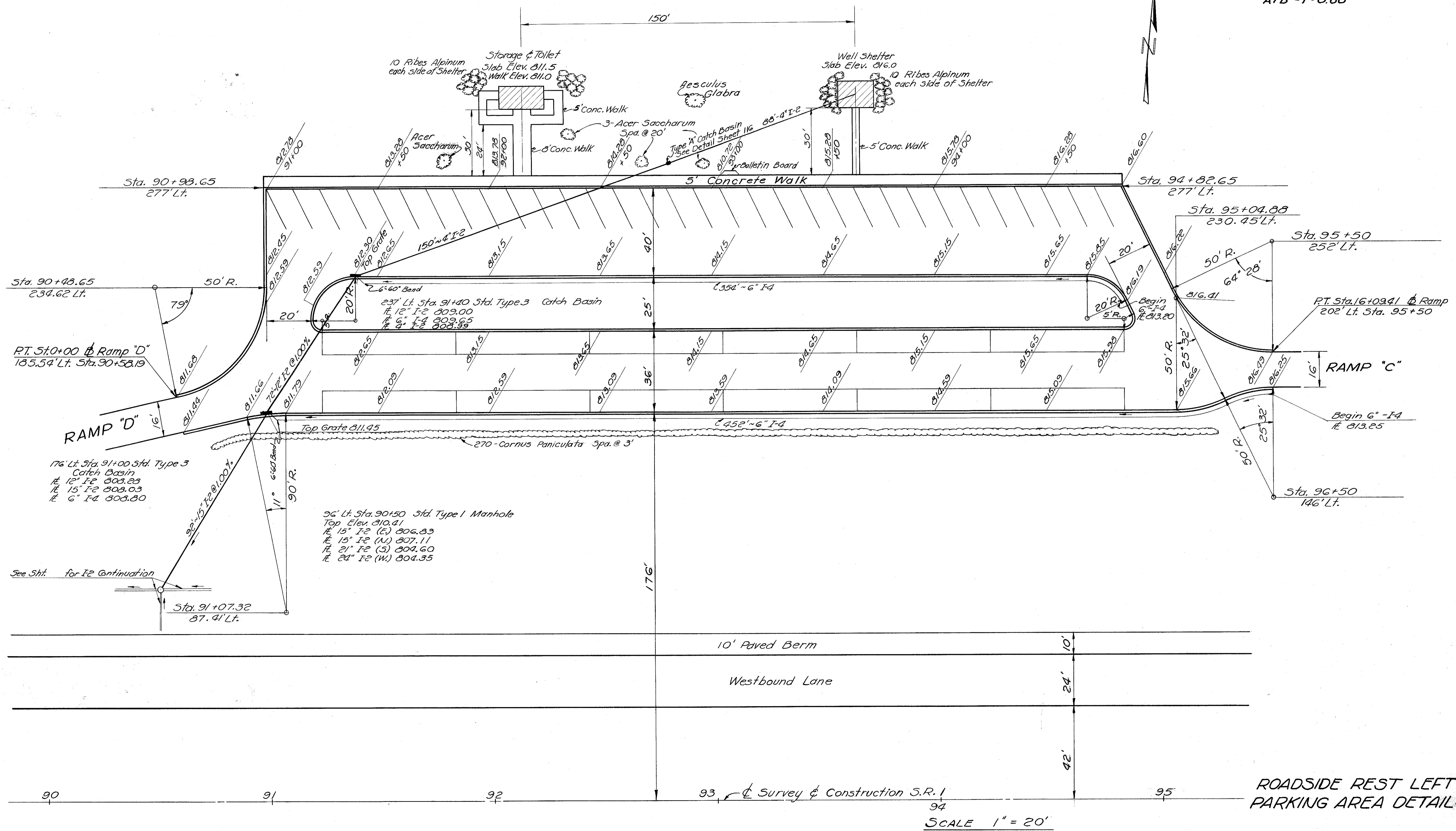

ROADSIDE REST LEFT
PARKING AREA DETAILS

ROADSIDE REST LAKE COUNTY