

FED. RD. DIVISION	STATE	PROJECT
2	OHIO	I-1103(15)

118  
176

LAKE COUNTY  
LAK - 1-26.51  
ASHTABULA COUNTY  
ATB - 1-0.00

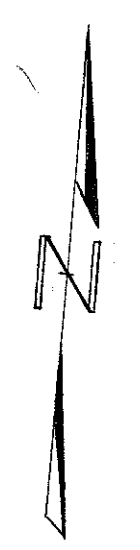

Note: Existing trees as indicated are to be saved.

Note: For Entrance Terminal Detail See Detail Sheet No. 124

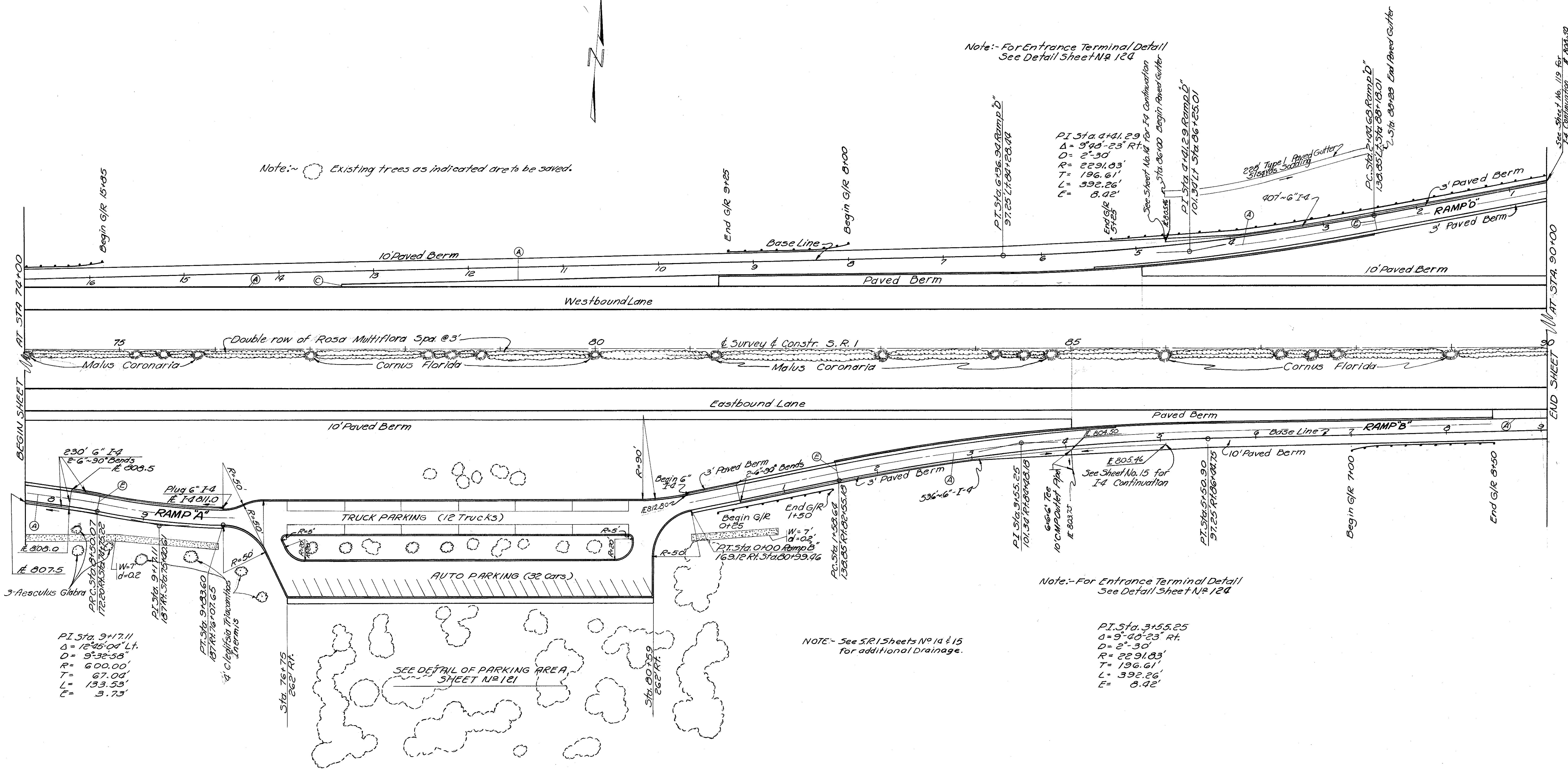

PI Sta. 9+17.11  
Δ = 12°45'04" Lt.  
D = 9°32'58"  
R = 600.00'  
T = 67.00'  
L = 133.53'  
E = 3.75'

PI Sta. 3+55.25  
Δ = 9°40'23" Rt.  
D = 2°-30'  
R = 2291.83'  
T = 196.61'  
L = 392.26'  
E = 8.42'

NOTE - See S.R. Sheets No. 14 & 15 for additional Drainage.

Note: For Entrance Terminal Detail See Detail Sheet No. 124

ROADSIDE REST PLAN