

ESTIMATED QUANTITIES

Item	Description	Quantity	Unit
E-2	Excavation for Structures	224	Cu. Yds.
E-3	Channel Excavation	34	Cu. Yds.
I-10	Dumped Rock Channel Protection	33	Cu. Yds.
I-10	Riprap Type "A" (as per Plan)	41	Sq. Yds.
S-1	Concrete for Structures, Class "C"	30.0	Cu. Yds.
S-4	Reinforcing Steel	1198	Lbs.
S-27	42" Pipe for Roadway Culverts Sec. M-6.6(b)	206	Lin. Ft.
L-10	Sodding	47	Sq. Yds.

FED. RD. DIVISION	STATE	PROJECT
2	OHIO	I-1103 (15)

99  
176

LAKE COUNTY  
LAK - 1-26.51  
ASHTABULA COUNTY  
ATB - 1-0.00

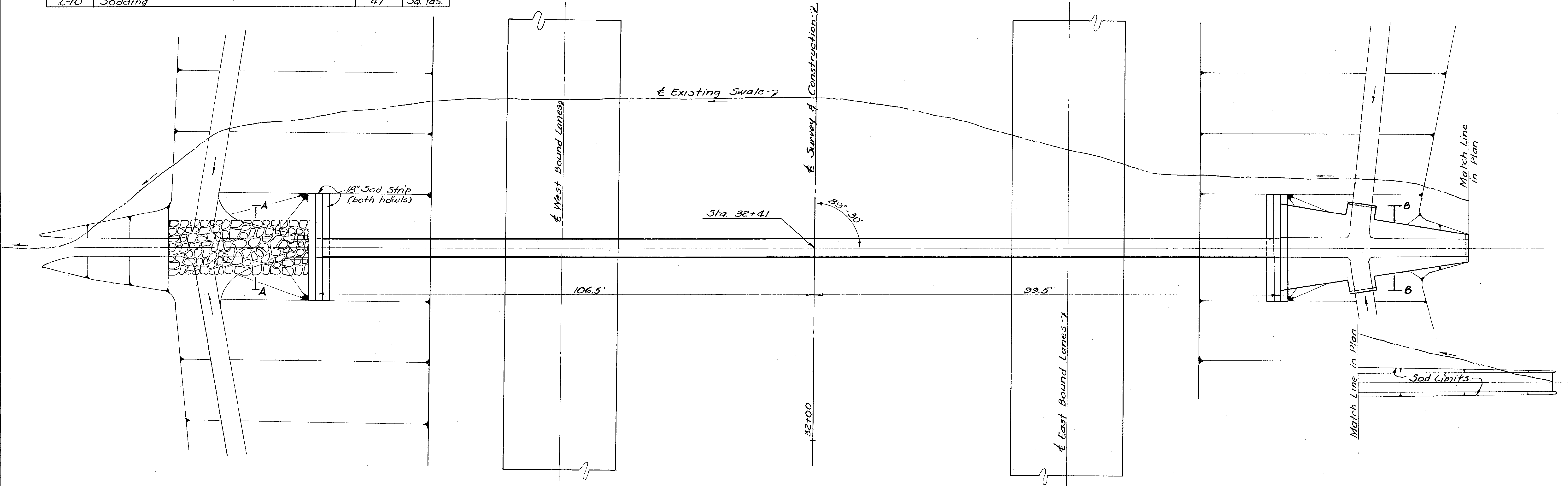
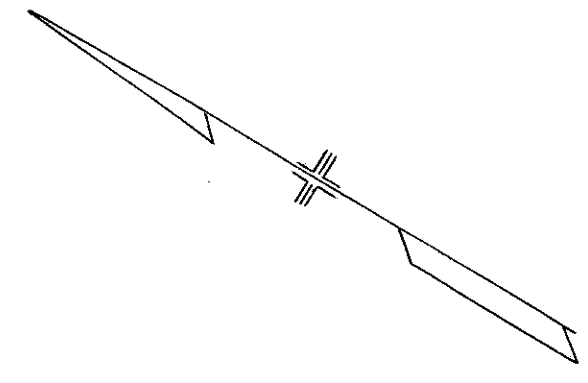

Scale 1" = 10'

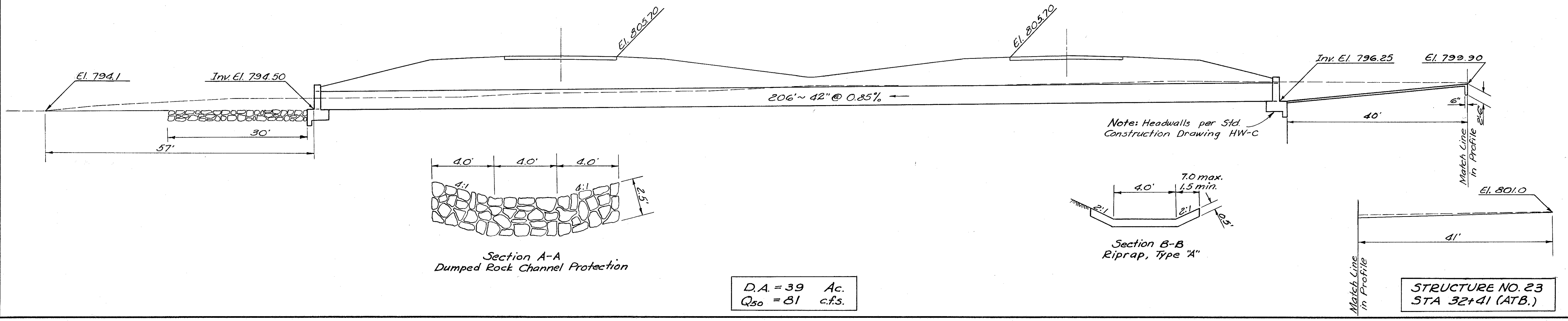

D.A. = 39 Ac.  
Q<sub>50</sub> = 81 cfs.

STRUCTURE NO. 23  
STA 32+41 (ATB.)

Revised 10/2/57