

LAKE COUNTY  
LAK-1-26.51  
ASHTABULA COUNTY  
ATB-1-0.00

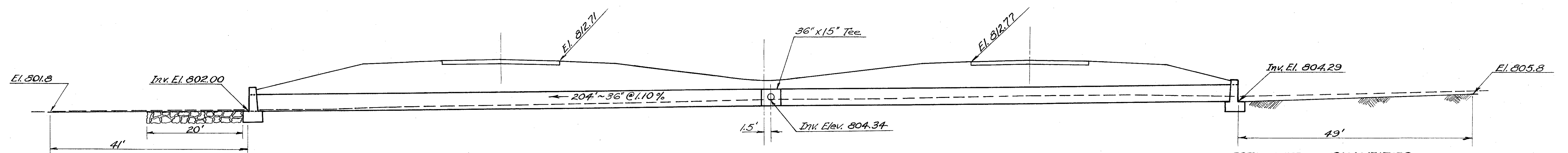
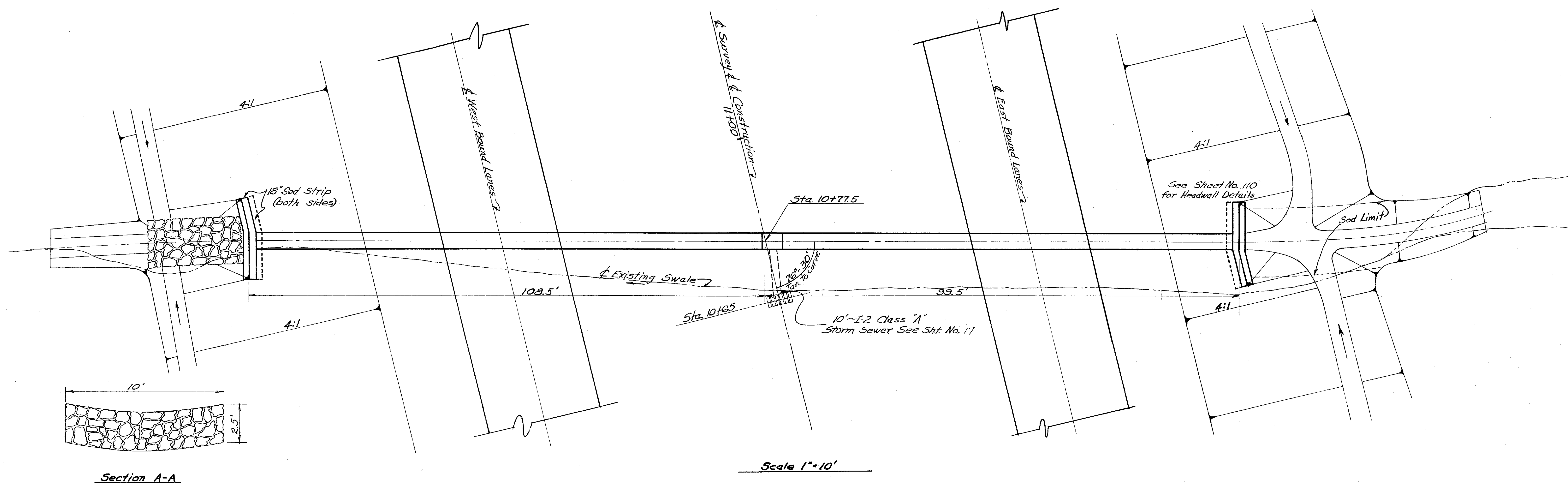

ESTIMATED QUANTITIES

| Item | Description  | Quantity | Unit     |
|------|--|----------|----------|
| E-2  | Excavation for Structures                            | 90       | Cu. Yd.  |
| E-3  | Channel Excavation                                   | 35       | Cu. Yd.  |
| I-10 | Dumped Rock Channel Protection                       | 18.5     | Cu. Yd.  |
| S-1  | Concrete for Structures, Class "C"                   | 21.0     | Cu. Yd.  |
| S-4  | Reinforcing Steel                                    | 986      | Lbs.     |
| S-27 | 36" Pipe for Roadway Culverts Sec. M-6.6(b) M-6.8(b) | 204      | LIn. Ft. |
| L-10 | Sodding  | 89       | Sq. Yd.  |
| I-5  | Pipe Specials, 36" x 15" Tee                         | 1        | Each     |

D.A. = 31 Ac.  
Q<sub>50</sub> = 64 cfs.

STRUCTURE NO. 21  
Sta. 10+77.5 (ATB)