

FED. NO. DIVISION	STATE	PROJECT
2	OHIO	I-1103(15)

89
176

LAKE COUNTY
LAK-1-26.51
ASHTABULA COUNTY
ATB-1-0.00

ESTIMATED QUANTITIES

Item	Description	Quantity	Unit
E-2	Excavation for Structures	165	Cu. Yds.
E-3	Channel Excavation	26	Cu. Yds.
I-10	Dumped Rock Channel Protection	22.2	Cu. Yds.
L-10	Sodding	60	Sq. Yds.
S-1	Concrete for Structures Class "C"	26.0	Cu. Yds.
S-4	Reinforcing Steel	1144	Lbs.
S-27	48" Pipe for Roadway Culverts	272	Lin. Ft.

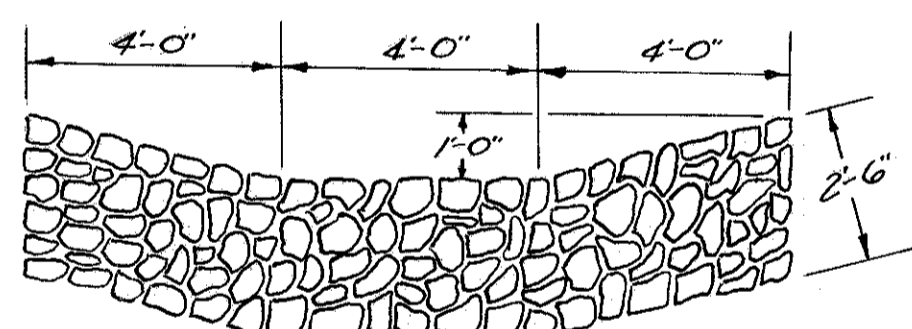
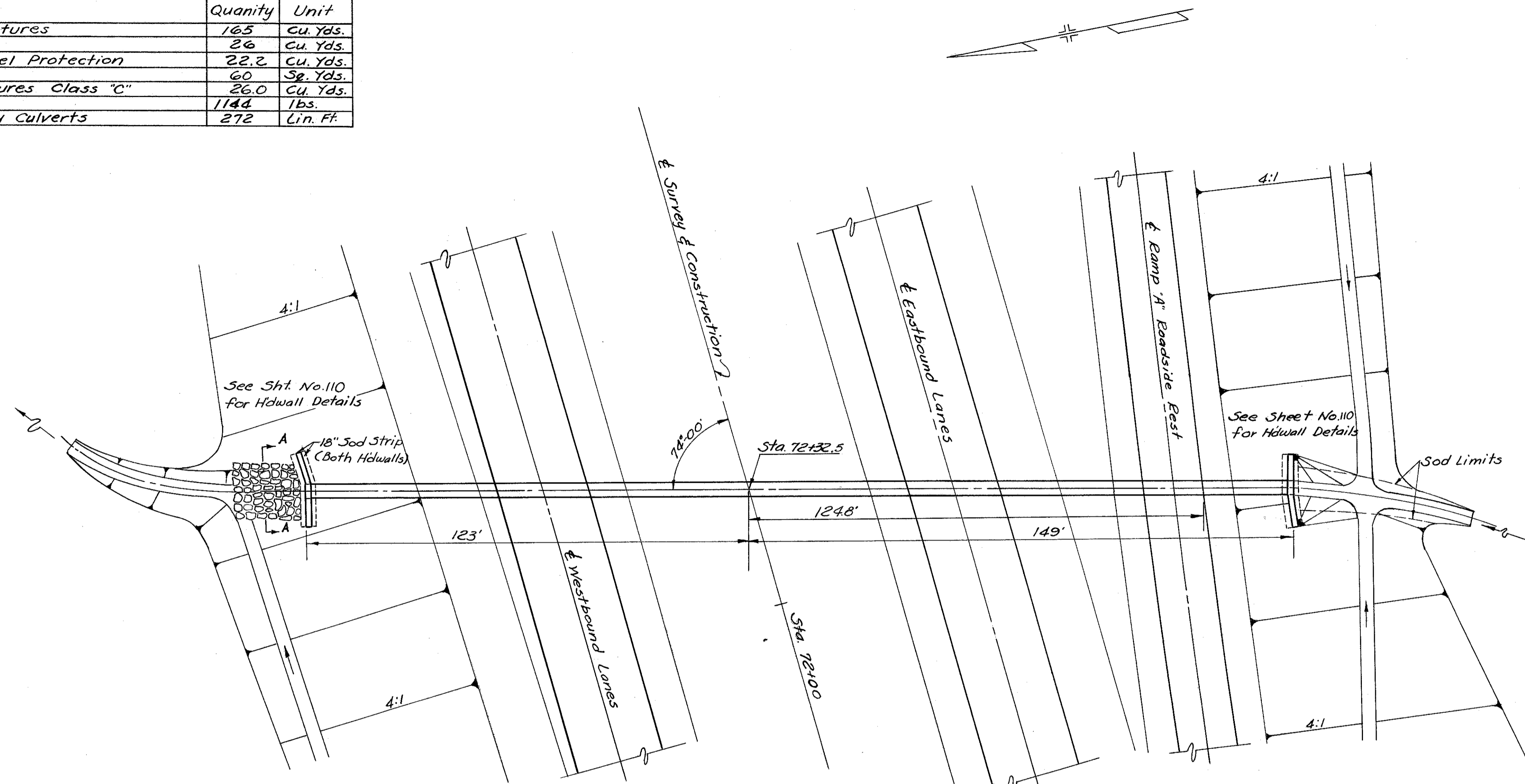

Section A-A
DUMPED ROCK CHANNEL PROTECTION

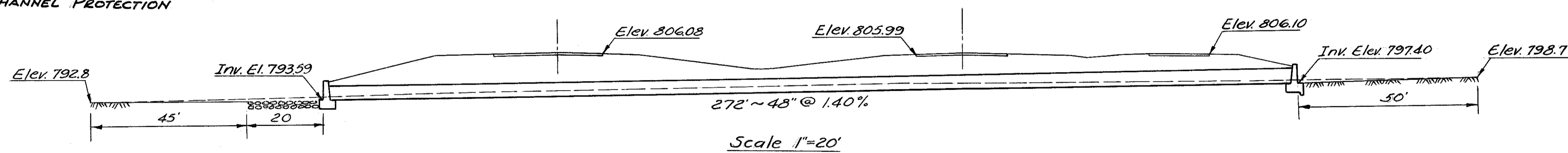

D.A. = 43 Ac.
Q₅₀ = 90 c.f.s.

STRUCTURE No. 12
Station 72+32.5