

LAKE COUNTY
LAK-1-26.51
ASHTABULA COUNTY
ATB-1-0.00

ESTIMATED QUANTITIES

Item	Description	Quantity	Unit
E-2	Excavation for Structures	89	Cu.Yd.
E-3	Channel Excavation	27	Cu.Yd.
I-10	Dumped Rock Channel Protection	22.2	Cu.Yd.
S-1	Concrete for Structures, Class "C"	14.2	Cu.Yd.
S-4	Reinforcing Steel	690	Lbs.
S-27	36" Pipe for Roadway Culverts Sec M-6.6(b) M6.8(b)	204	Lin. Ft.
L-10	Sodding	67	Sq.Yd's

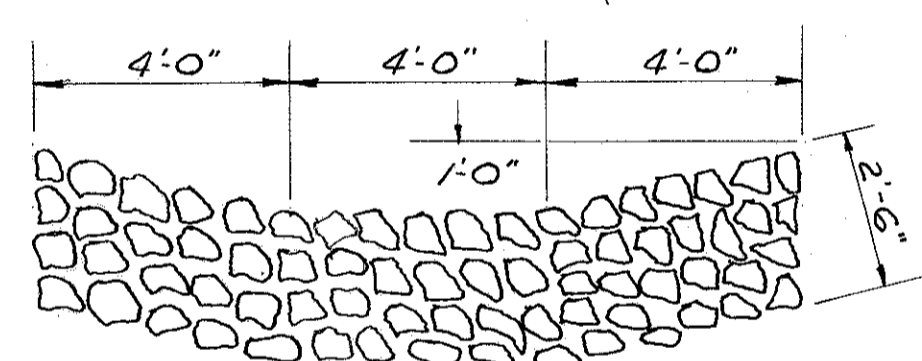
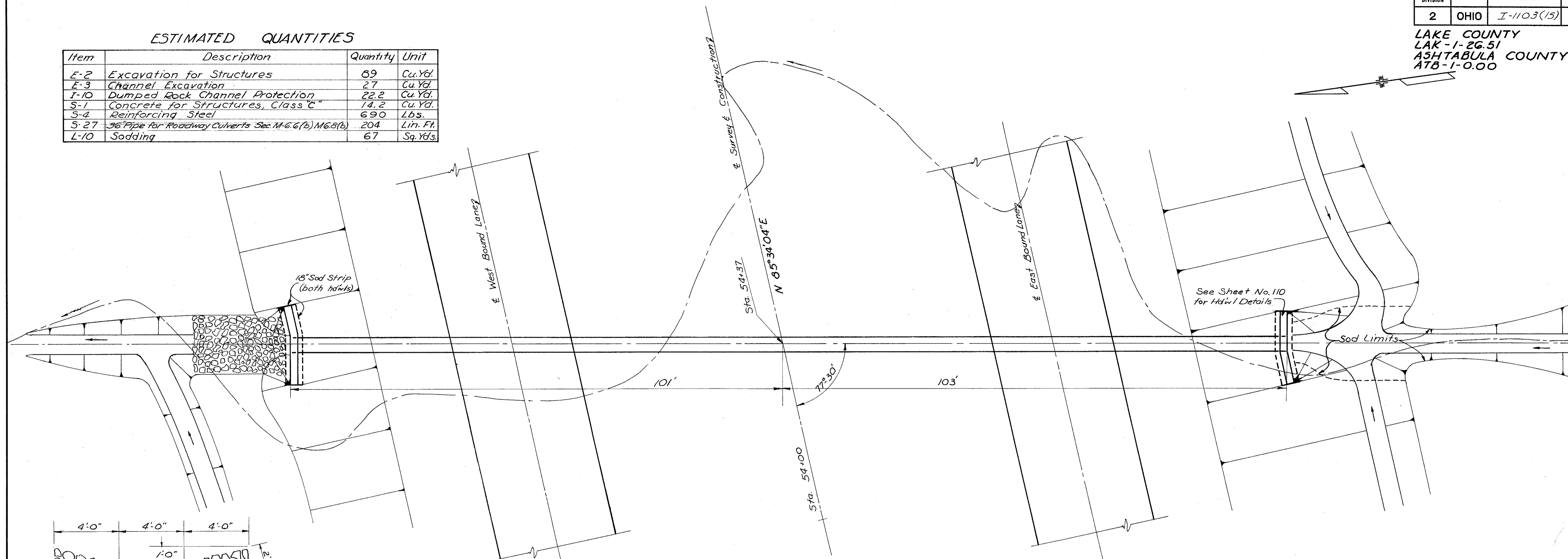

Section A-A
DUMPED ROCK CHANNEL
PROTECTION

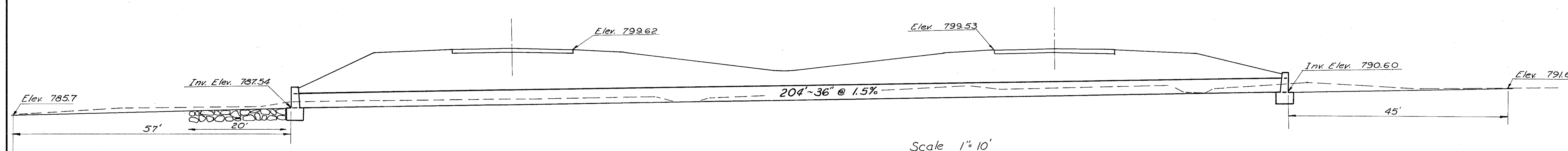

Scale 1" = 10'

D.A. = 41 Ac.
Q₅₀ = 63 cfs.

STRUCTURE No. 10
Station 54+37 (LAKE)