

FED. RD. DIVISION	STATE	PROJECT	
2	OHIO	I-1103 (15)	

85
176

LAKE COUNTY
LAK-1-26.51
ASHTABULA COUNTY
ATB-1-0.00

ESTIMATED QUANTITIES

Item	Description	Quantity	Unit
E-2	Excavation for Structures	175	Cu. Yd.
E-3	Channel Excavation	55	Cu. Yd.
I-10	Dumped Rock Channel Protection	23	Cu. Yd.
I-10	Riprap Type "A"	32	Sq. Yd.
S-1	Concrete for Structures, Class "C"	20.4	Cu. Yd.
S-4	Reinforcing Steel	73.8	Lbs.
S-27	53" x 34" Reinforced Elliptical Concrete Culvert Pipe, Sec. M-206.6(b).	200	Lin. Ft.
L-10	Sodding	34	Sq. Yd.

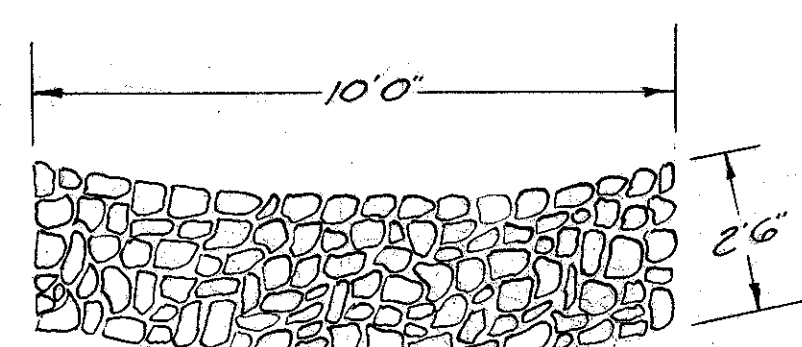
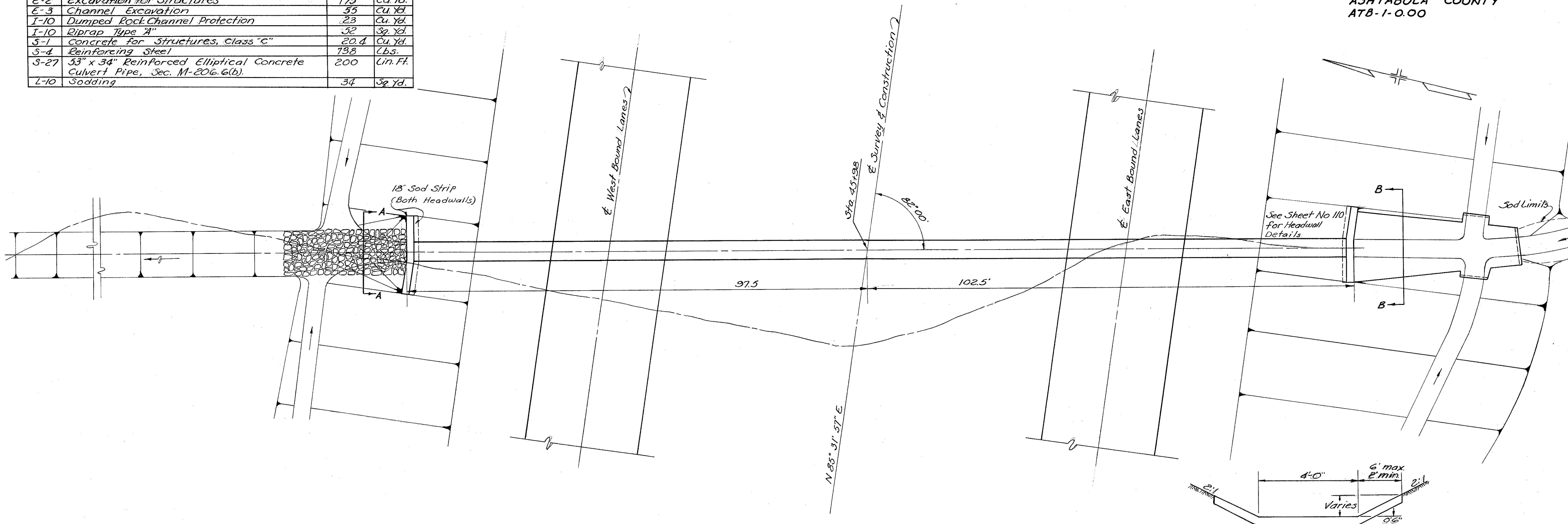

SECTION A-A
DUMPED ROCK CHANNEL PROTECTION

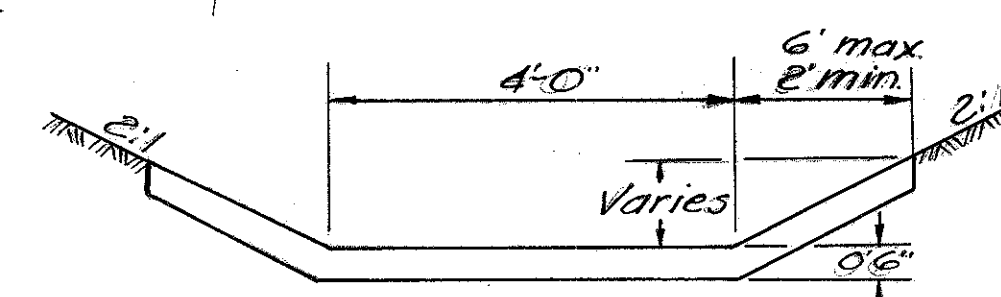

SECTION B-B
TYPE "A" RIPRAP

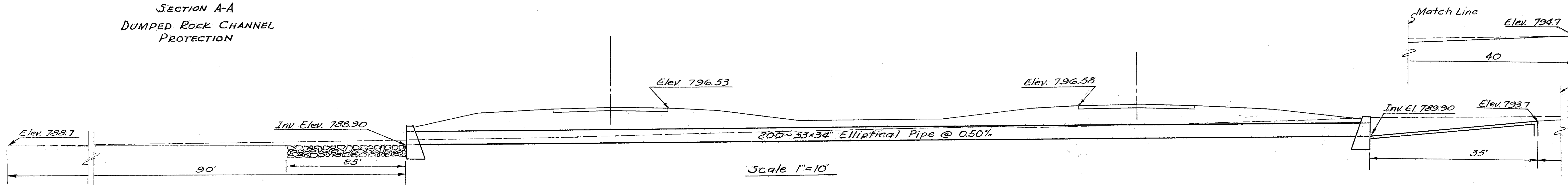

Scale 1"=10'

D.A. = 32 Ac.
Q₅₀ = 68 c.f.s.

STRUCTURE No. 7
Station 45+98 (LAK)