

FED. RD. DIVISION	STATE	PROJECT
2	OHIO	I-1103(15)

81
176

LAKE COUNTY
LAK-1-26.51
ASHTABULA COUNTY
ATB-1-0.00

ESTIMATED QUANTITIES

Item	Description	Quantity	Unit
E-2	Excavation for Structures	146	Cu. Yds.
E-3	Channel Excavation	28	Cu. Yds.
F-10	Dumped Rock Channel Protection	18.5	Cu. Yds.
S-1	Concrete for Structures Class "C"	19.8	Cu. Yds.
S-4	Reinforcing Steel	836	Lbs.
L-10	Sodding	87	Sq. Yds.
S-27	42" Extra Strength Reinforced Concrete Culvert Pipe Sec. M-6.6 (c) Or 12 Gage Paved Bit. Coated Corrugated Metal Pipe Sec. M-6.4 (d).	232	Lin. Ft.

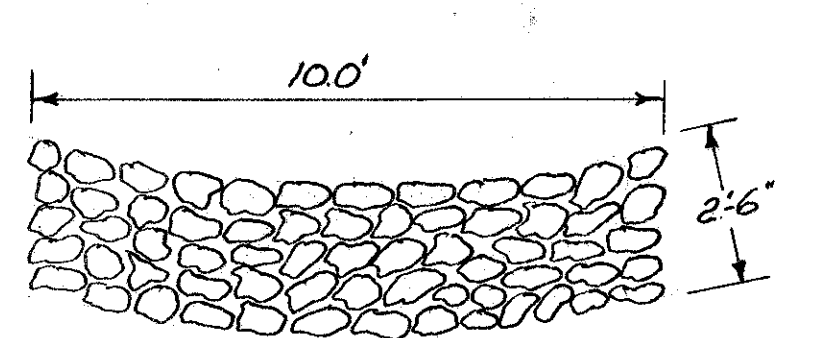
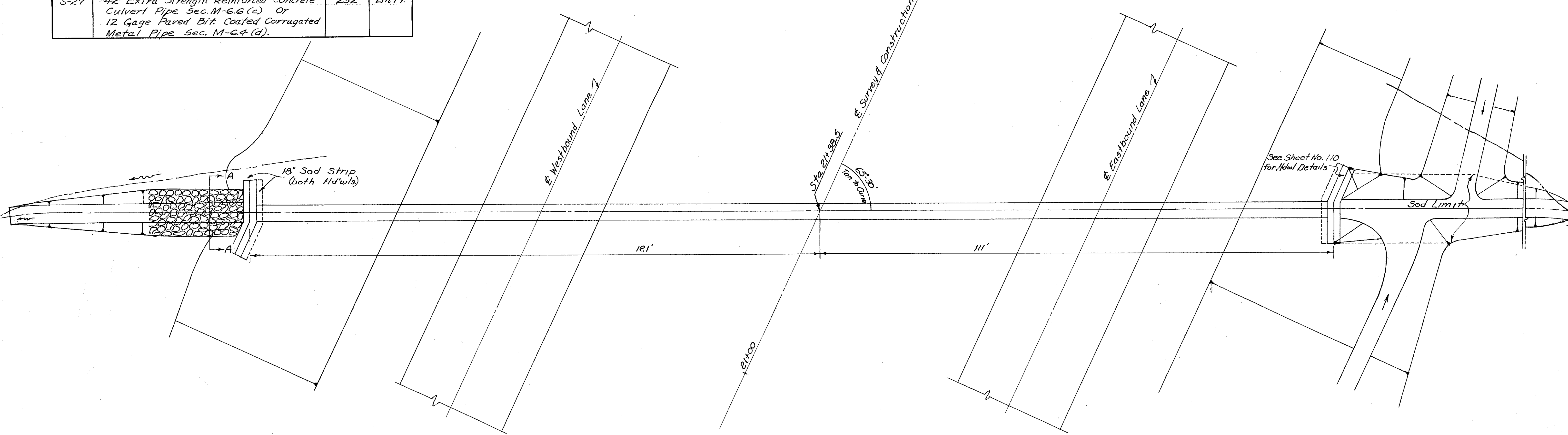
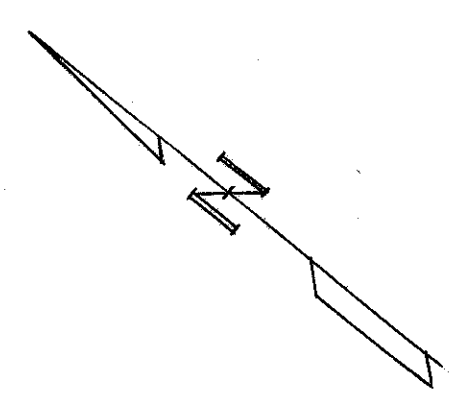

SECTION A-A
Dumped Rock Channel Protection

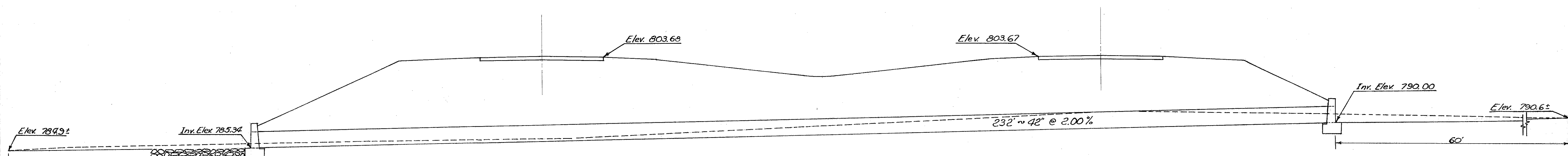

Scale 1"=10'

DA = 40 Ac.
Q₅₀ = 78 c.f.s.

STRUCTURE No. 3
Station 21+38.5 (LAKE)