

LAKE COUNTY
LAK - 1-26.51
ASHTABULA COUNTY
ATB-1-0.00

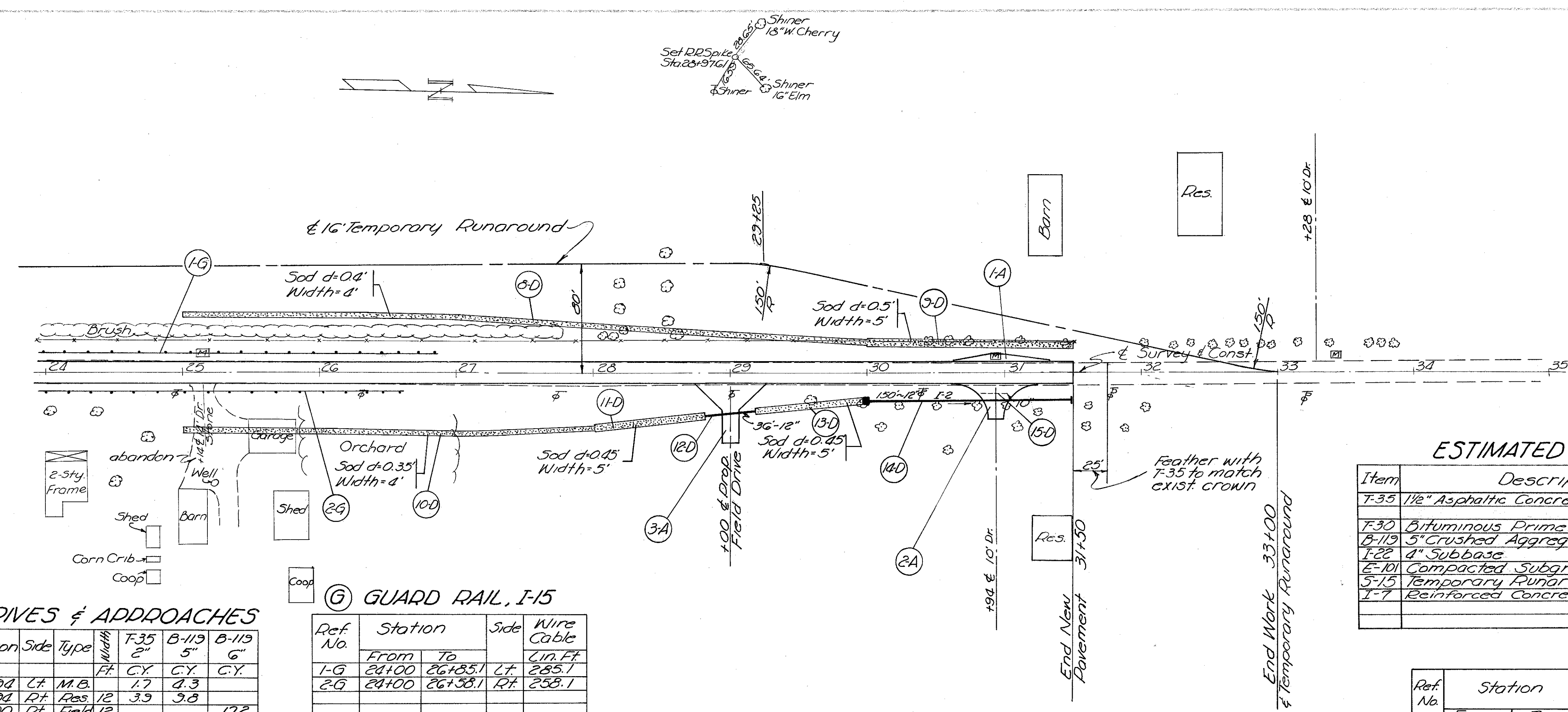

ESTIMATED QUANTITIES

Item	Description	Unit	Quantity
F-35	1 1/2" Asphaltic Concrete Surface Course	Cu.Yds	110.9
F-30	Bituminous Prime Coat	Gals.	332.1
B-119	5" Crushed Aggregate Base Course	Cu.Yds	333.9
I-22	4" Subbase	Cu.Yds	358.1
E-10	Compacted Subgrade	Sq.Yds	281.5
S-15	Temporary Runaround using Class "B" Pav't.	Lump	Lump
I-7	Reinforced Concrete Approach Slabs	Sq.Yd.	152

(A) DRIVES & APPROACHES

Ref. No.	Station	Side	Type	Width		
				F-35 2'	B-119 5'	B-119 6'
1A	30+34	Lt.	M.B.	1.7	4.3	
2A	30+34	Rt.	Res.	3.9	3.8	
3A	25+00	Rt.	Field			17.2
Totals				5.6	18.1	17.2

(G) GUARD RAIL, I-15

Ref. No.	Station		Side	Wire Cable
	From	To		
1-G	24+00	26+85.1	Lt.	285.1
2-G	24+00	26+58.1	Rt.	258.1
Total				543.2

(D) DRAINAGE

Ref. No.	Station		Side	E-12 Pipe Removed Lin. Ft.	I-2 12" Class 4 Storm Sewer Lin. Ft.	I-3 6" Polym Drainage Lin. Ft.	I-5 Std #22A Catch Basin for Endwalls Each	S-1 4" E' Conc. for Endwalls Cu. Yds.	L-10 Sodding Sq. Yds.	F-1 12" Pipe for Driveways Lin. Ft.	See Sht. No.
	From	To									
1-D	15+00	19+70	Lt.								69
2-D	12+32	13+18	Rt.								69
3-D	14+25	15+25	Rt.			26			33		69
4-D	15+25	16+51	Rt.		126			0.46			69
5-D	15+63	15+73	Rt.	16							69
6-D	16+31	17+00	Rt.						16		69
7-D	17+00	19+30	Rt.						123		69
8-D	25+00	30+00	Lt.						222		70
9-D	30+00	31+50	Lt.						23		70
10-D	25+00	28+00	Rt.						133		70
11-D	28+00	28+82	Rt.						46		70
12-D	28+82	29+18	Rt.							36	70
13-D	29+18	30+00	Rt.						46		70
14-D	30+00	31+50	Rt.		150		1	0.23			70
15-D	30+83	31+03	Rt.	20							70
Totals				36	276	26	1	0.69	317	36	

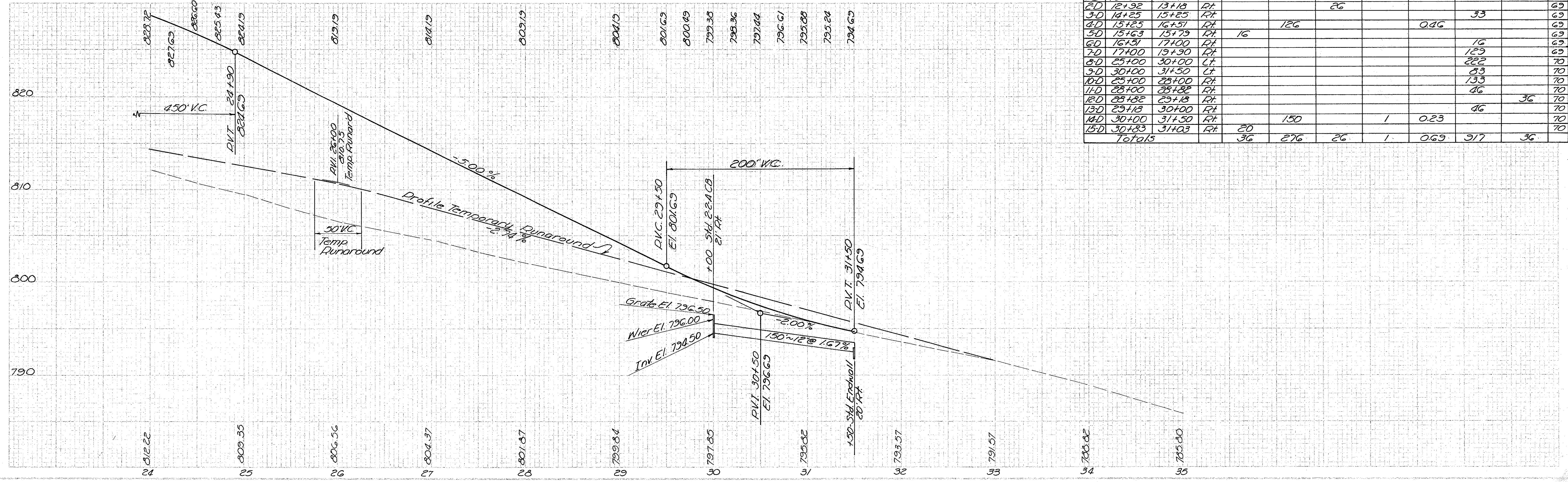

PLAN & PROFILE COUNTY LINE RD 24+00 - 35+00