

STRUCTURES 20' SPAN & UNDER

Str. No.	Station	Proposed Type	Size	Details on Sheet
35	123+82	Pipe	27" 200	108
36	124+77	Pipe	40" 210	108

For LeFever Rd Details & Proposed Structure
Data See Sheet Nos. 77-80

Note: Marker to be furnished & erected on the left by State of Ohio before acceptance of this Project.

END PROJECT
I-1103 (15)
STA. 132+00
S.L.M. 2.49

Typical Section of proposed future construction will be the same as that shown for this Project

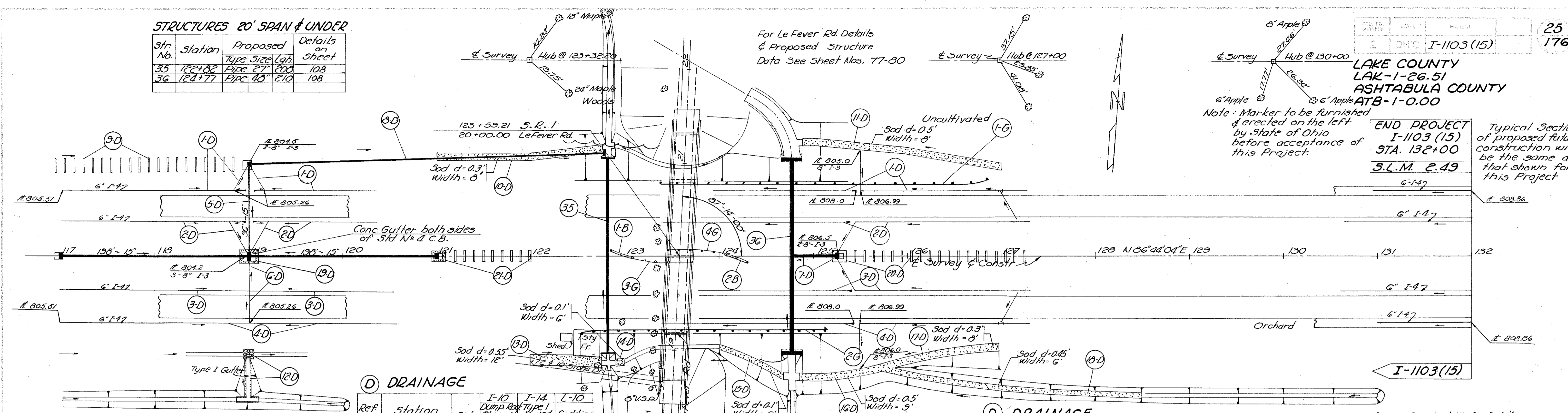

G GUARD RAIL I-15

Ref No.	Station	Side	Steel Beam Type (Depth)	Lin. Ft.
1-G	123+39	Lt.	350-D	350.0
2-G	123+50	Rt.	262.5	262.5
3-G	123+10.7	Med.	62.5	62.5
4-G	123+15.2	Med.	62.5	62.5
Total				737.5

B BARRIER RAIL I-15

Ref No.	Station	Side	Steel Beam Type (Depth)	Lin. Ft.
1-B	123+85.7	Med.	25	25
2-B	124+07.7	Med.	25	25
Total				50

D DRAINAGE

Ref No.	Station	Side	I-10		I-14		L-10	
			From	To	From	To	From	To
9-D	117+00	Lt.	117+00	119+00				
10-D	121+00	Lt.	121+00	122+77				
11-D	124+87	Lt.	124+87	127+00				
12-D	119+00	Rt.	119+00	119+12	13	74		
13-D	122+00	Rt.	122+00	122+75				
14-D	122+30	Rt.	122+30	123+00				
15-D	124+00	Rt.	124+00	124+67				
16-D	124+35	Rt.	124+35	125+70				
17-D	125+70	Rt.	125+70	127+00				
18-D	125+70	Rt.	125+70	126+50				
19-D	119+00	Med.						
20-D	125+25	Med.						
21-D	121+00	Med.						
Totals					13	74		1056

D DRAINAGE

Ref No.	Station	Side	I-2		I-3		I-4		I-5 Pipe Specials				I-6						
			Class 'A' 51' Sewer	Class 'B' 51' Sewer	Class 'A' 51' Storm Sewer	Class 'B' 51' Storm Sewer	6" C.M.P. Outlet Pipe	6" Pipe Under-drains	6" x 6" Wye	6" Bend	6" x 6" Tee	6" x 8" Increase	8" x 8" Double Tee Branch	Std. No. 7 Catch Basin	Std. No. 5 Catch Basin	Conc. for Str. Class. Cu. Yd.	Reinf. Steel Lbs.		
1-D	117+00	Lt.					30	1606	3										
2-D	117+00	Lt.					30	1535	2										
3-D	117+00	Rt.					10	1524	1										
4-D	117+00	Rt.					10	1571	1										
5-D	119+00	Lt.			96														
6-D	119+00	Rt.	56				10												
7-D	124+00	Med.			44														
8-D	119+00	Lt.					374									3.2	146		
9-D	117+00	Med.					196												
10-D	119+00	Med.					196												
11-D	119+00	Med.					396	374	90	6286	6	2	2	1	1	1	1	3.2	146
Totals			56	96	44	396	374	90	6286	6	2	2	1	1	1	1	1	3.2	146

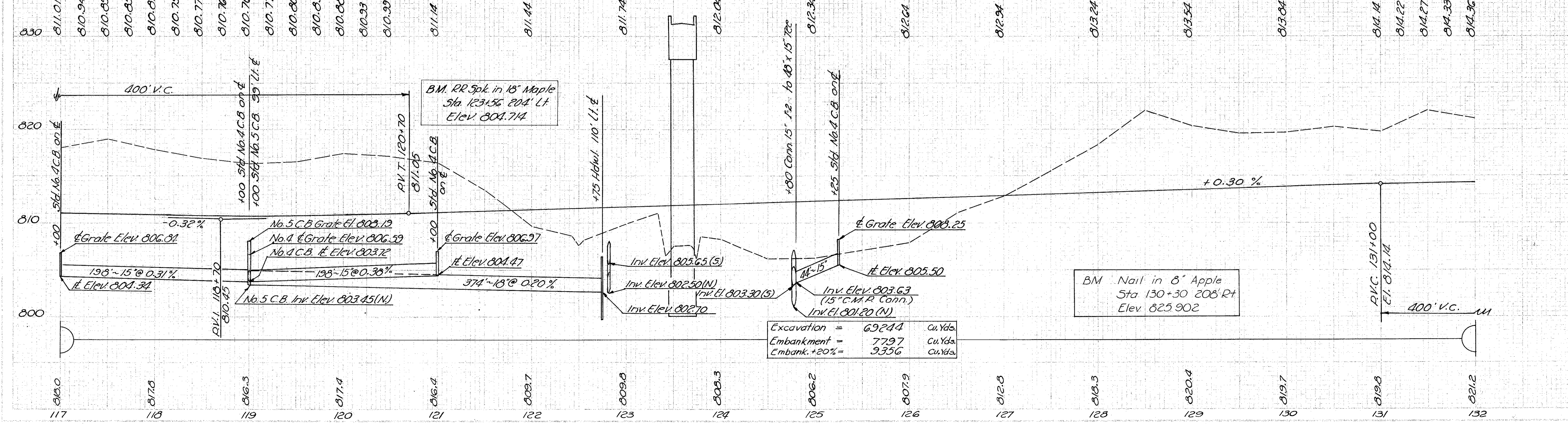

Excavation	=	69244	Cu. Yds.
Embankment	=	7797	Cu. Yds.
Embank. +20%	=	9356	Cu. Yds.