

**EXISTING CURVE DATA**  
 P.I. Sta. 849+62.84 T=1668.19'  
 Δ=15°28'30" L=3316.87'  
 D=0°23' E=112.83'  
 R=12,277.66'

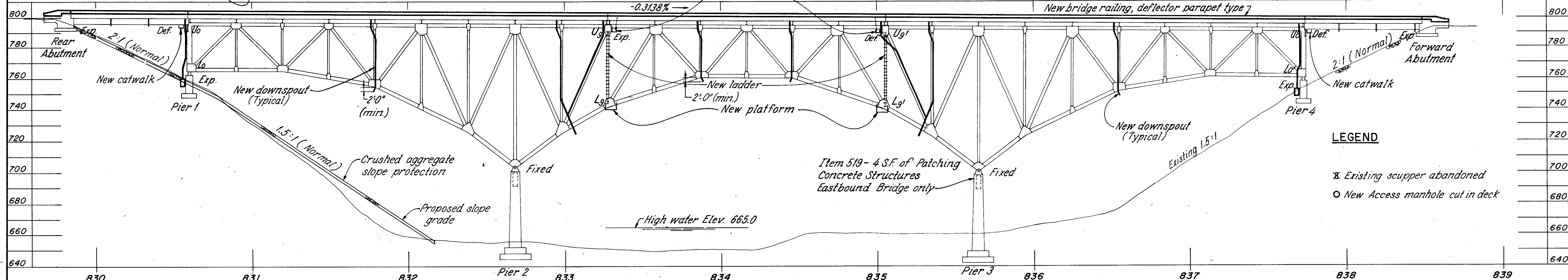
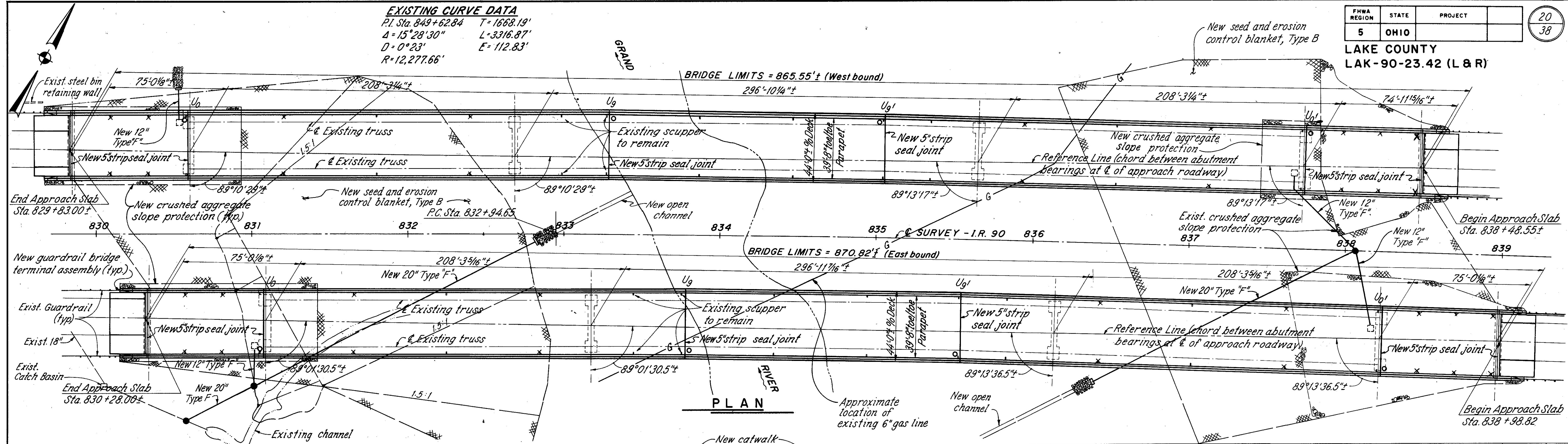

**LEGEND**

⊗ Existing scupper abandoned

○ New Access manhole cut in deck

**NOTES**

**UNDERGROUND DRAINAGE DETAILS:**  
 See sheet 4 of 38 thru 19 of 38.

**EXISTING STRUCTURE**

**TYPE:** Cantilever steel truss with stringers and floorbeams main spans and simple span steel girder approach spans with reinforced concrete deck and substructure.

**SPANS:** 75'-0"±; 208'-0"±; 297'-0"±; 208'-0"±; 75'-0"±

**ROADWAY:** 39'-8" f/p curbs

**LOADING:** Equivalent HS13.1 (130% Ohio Legal Loads)

**SKEW:** 0°

**ALIGNMENT:** Tangent to 0°28' curve right

**CONDITION:** Fair

**YEAR BUILT:** 1958

**STRUCTURE FILE NUMBER:** 4304950 & 4304985

**PROPOSED STRUCTURE**

**TYPE:** Rehabilitation of existing superstructure on existing substructure including new asphalt wearing surface, new strip seal joints, new railing, new downspouts, minor repairs to trusses and painting.

**SPANS:** Same as existing

**ROADWAY:** 39'-8" toe to toe of deflector parapet

**LOADING:** Equivalent HS13.1 (130% Ohio Legal Loads)

**SKEW:** Same as existing

**WEARING SURFACE:** 1 1/4" 404 Asphalt with Verglmit additive and Type "D" waterproofing

**APPROACH SLABS:** Same as existing

**ALIGNMENT:** Same as existing

**DESIGN AVERAGE DAILY TRAFFIC:** 26,700 (2008)

**DESIGN AVERAGE DAILY TRUCK TRAFFIC:** 7,250 (27%)(2008)

**RE** RICHLAND ENGINEERING LIMITED  
 MANSFIELD, OHIO

**GENERAL PLAN**  
 SUPERSTRUCTURE  
 BRIDGE NO. LAK - 90-2342 (L & R)  
 OVER THE GRAND RIVER

DESIGNED	DRAWN	TRACED	CHECKED	REVIEWED	DATE	REVISED
DHT	RHU	UL	DT	DAP	9/13/09	