

LAKE COUNTY
LAK-90-23.42 (L & R)

QUANTITIES		
CALCULATED	DT	1/89
CHECKED	JS	1/89

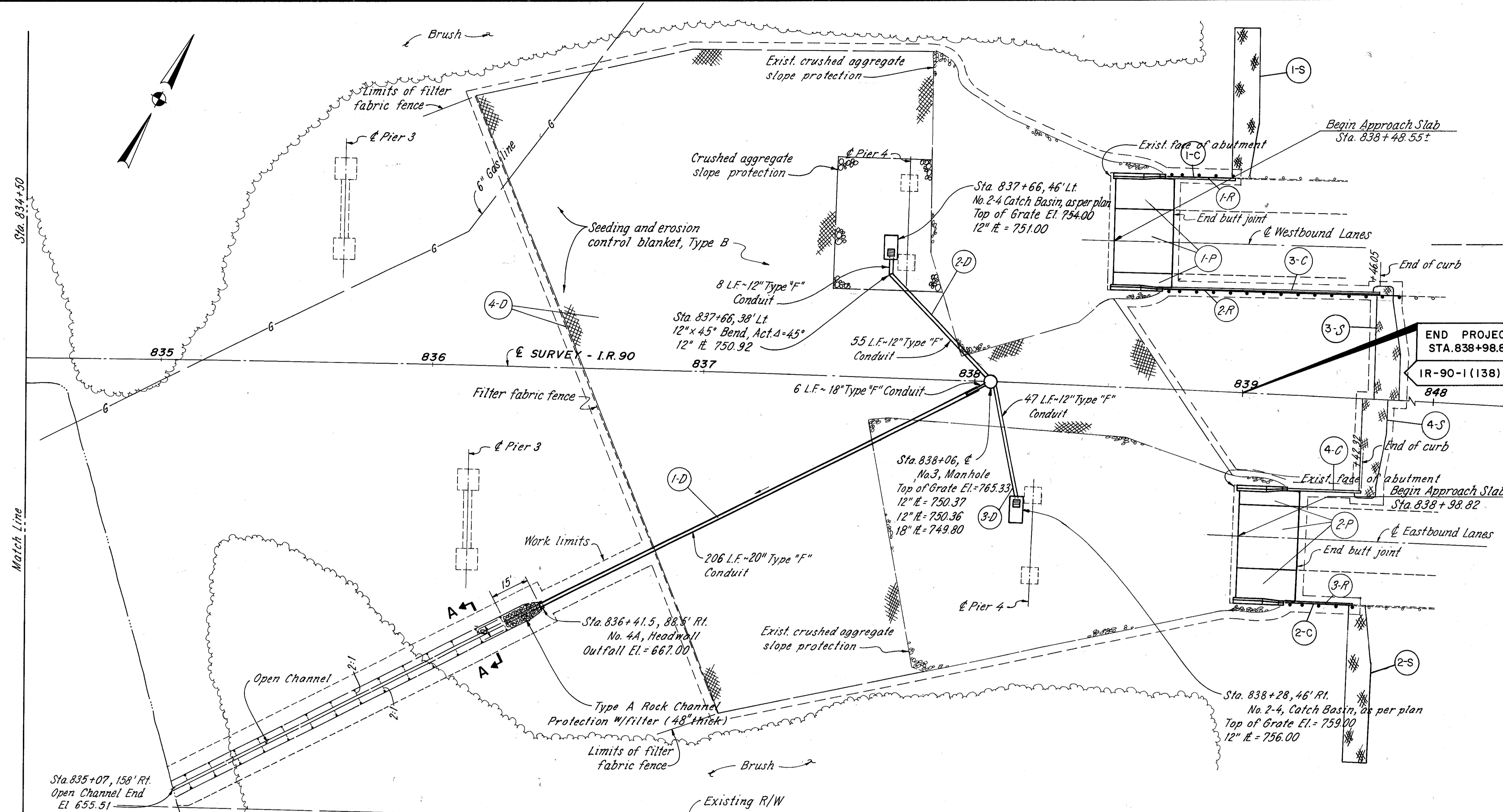

SECTION A-A

END PROJECT STA. 838+98.82
IR-90-1 (138) 67
END WORK STA. 848+67

SEEDING QUANTITY:

245 x 210 =	51450
12 x 125 =	1500
22 x 150 =	3300
Deduct	
78 x 75 =	- 5850
145 x 80 =	- 11600
40 x 50 =	- 2000
	36,800 ÷ 9 = 4088.89

- NOTES**
- CRUSHED AGGREGATE SLOPE PROTECTION damaged by pipe excavation shall be repaired with quantities shown on sheet 24.
 - BRIDGE SUPERSTRUCTURE not shown.
 - PROFILES for 12" Type "F" Conduits and drainage details shown on sheet 7.
 - CROSS SECTIONS for earthwork on sheet 8 thru 13.
 - CONCRETE MASONRY AS PER PLAN: No. 4A, Headwall except for no anchors needed.
 - CURB - FACE OF CURB TO MATCH FACE OF GUARDRAIL

Excavation	24 C.Y.
Embankment	0
Seeding	4089 S.Y.
Fertilizer	0.37 Ton

REFERENCE NO.	SIDE	STATION		603		601		602		603		604		609		207		843	
		FROM	TO	L.F.	L.F.	C.Y.	C.Y.	L.F.	Ea.	Ea.	L.F.	L.F.	S.Y.	S.Y.					
1-C	LT.	838+66.05	838+92.05																
1-D	Rt.	836+41.5	838+03	6	206	14	0.4												
2-D	Lt.	837+78.5	837+03							63			1						
3-D	Rt.	838+03	838+28							47			1						
4-D	Lt.-Rt.	836+14	838+98													245	3556		
2-C	Rt.	839+16.32	839+42.32													26			
3-C	Lt.	838+66.05	839+46.05													80			
4-C	Rt.	839+16.32	839+42.32													26			
TOTALS				6	206	14	0.4	110	1	2	158	245	3556						

REFERENCE NO.	SIDE	STATION		202		403		407		606		404		660	
		FROM	TO	L.F.	S.Y.	C.Y.	Gal.	Ea.	L.F.	C.Y.	S.Y.				
1-R	Lt.	838+66.05	838+91.05	25					1	25					
2-R	Lt.	838+66.05	839+53.55	87.5					1	87.5					
3-R	Rt.	839+16.32	839+41.32	25					1	25					
1-S	Lt.	838+91.05	839+01.05												54
1-P	Lt.	838+48.55	838+73.55		110.2	3.1	110					3.8			
2-P	Rt.	838+98.82	839+23.82		110.2	3.1	110					3.8			
2-S	Rt.	839+41.32	839+50.32												54
3-S	Lt.	839+45.05	839+54.05												38
4-S	Rt.	839+41.32	839+50.32												38
TOTALS				137.5	2204	6.2	220	3	137.5	76	184				

RE RICHLAND ENGINEERING LIMITED
MANSFIELD, OHIO

PLAN SHEET
STA. 834+50 TO STA. 840+00

BRIDGE NO. LAK-90-2342 (L&R)
OVER THE GRAND RIVER

LAKE COUNTY I.R.90

DESIGNED	DHT	DRAWN	KH	TRACED	KH	CHECKED	JH	REVIEWED	DAP	DATE	9/13/89	REVISED	
----------	-----	-------	----	--------	----	---------	----	----------	-----	------	---------	---------	--