

L-M

DATE	10/4/96
REVIEWED	DHT
STRUCTURE FILE NO.	4304950 & 4304965
DESIGNED	DAP
CHECKED	MSL
DRAWN	JPS
REVISION	2/20/97

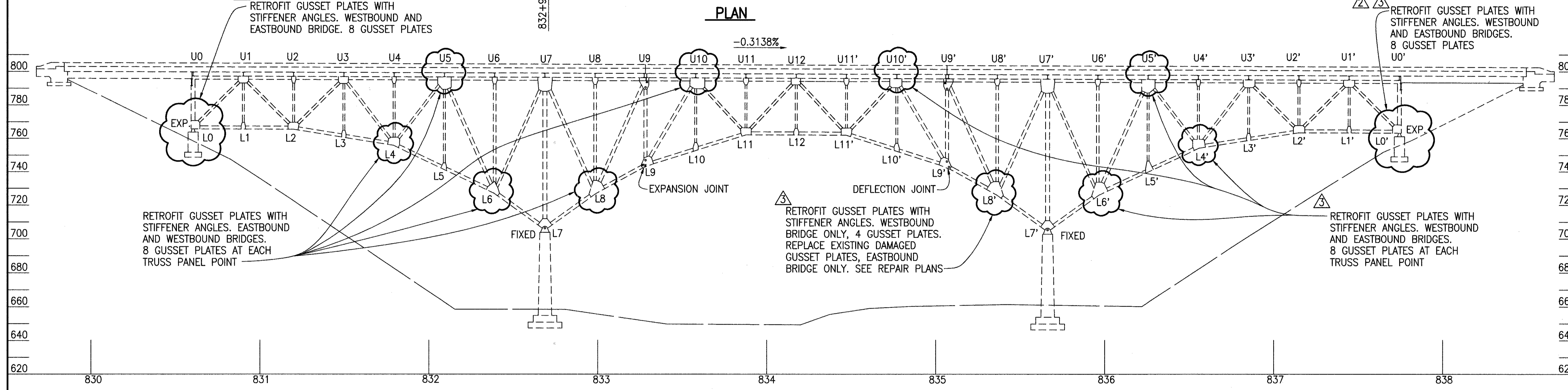
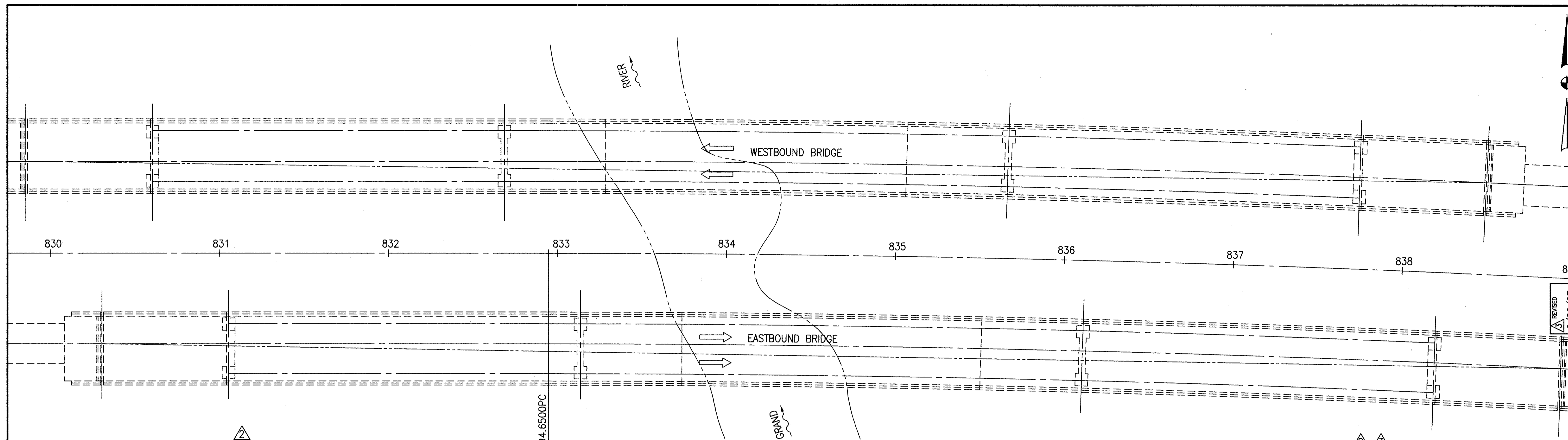

PROFILE

PROJ 9001-96 PID 16395

EXISTING STRUCTURE

TYPE: CANTILEVER STEEL TRUSS WITH STRINGERS AND FLOORBEAMS
 MAIN SPANS AND SIMPLE SPAN STEEL GIRDER APPROACH
 SPANS WITH REINFORCED CONCRETE DECK AND SUBSTRUCTURE
 SPANS: 75'-0"±; 208'-0"±; 297'-0"±; 208'-0"±; 75'-0"±
 ROADWAY: 39'-8" TOE TO TOE OF DEFLECTOR PARAPET
 LOADING: EQUIVALENT HS13.1 (130% OHIO LEGAL LOADS)
 SKEW: 0°
 WEARING SURFACE: 1 1/4" 404 ASPHALT WITH VERGLIMIT ADDITIVE AND TYPE D WATERPROOFING

APPROACH SLABS:
 ALIGNMENT: TANGENT TO 0°28' CURVE RIGHT
 DESIGN AVERAGE DAILY TRAFFIC:
 DESIGN AVERAGE DAILY TRUCK TRAFFIC:

GENERAL PLAN - GUSSET PLATE RETROFIT
 BRIDGE NO. LAK-90-2342 L&R
 OVER THE GRAND RIVER

LAK-90-23.42 L&R

Job No. 96073CP4 Date 3/1/97 Drawn By JPS