

LAKE COUNTY
LAK-1-22.60

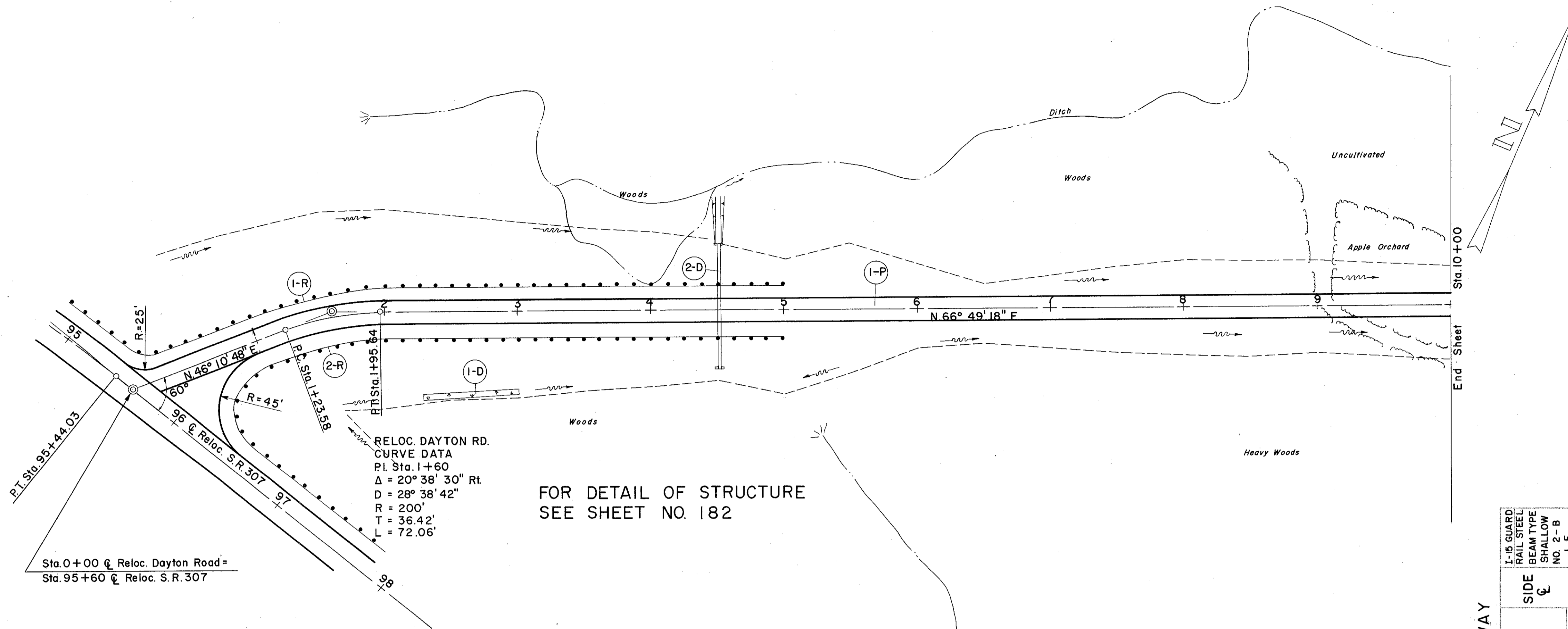

RELOC. DAYTON RD.
CURVE DATA
P.I. Sta. 1+60
Δ = 20° 38' 30" Rt.
D = 28° 38' 42"
R = 200'
T = 36.42'
L = 72.06'

FOR DETAIL OF STRUCTURE
SEE SHEET NO. 182

Sta. 0+00 C Reloc. Dayton Road =
Sta. 95+60 C Reloc. S.R. 307

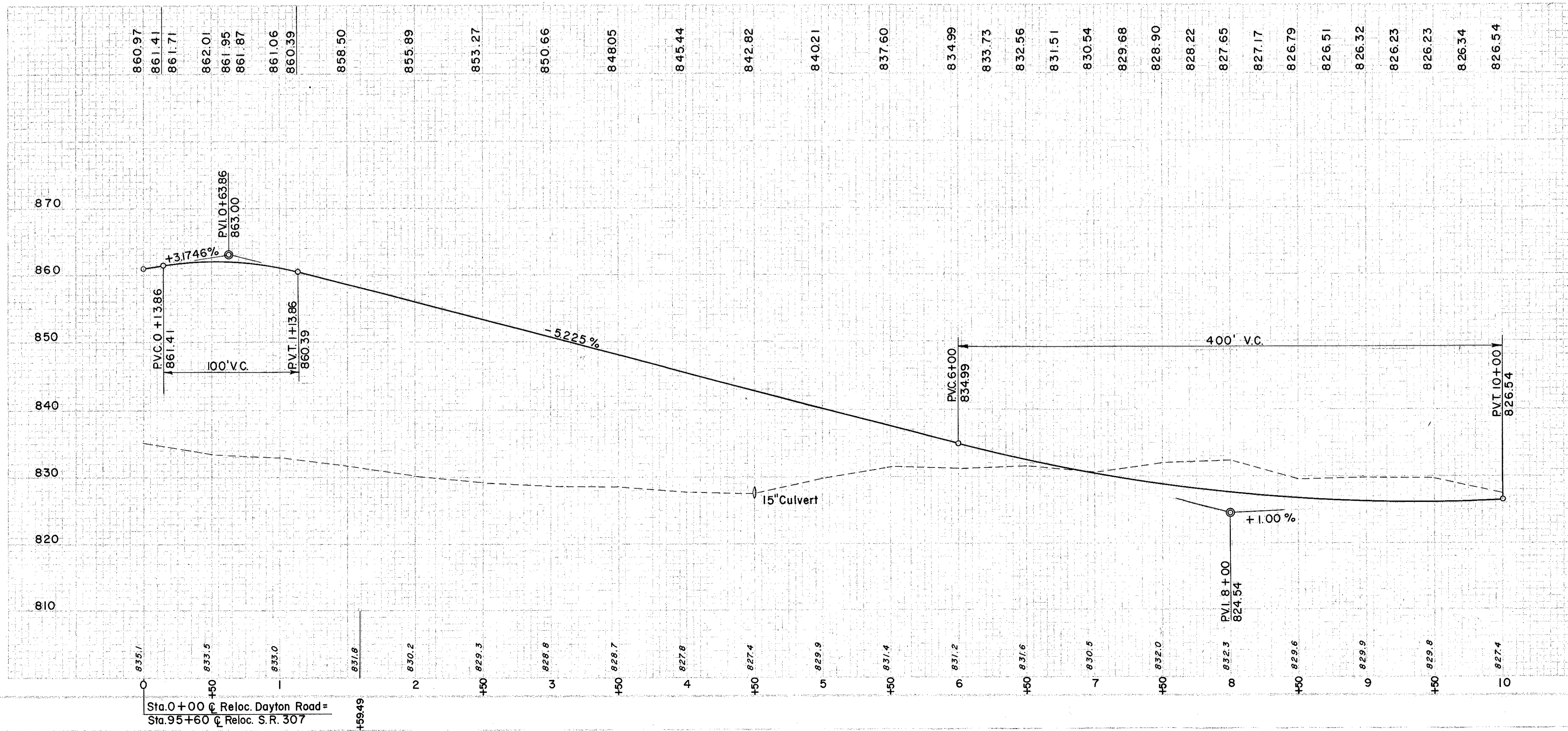

Sta. 0+00 C Reloc. Dayton Road =
Sta. 95+60 C Reloc. S.R. 307

(R) ROADWAY

REF. NO.	STATION	SIDE	ROADWAY		TOTAL
			FROM	TO	
I-R	1+00	RT	1+00	5+00	400
2-R	1+00	LT	1+00	5+00	387.5
					787.5

(P) PAVEMENT

REF. NO.	STATION	TO	PAVEMENT		TOTAL
			FROM	TO	
I-P	0+00	20+50	303	2449	1044
					861
					465
					7283
					889

(D) DRAINAGE

REF. NO.	STATION	SIDE	EXC. OR FOR STRUCT.	CHANNEL EXC. C.Y.	SODDING FT.	FOR ROW. CLASS 'E' CULVERTS S.Y.	CONC. FOR 15" PIPE STRUCT. FOR ROW. CLASS 'E' CULVERTS S.Y.
I-D	2+23	RT	7	11	2	0.52	94
2-D	4+50	RT	7	11	2	0.52	94

STATION	SODDING RIGHT DITCH		S. Y.
	DEPTH OF SODDING FT.	WIDTH OF SODDING FT.	
2+25	0.35	2.1	3.1
3+00	0.35	2.1	3.1
		4.0	7.5
		4.0	33

EXCAVATION	= 2,976 C.Y.
EMBANKMENT	= 27,752 C.Y.
EMBANKMENT 22	= 33,857 C.Y.