

LAKE COUNTY
LAK - I - 22.60

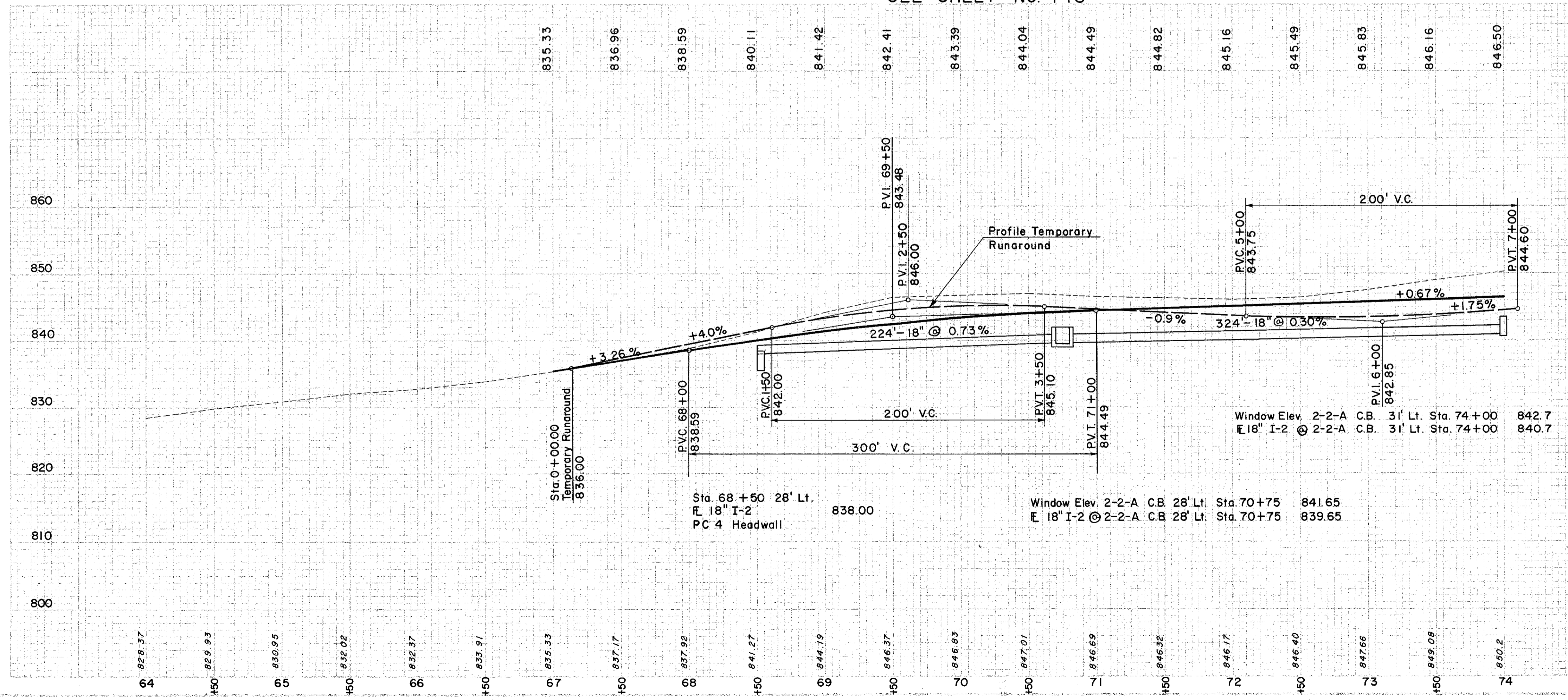
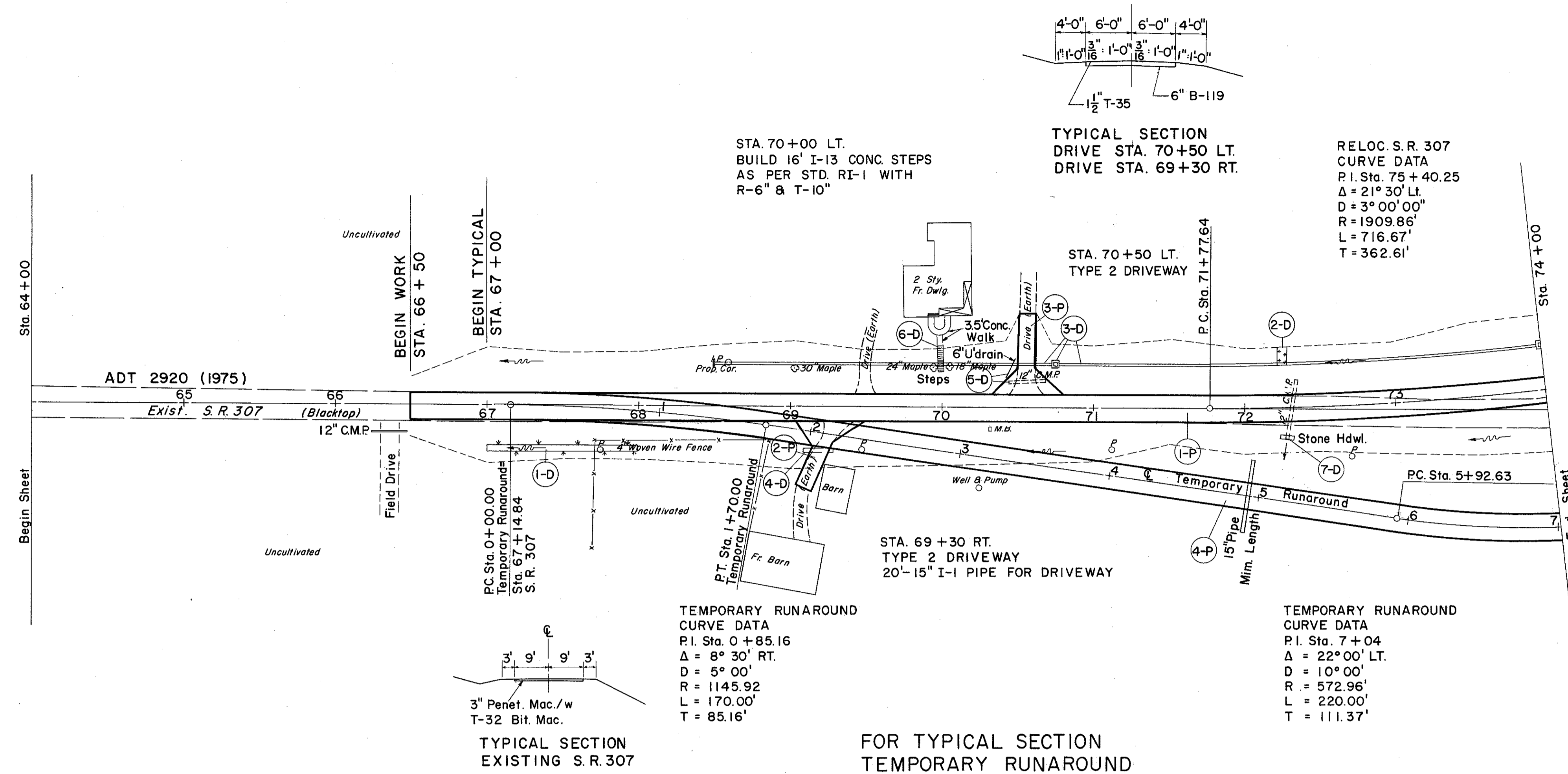

(D) DRAINAGE

REF. NO.	STATION	SIDE	REMOVAL OF EXIST. PIPE 15" & UNDER	E-12	L-10	I-2	I-8	S-1	I-1	I-13	S-24
FROM	TO										REMOVAL OF EXIST. STRUCT. LUMP
I-D	67+00	RT.									
2-D	72+25	LT.									
3-D	68+50	LT.									
4-D	69+08	LT.									
5-D	70+50	LT.									
6-D	70+00	LT.									
7-D	72+30	LT.									
I-P	66+50	LT.									
2-P	69+30	LT.									
3-P	70+50	LT.									
4-P	0+00	LT.									
TOTALS											581.5

(P) PAVEMENT

REF. NO.	STATION	SIDE	REMOVAL OF EXIST. STRUCT. LUMP	I-18	S-15	CL-B	
FROM	TO						
I-P	66+50	LT.					
2-P	69+30	LT.					
3-P	70+50	LT.					
4-P	0+00	LT.					
TOTALS							581.5

SODDING RIGHT DITCH

STATION	DEPTH OF SODDING	WIDTH OF SODDING	LENGTH	S.Y.	
FROM	TO	F. B.	F. T.		
67+00	68+00	4-1	3-1	36	
68+00	69+00	4-1	3-1	36	
TOTALS					72

EXCAVATION	4815 C.Y.
EMBANKMENT	128 C.Y.
REPAIRMENT	156 C.Y.