

LAKE COUNTY  
LAK-1-22.60

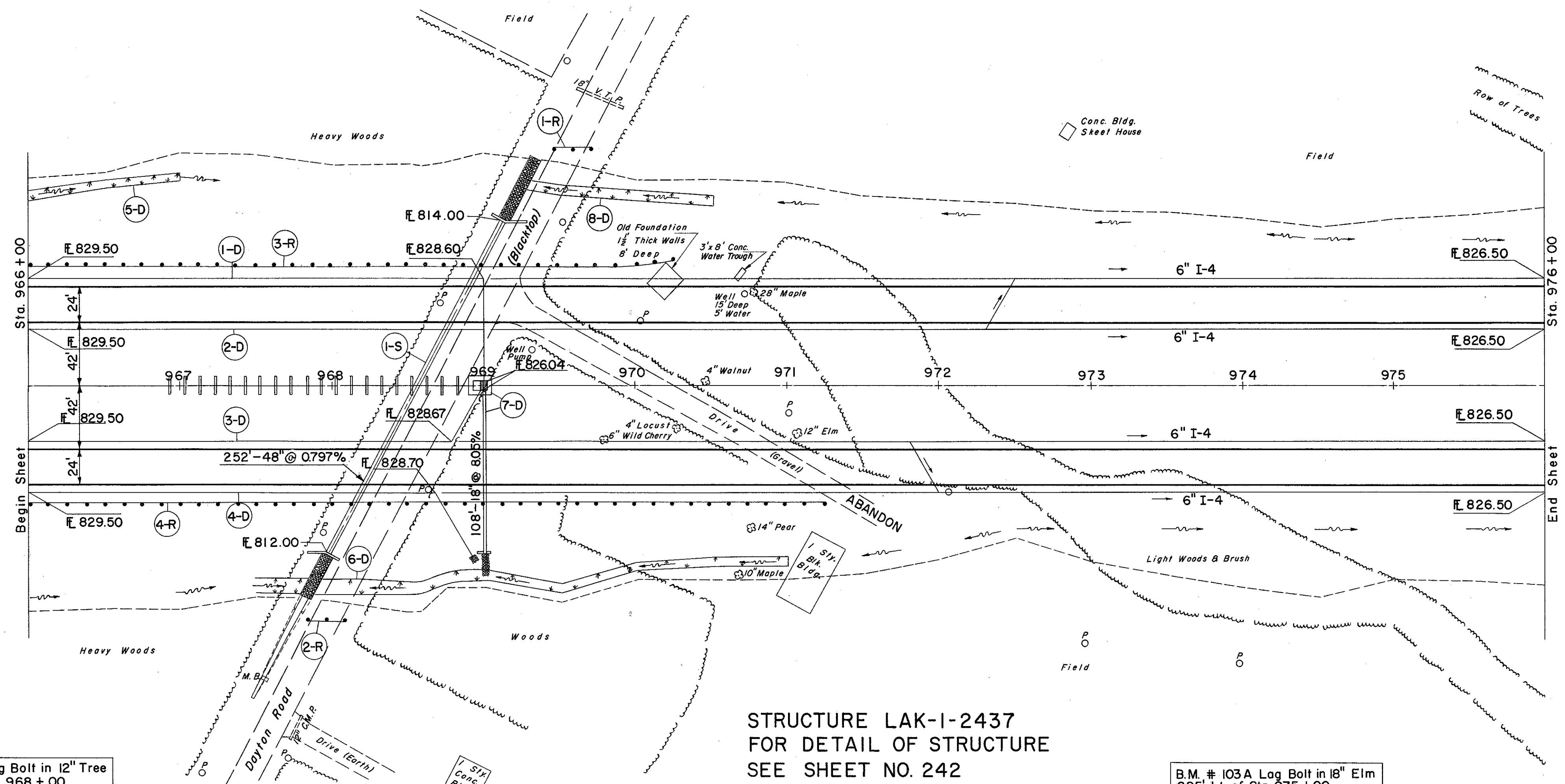

STRUCTURE LAK-I-2437  
FOR DETAIL OF STRUCTURE  
SEE SHEET NO. 242

B.M. # 102A Lag Bolt in 12" Tree  
170' Rt. of Sta. 968+00  
Elev. 817.57

B.M. # 103A Lag Bolt in 18" Elm  
225' Lt. of Sta. 975+00  
Elev. 833.50

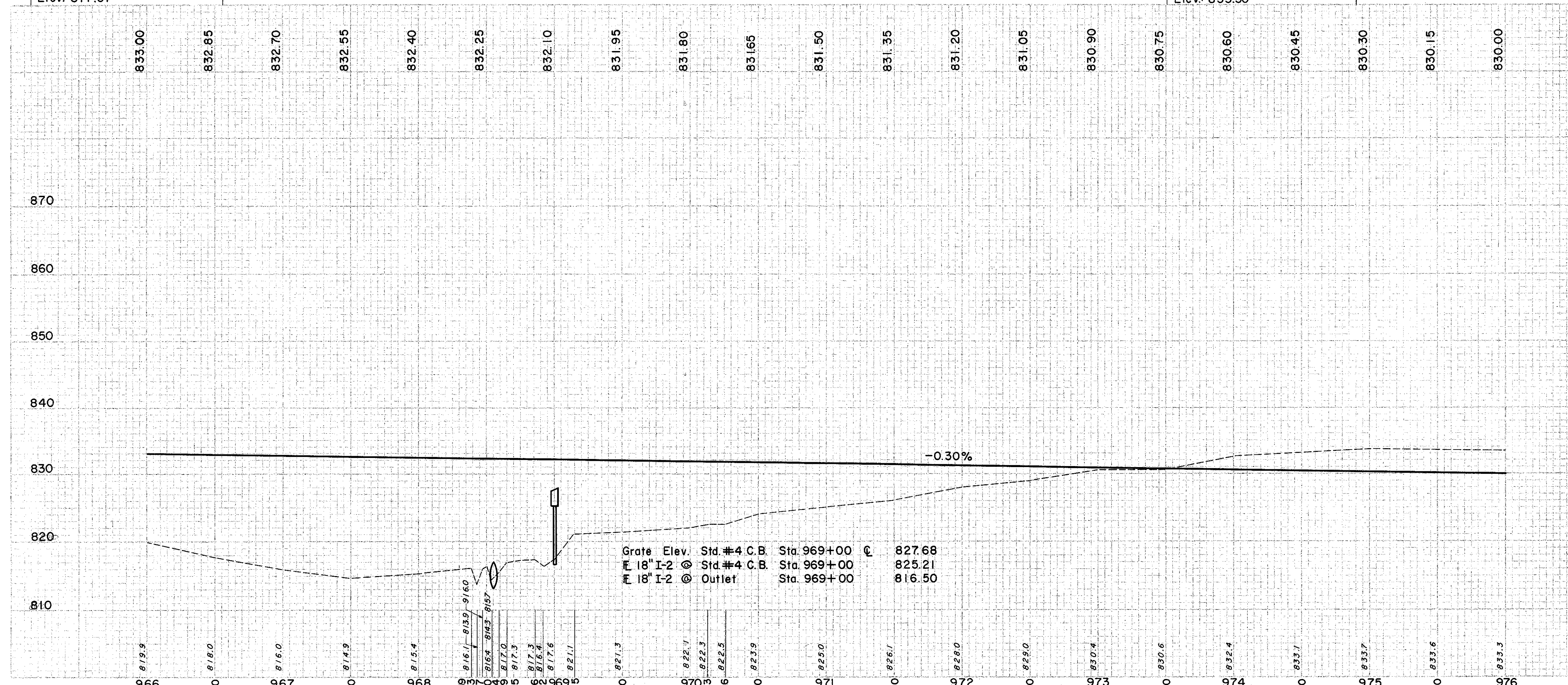

Grate Elev. Std #4 C.B. Sta. 969+00 @ 827.68  
 18" I-2 @ Std #4 C.B. Sta. 969+00 @ 825.21  
 18" I-2 @ Outlet Sta. 969+00 @ 816.50

① DRAINAGE

REF. NO.	STATION	SIDE	CLASS "A" STORM SEWER UNDER PAVT. OR 8" I-2	8" OUT-LET PIPE UNDER M-6.5(b) OR M-6.8(d)	6" OUT-LET PIPE UNDER M-6.4(g)	6" WYE	6" 90° BEND	6" INCREASER	6" x 8" INCREASER	6" x 8" x 8" Tee	60° BEND	STD. #4 CATCH BASIN	I-8	L-10	I-10	S-1	S-4	E-2	S-29		
FROM	TO		CLASS. LIN. FT.	SEC. LIN. FT.	SEC. LIN. FT.							EACH	EACH	S.Y.	C.Y.	C.Y.	C.Y.	C.Y.	C.Y.	EXC. FOR STRUCT.	DRAINAGE OF STRUCT. NO. 2
I-S	968+00		1032																		
I-D	966+00	7/LT		1032																	
I-D	966+00	7/RT		996																	
I-D	966+00	3/LT	56	10	1026																
I-D	966+00	3/RT		1026	10																
I-D	966+00	7/LT		1070	10																
I-D	966+00	7/RT																			
I-D	967+50	971+00	108																		
I-D	968+00	970+50	LT																		
I-D	968+00	970+50	RT																		
I-D	968+00	970+50	LT																		

② STRUCTURES

REF. NO.	STATION	SIDE	EXC. FOR STRUCT.	CHANNEL EXC.	I-10	L-10	S-1	S-4	S-27
FROM	TO		C.Y.	C.Y.	C.Y.	C.Y.	C.Y.	L.B.	L.F.
I-S	968+00		191	71	96	9	30	1332	252

③ SODDING LEFT DITCH

STATION	DEPTH OF SODDING	SLOPE	WIDTH OF SODDING	LENGTH	S.Y.
FT.	FT.	F. B.	FT.	FT.	
966+00	3	4:1	4:1	64	100
967+00	2	4:1	4:1	48	62
968+00	3.5	4:1	4:1	68	110
970+50	3	4:1	4:1	64	172
SUB-TOTAL					302
967+50	.65	4:1	4:1	9.2	52
968+00	.7	4:1	4:1	9.6	56
968+59	.45	4:1	4:1	7.6	14
968+75	.5	4:1	4:1	8.0	180
971+00	.25	3:1	6:1	6.3	302
SUB-TOTAL					302

④ ROADWAY

REF. NO.	STATION	SIDE	E-15 GUARD RAIL/STEEL BEAM TYPE (DEEP)	NO. 2-B	L.F.	RT.	LT.	TOTAL
I-R	969+46				969+71			
2-R	967+85				968+08			
3-R	966+00				970+25			
4-R	966+00				971+25			
								1000

EXCAVATION = 11,236 C.Y.  
 EMBANKMENT = 46,708 C.Y.  
 EMBANKMENT @ 22° = 56,984 C.Y.