

LAKE COUNTY  
SEC. LAK-1-20.03

Bench Mark #83A Log bolt in T.M. Cherry  
200' Rt. Sta. 756+00. Elev. 868.27.  
Bench Mark #84A Log bolt in root 36" Oak  
170' Rt. Sta. 763+30. Elev. 868.57.

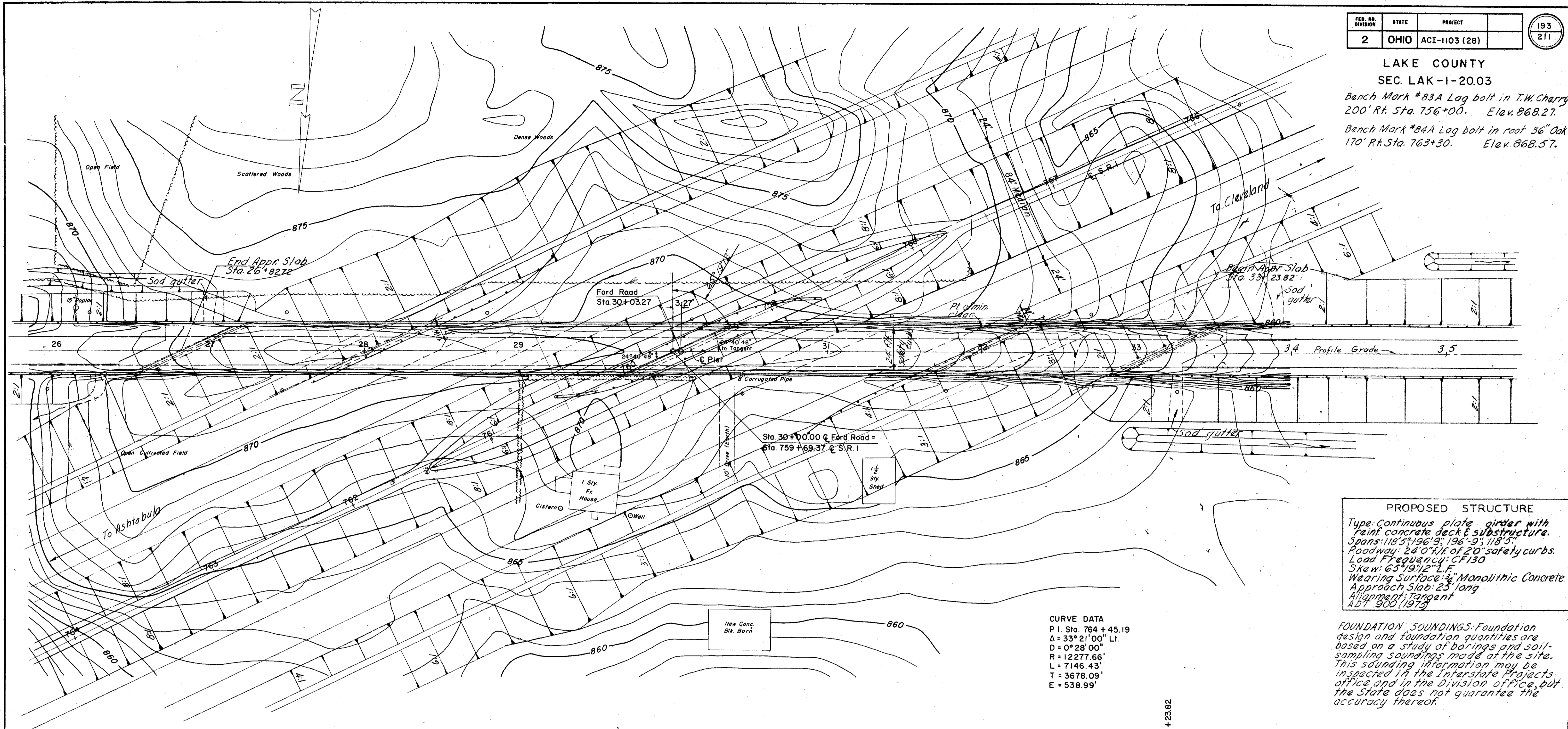

**PROPOSED STRUCTURE**  
Type: Continuous plate girder with  
reinforced concrete deck & substructure.  
Spans: 118'-5", 196'-9", 196'-9", 118'-5"  
Roadway: 24'-0" w/ 2' of 2'-0" safety curbs.  
Load Frequency: CF130  
Skew: 65° 19' 12" L.F.  
Wearing Surface: 4" Monolithic Concrete  
Approach Slab: 25' long  
Alignment: Tangent  
A.D.T. 900 (1973)

**CURVE DATA**  
P.I. Sta. 764 + 45.19  
Δ = 33° 21' 00" Lt.  
D = 0° 28' 00"  
R = 12277.66'  
L = 7146.43'  
T = 3678.09'  
E = 538.99'

**FOUNDATION SOUNDINGS:** Foundation design and foundation quantities are based on a study of borings and soil-sampling soundings made at the site. This sounding information may be inspected in the Interstate Projects office and in the Division office, but the State does not guarantee the accuracy thereof.

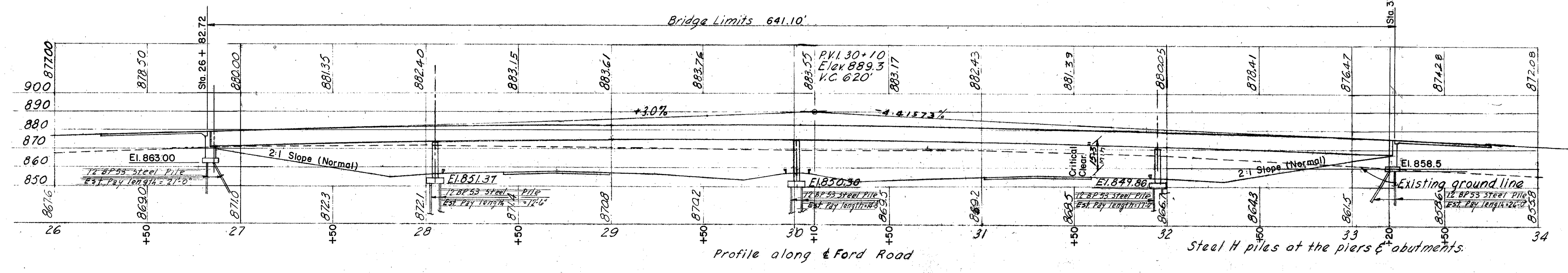

SEC. C-34 FED. AID PROJ. NO. ACI-1103(28)

PREPARED BY  
CAPITOL ENGINEERING ASSOCIATES, DILLSBURG, PA.  
FOR  
STATE OF OHIO  
DEPARTMENT OF HIGHWAYS

**SITE PLAN**  
BRIDGE NO. LAK-1-2111  
S.R.I. UNDER FORD ROAD  
LAKE COUNTY  
STA. 759 + 69.37

DESIGNED	DRAWN	TRACED	CHECKED	REVISED	DATE	REVISED
	McC.					