

LAKE COUNTY  
SEC. LAK-1-20.03

Bench Mark - #77A Lag bolt in root  
18" Walnut 200' Rt. Sta. 699+25.  
Elev. 858.90

Bench Mark - #78A Lag bolt in root  
24" Maple 300' Lt. Sta. 711+25.  
Elev. 845.96

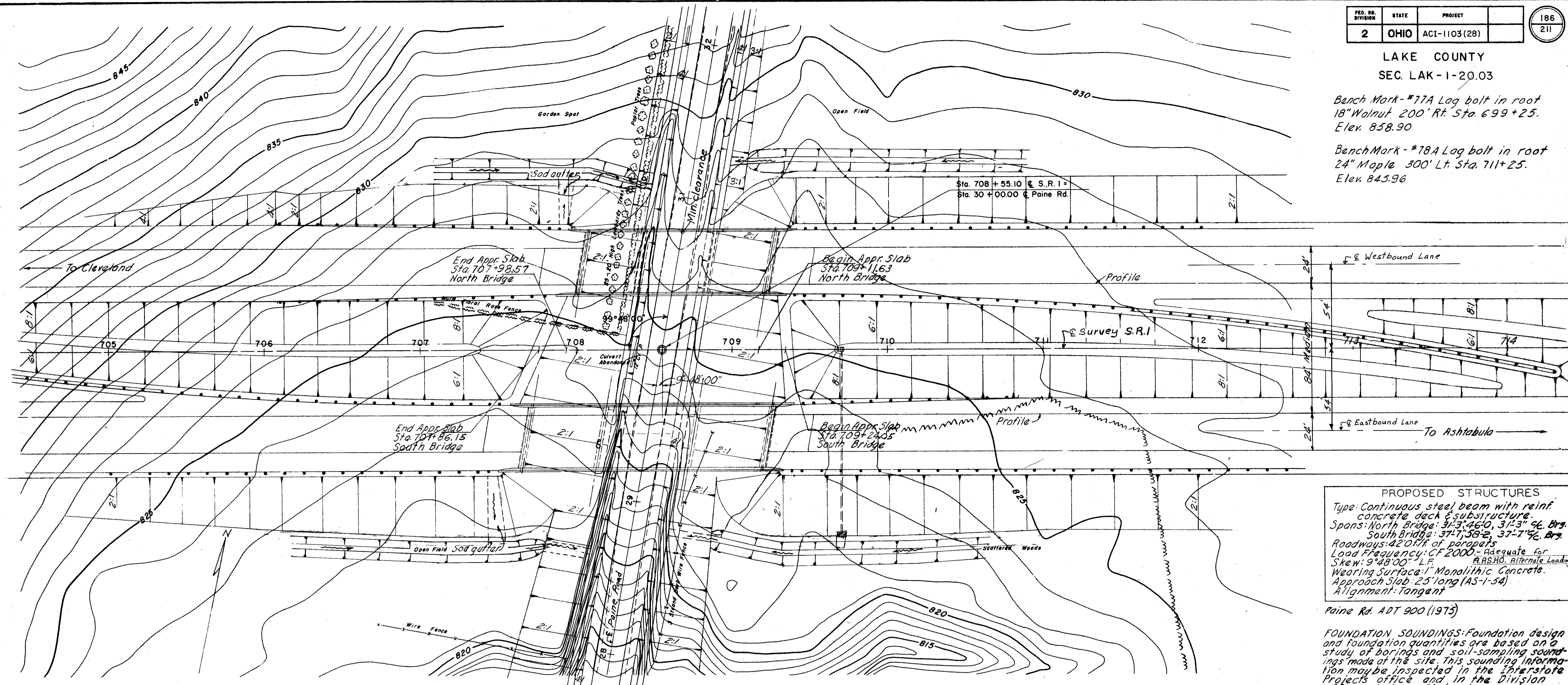

**PROPOSED STRUCTURES**

Type: Continuous steel beam with reinf. concrete deck & substructure.  
Spans: North Bridge: 31'-3", 46'-0", 31'-3" c/c. Brg.  
South Bridge: 37'-1", 58'-2", 37'-7" c/c. Brg.  
Roadways: 42' O.H. of parapets  
Load Frequency: CF 2000 - Adequate for AASHO, Alternate Loading  
Skew: 9° 48' 00" - L.F.  
Wearing Surface: 1" Monolithic Concrete.  
Approach Slab: 25' long (AS-1-54)  
Alignment: Tangent

Paine Rd. ADT 900 (1975)

**FOUNDATION SOUNDINGS:** Foundation design and foundation quantities are based on a study of borings and soil-sampling soundings made at the site. This sounding information may be inspected in the Interstate Projects office and in the Division office, but the State does not guarantee the accuracy thereof.

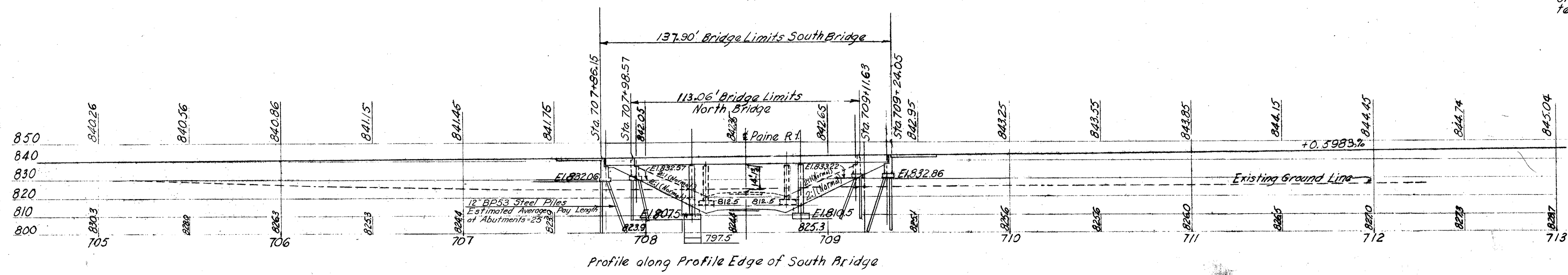

SEC. C-34 FED. AID PROJ. NO. ACI-1103(28)

PREPARED BY  
CAPITOL ENGINEERING ASSOCIATES, DILLSBURG, PA.  
FOR  
STATE OF OHIO  
DEPARTMENT OF HIGHWAYS

**SITE PLAN**  
BRIDGE NO. LAK-1-2012  
S.R.1 OVER PAINE ROAD  
LAKE COUNTY  
STA. 708 + 55.10

DESIGNED	DRAWN	TRACED	CHECKED	REVISED	DATE	REVISED
H.F.B.	M.C.					