

LAKE COUNTY
LAK-1-2003

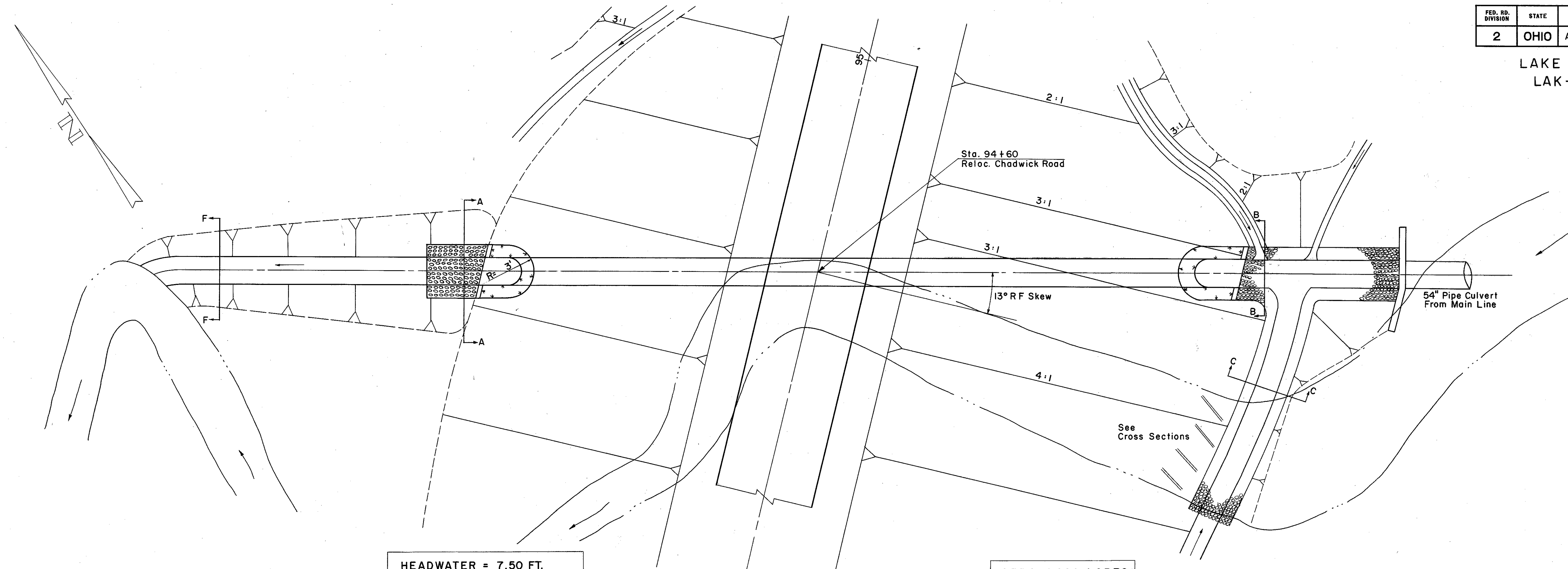

HEADWATER = 7.50 FT.
OUTLET VELOCITY = 10.8 F.P.S.

AREA = 280 ACRES
Q₂₅ = 180 C.F.S.

SCALE 1" = 10'

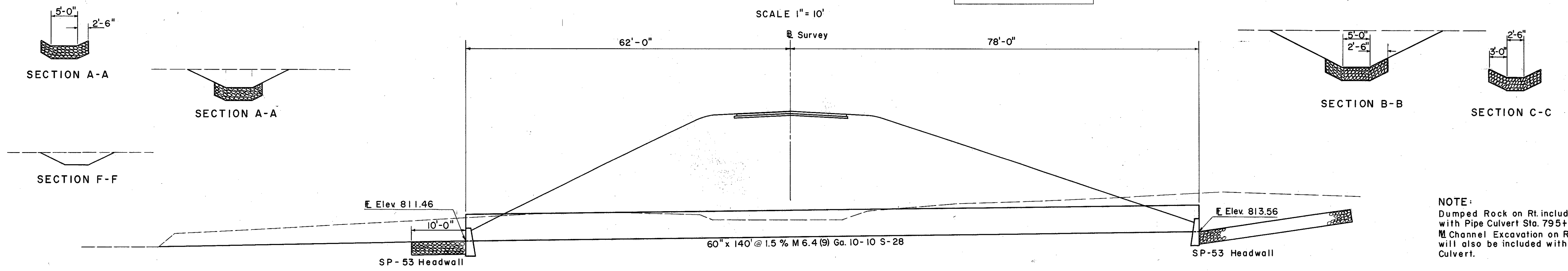

NOTE:
Dumped Rock on Rt. included with Pipe Culvert Sta. 795+70
Channel Excavation on Rt. will also be included with Culvert.

CULVERT DATA

TYPE: Pipe Culvert S-28 M 6.4 (9) 10-110 Ga. SP 53
SIZE: 60" x 140'

WORK REQ'D.: Build a Pipe Culvert with SP 53 Headwalls
Sodding Rt. & Lt. with Dumped Rock Rt. & Lt.
As Shown.

ESTIMATED QUANTITIES

| | | |
|------|------------------------------|------------|
| E-2 | Structure Excavation | 73.27 C.Y. |
| E-3 | Channel Excavation | 162.5 C.Y. |
| L-10 | Sodding | 10.6 S.Y. |
| I-10 | Dumped Rock | 9.3 C.Y. |
| S-1 | Conc. for Structure | 3.8 C.Y. |
| S-28 | 60" Pipe for Roadway Culvert | 140.0 L.F. |