

LAKE COUNTY
LAK-I- 20.03

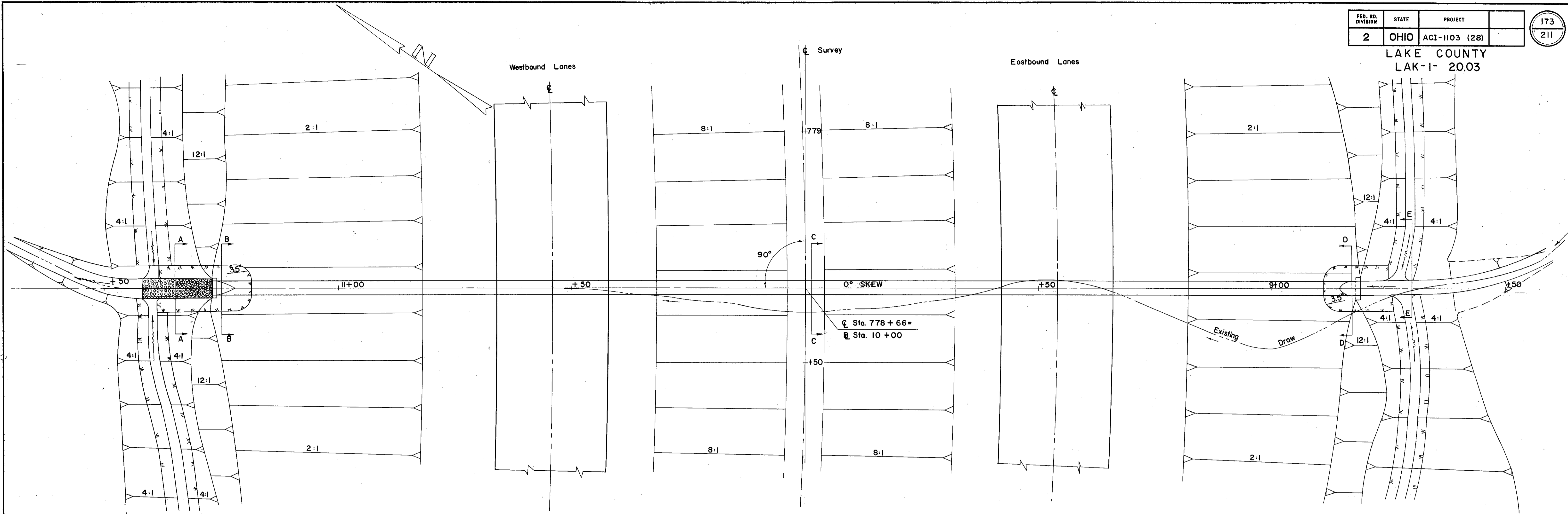

SCALE 1" = 10'

ESTIMATED QUANTITIES

E-2 Excavation For Structures	131 C.Y.
L-10 Sodding	30 S.Y.
S-1 Concrete For Structures Class "E"	1,02 C.Y.
S-27 30" Pipe For Roadway Culvert	246 L.F.
I-10 Dumped Rock Channel Protection	5.5 C.Y.
E-3 Excavation For Channel	16 C.Y.

CULVERT DATA

TYPE: Pipe Culvert S-27, M-6-6 (C)
 SIZE: 30" x 248'
 WORK REQ'D. Build a pipe culvert with Std. PC; 4 Endwalls Rt. and Lt. Place Sodding Lt. and Rt. Excavate for Channel on Rt. and Lt.

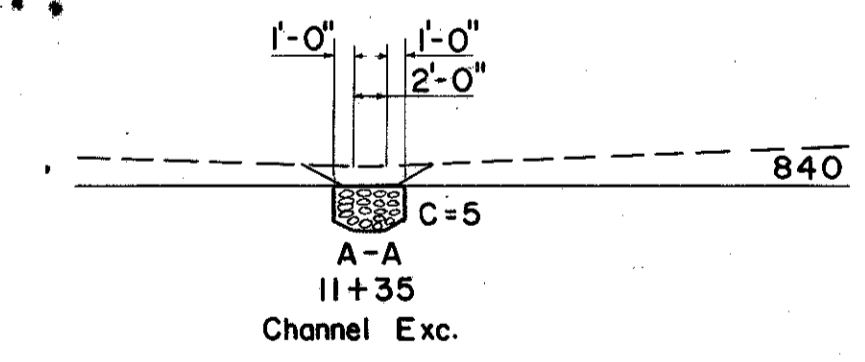

AREA = 60 ACES
 Q50 = 51 C.F.S.

HEADWATER = 50 FT.
 OUTLET VELOCITY = 12.9 F.P.S.

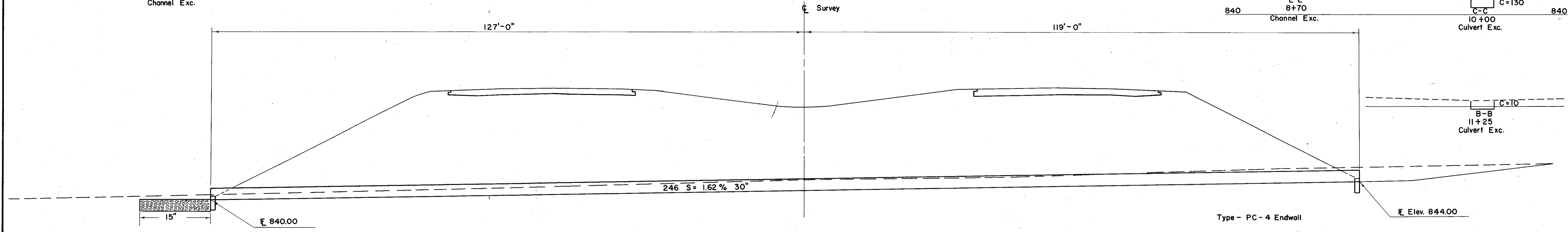
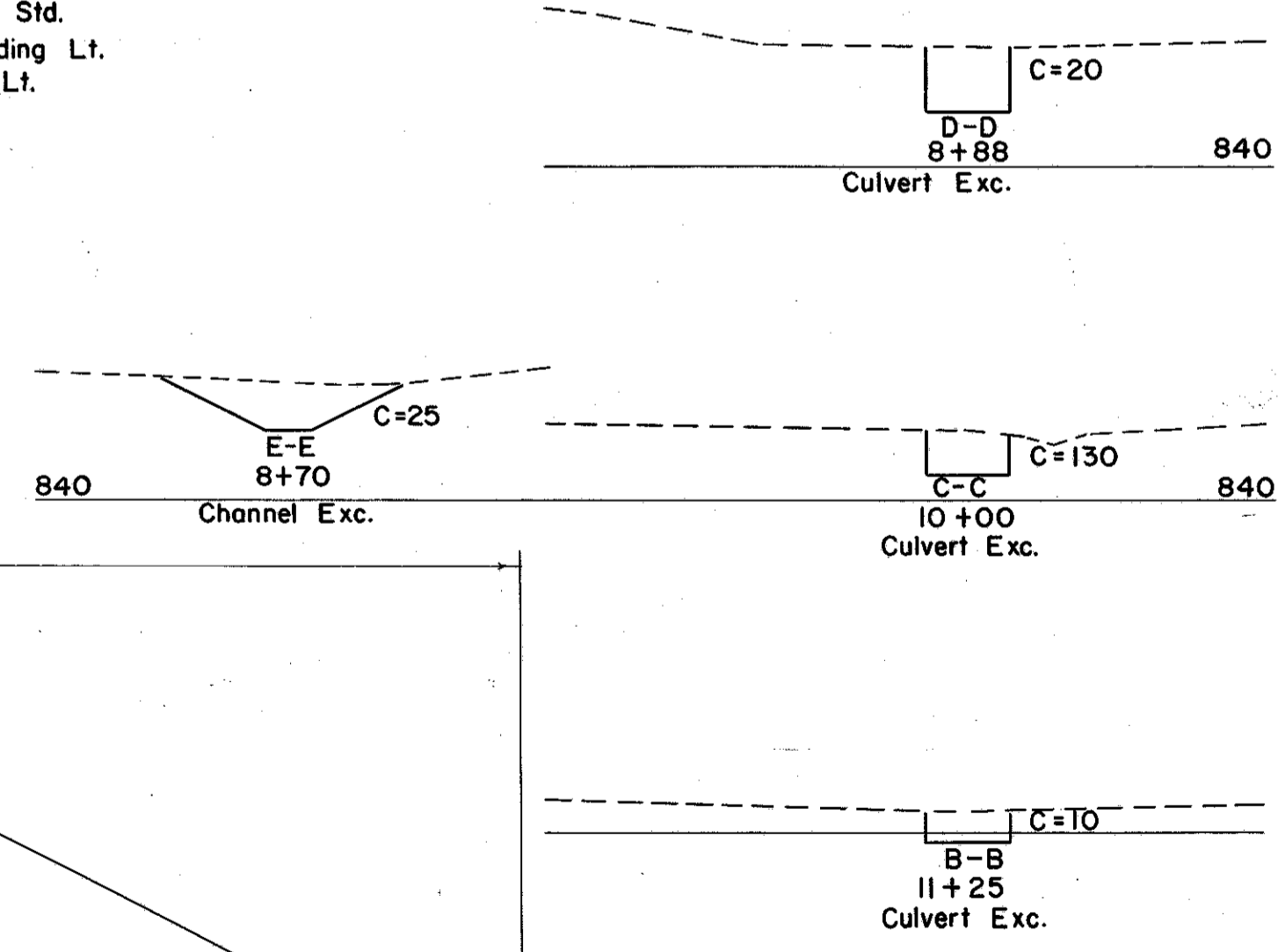

STRUCTURE NO. LAK-I-2141