

LAKE COUNTY
LAK-1-20.03

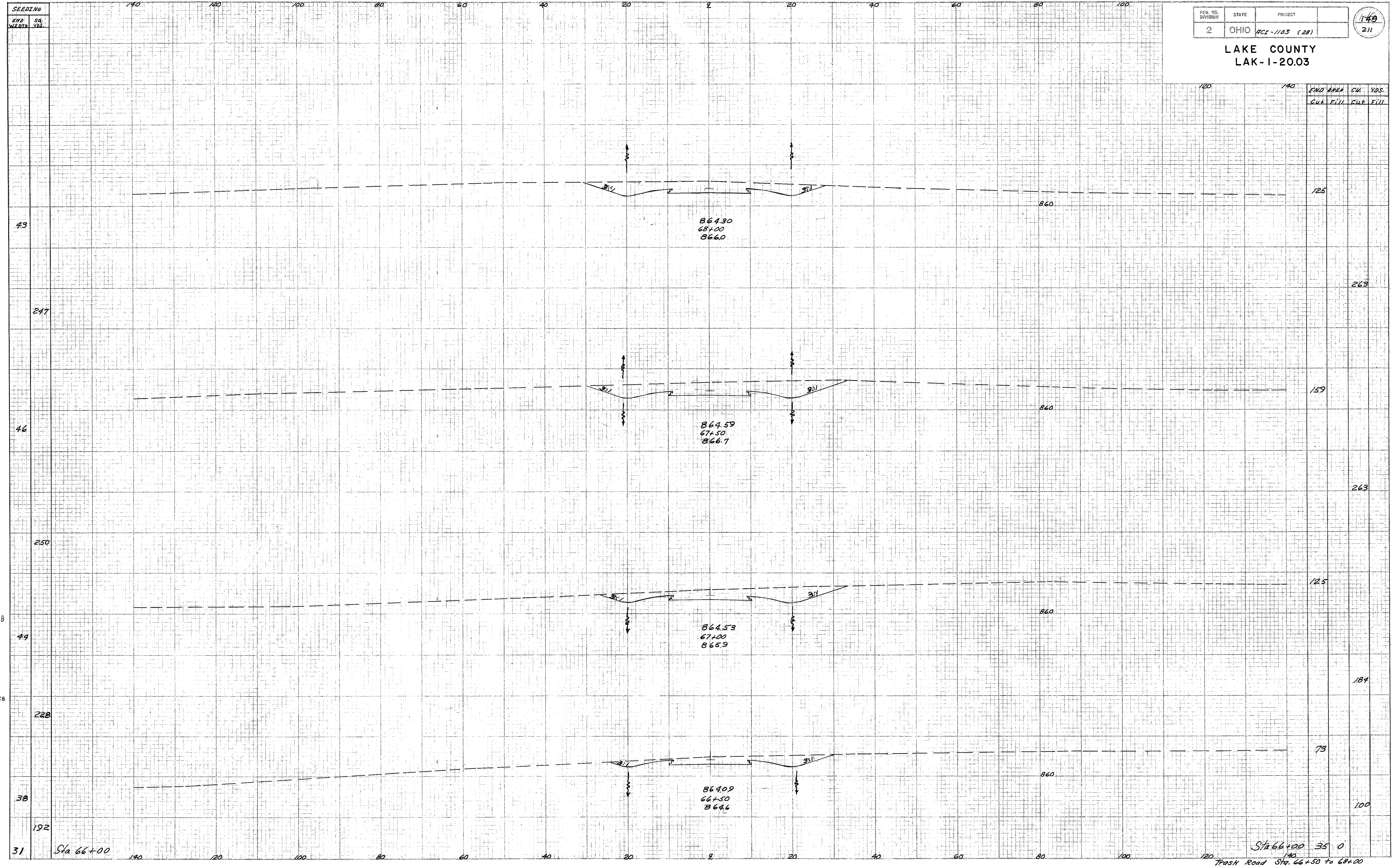

END AREA	CUT	FILL
125		
	263	
159		
	263	
125		
	184	
73		
	100	

Handwritten notes:
 ✓ EEC
 5-7-58
 5-7-58

Revised 4-30-58
 By FGC
 ✓ EEC

Sta 66+00

Sta 66+00 35 0

Trask Road Sta. 66+50 to 68+00