

LAKE COUNTY
LAK-1-20.03

CURVE DATA
 P.I. Sta. 79+13.03
 $\Delta = 18^\circ 29' 17''$ Lt.
 $D = 0^\circ 28' 32''$
 $R = 12,047.67$
 $T = 1,960.80'$
 $L = 3,887.50'$
 $E = 158.52'$

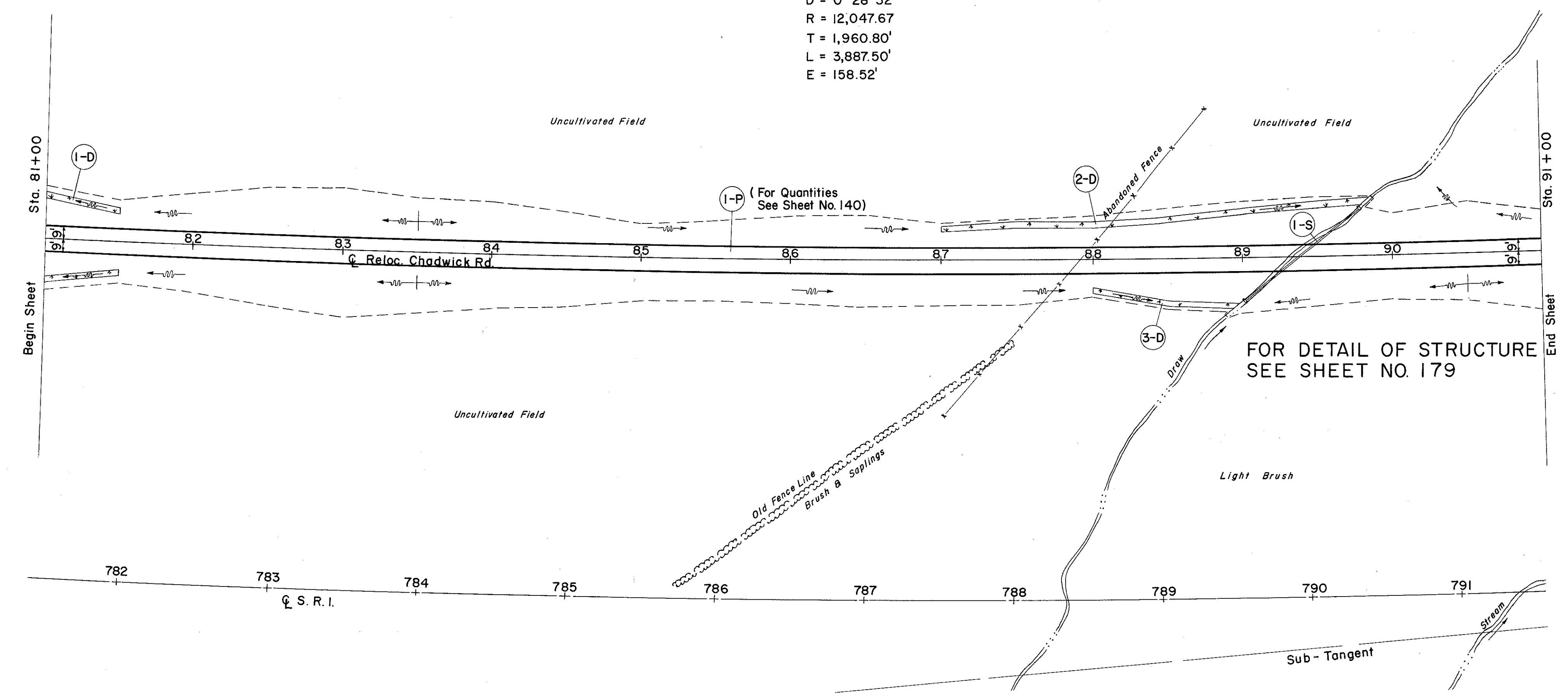

FOR DETAIL OF STRUCTURE
SEE SHEET NO. 179

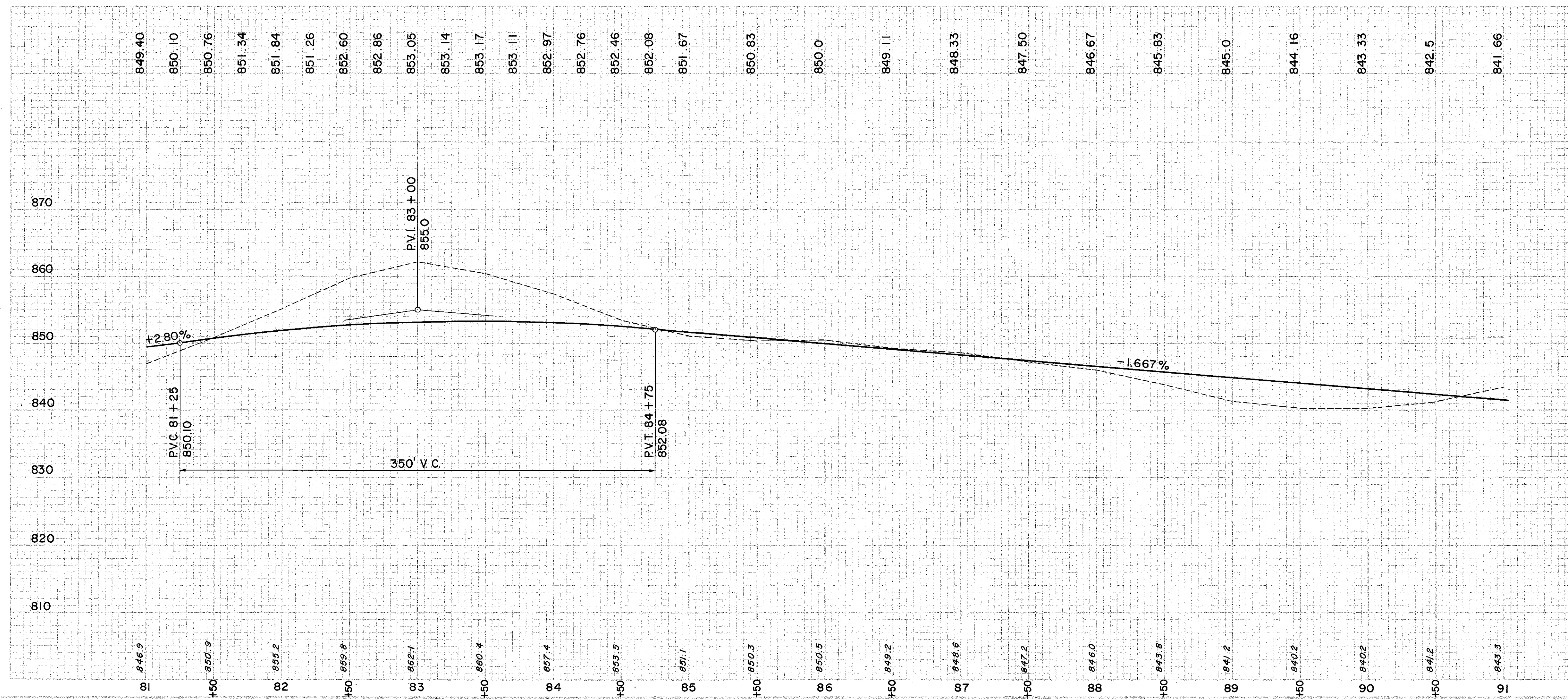

STRUCTURE

REF. NO.	STATION	E-2 SIDE EXCAV. OR STRUCT. C.Y.		L-10 SODDING C.Y.		S-1 CONC. FOR CLASS' CULV. C.Y.		S-27 15" PIPE FOR ROADWAY EXCAV. C.Y.		E-3 CHANNEL EXCAV. C.Y.	
		FROM	TO	S.Y.	L.F.	S.Y.	L.F.	S.Y.	L.F.	S.Y.	L.F.
I-S	89+40			13	13	52	100	100		2	

STATION	DEPTH FT.	SLOPES F. B.	WIDTH FT.	LENGTH FT.	S.Y.
88+00	30	4:1	4.1	100	17
89+00	39	4:1	4.7		
				SUBTOTAL	17
81+00	25	4:1	3.1	53	23
81+50	25	4:1	3.1	4.0	
87+00	35	4:1	4.4	50	25
87+50	30	4:1	4.4	4.4	
89+50	40	4:1	4.4	200	11
89+80	36	4:1	4.4	30	17
				SUBTOTAL	176

REF. NO.	STATION	L-10 SODDING	
		FROM	TO
I-D	81+00	81+50	LT. 23.0
2-D	87+00	89+80	LT. 153.0
3-D	88+00	89+00	RT. 17.0

DRAINAGE

EXCAVATION = 6065 C.Y.
 EMBANKMENT = 826 C.Y.
 EMBANKMENT 22' = 1008 C.Y.