

SEEDING  
END PRER  
WZDR YDS.

2 OHIO ACI-1103 (28)

30  
211

LAKE COUNTY  
LAK-1-20.03

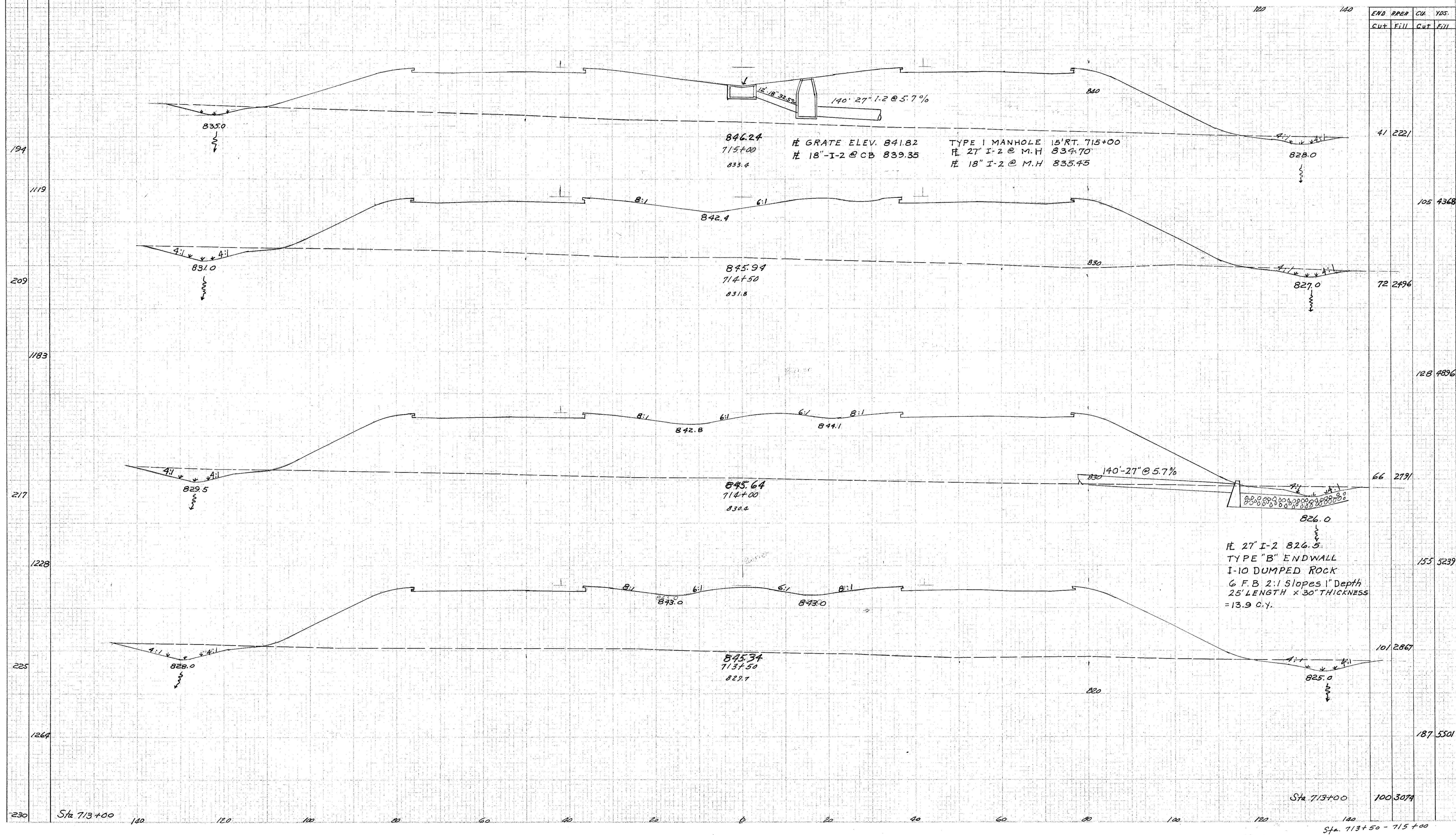

12'-18" @ 5.5%  
140'-27" @ 5.7%

# GRATE ELEV. 841.82  
# 18" I-2 @ CB 839.35

TYPE I MANHOLE 15' RT. 715+00  
# 27" I-2 @ M.H 839.70  
# 18" I-2 @ M.H 835.45

# 27" I-2 826.5  
TYPE "B" ENDWALL  
I-10 DUMPED ROCK  
G.F.B. 2:1 Slopes 1" Depth  
25' LENGTH x 30" THICKNESS  
= 13.9 C.Y.

Sta 713+00

Sta 713+00

Sta 713+50 - 715+00