

LAKE COUNTY  
LAK-1-20.03

Marker to be furnished and erected on the left by the State of Ohio before acceptance of the project.

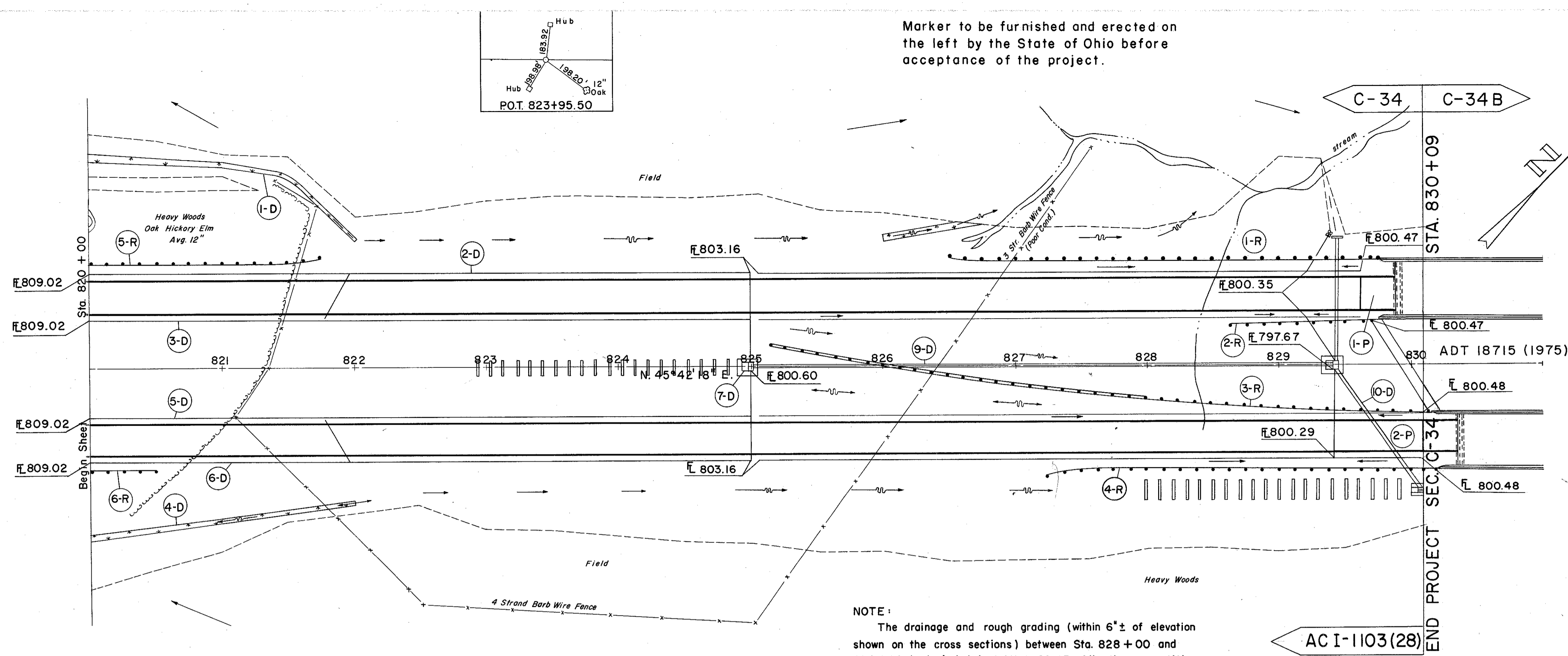
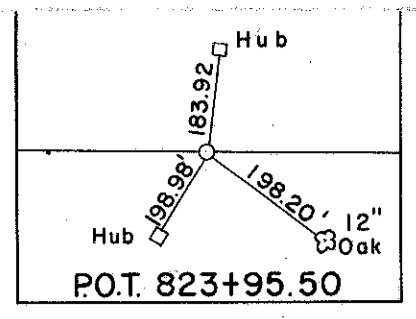

REF NO	STATION	TO	FROM	ROADWAY
1-R	826+50	829+80	826+50	SIDE I-15 GUARD RAIL STEEL
2-R	828+60	829+80	828+60	OR BEAM TYPE (DEEP)
3-R	825+15	830+25	825+15	BEAM TYPE (DEEP)
4-R	827+25	830+25	827+25	BEAM TYPE (DEEP)
5-R	820+00	821+75	820+00	BEAM TYPE (DEEP)
6-R	820+00	820+50	820+00	BEAM TYPE (DEEP)
TOTAL				975 287.5

NOTE:  
The drainage and rough grading (within 6" ± of elevation shown on the cross sections) between Sta. 828+00 and 830+09 is included in LAK-1-22.43. All other quantities, including finished grading, are included in this contract.

B.M. #89A Lag Bolt in 36" Oak  
250' Lt. of Sta. 820+50  
Elev. 789.53

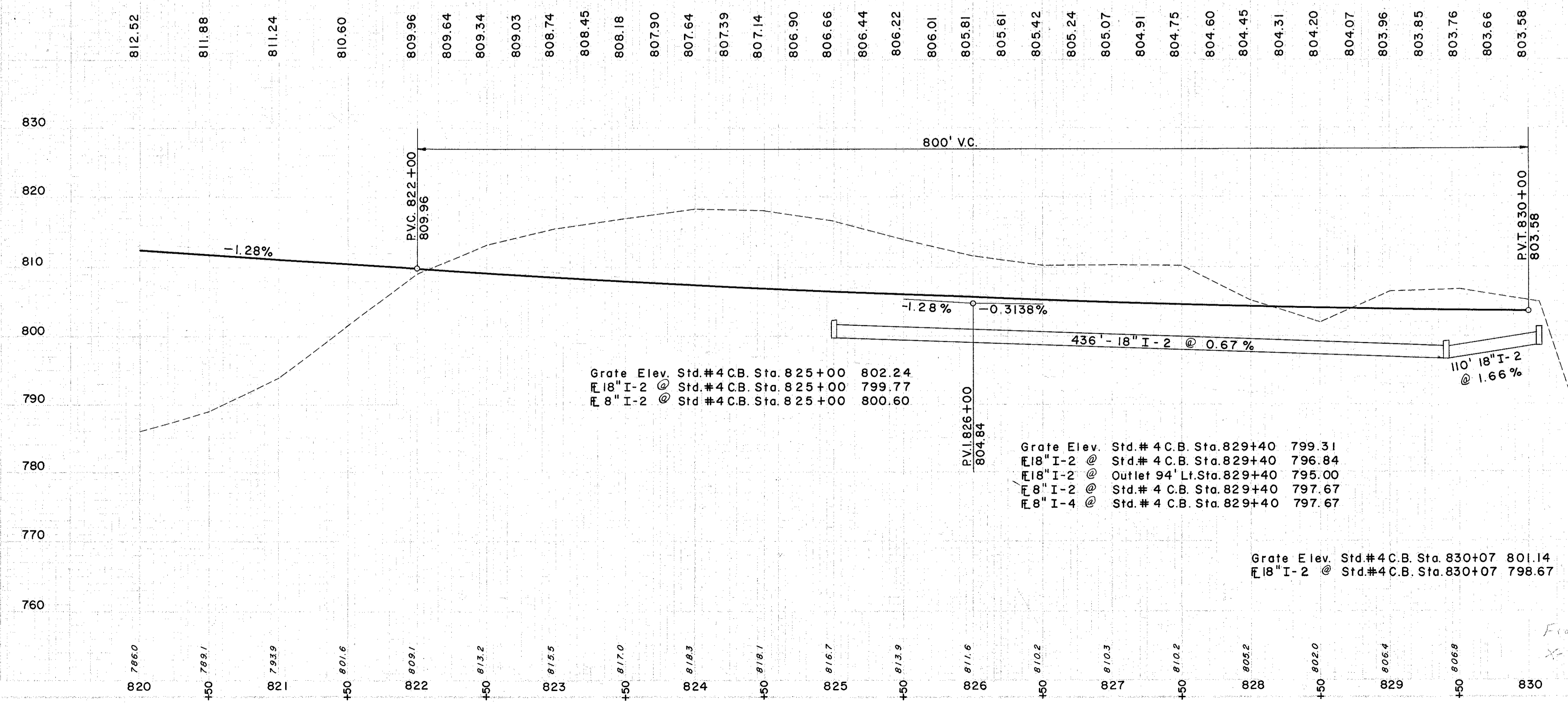

Grate Elev. Std. #4 C.B. Sta. 825+00 802.24  
18" I-2 @ Std. #4 C.B. Sta. 825+00 799.77  
8" I-2 @ Std. #4 C.B. Sta. 825+00 800.60

Grate Elev. Std. #4 C.B. Sta. 829+40 799.31  
18" I-2 @ Std. #4 C.B. Sta. 829+40 796.84  
18" I-2 @ Outlet 94' Lt. Sta. 829+40 795.00  
8" I-2 @ Std. #4 C.B. Sta. 829+40 797.67  
8" I-4 @ Std. #4 C.B. Sta. 829+40 797.67

Grate Elev. Std. #4 C.B. Sta. 830+07 801.14  
18" I-2 @ Std. #4 C.B. Sta. 830+07 798.67

STATION	WIDTH OF SLOPE	RIGHT DITCH	S. Y.
820+00	0.35	4.1	4.8
822+00	0.15	4.1	3.2
SUBTOTAL			8.0
820+00	0.4	4.1	5.0
822+00	0.2	4.1	4.0
826+00	0.35	4.1	5.0
826+50	0.35	4.1	5.0
SUBTOTAL			12.8

REF NO	STATION	TO	FROM	SIDE OR
1-P	829+63	829+88	829+63	6\"/>
2-P	830+09	830+34	830+09	6\"/>
TOTAL				134

REF NO	STATION	TO	FROM	ROADWAY
1-D	820+00	822+00	820+00	SIDE I-15 GUARD RAIL STEEL
2-D	820+00	830+00	820+00	OR BEAM TYPE (DEEP)
3-D	820+00	830+00	820+00	BEAM TYPE (DEEP)
4-D	820+00	822+00	820+00	BEAM TYPE (DEEP)
5-D	820+00	850+00	820+00	BEAM TYPE (DEEP)
6-D	820+00	850+00	820+00	BEAM TYPE (DEEP)
7-D	825+00	826+50	825+00	BEAM TYPE (DEEP)
8-D	825+00	829+40	825+00	BEAM TYPE (DEEP)
9-D	829+40	830+07	829+40	BEAM TYPE (DEEP)
10-D	829+40	830+07	829+40	BEAM TYPE (DEEP)
TOTAL				975 287.5

EXCAVATION	= 42,708 C.Y.
EMBANKMENT	= 20,154 C.Y.
EMBANKMENT + 22 %	= 24,588 C.Y.

\* Quantities to be included in C-34A