

CURVE DATA
P.I. Sta. 764 + 45.19
 $\Delta = 33^\circ 21' 00''$ Lt.
D = $0^\circ 28'$
R = 12277.66'
L = 7146.43'
T = 3677.64'
E = 538.99'

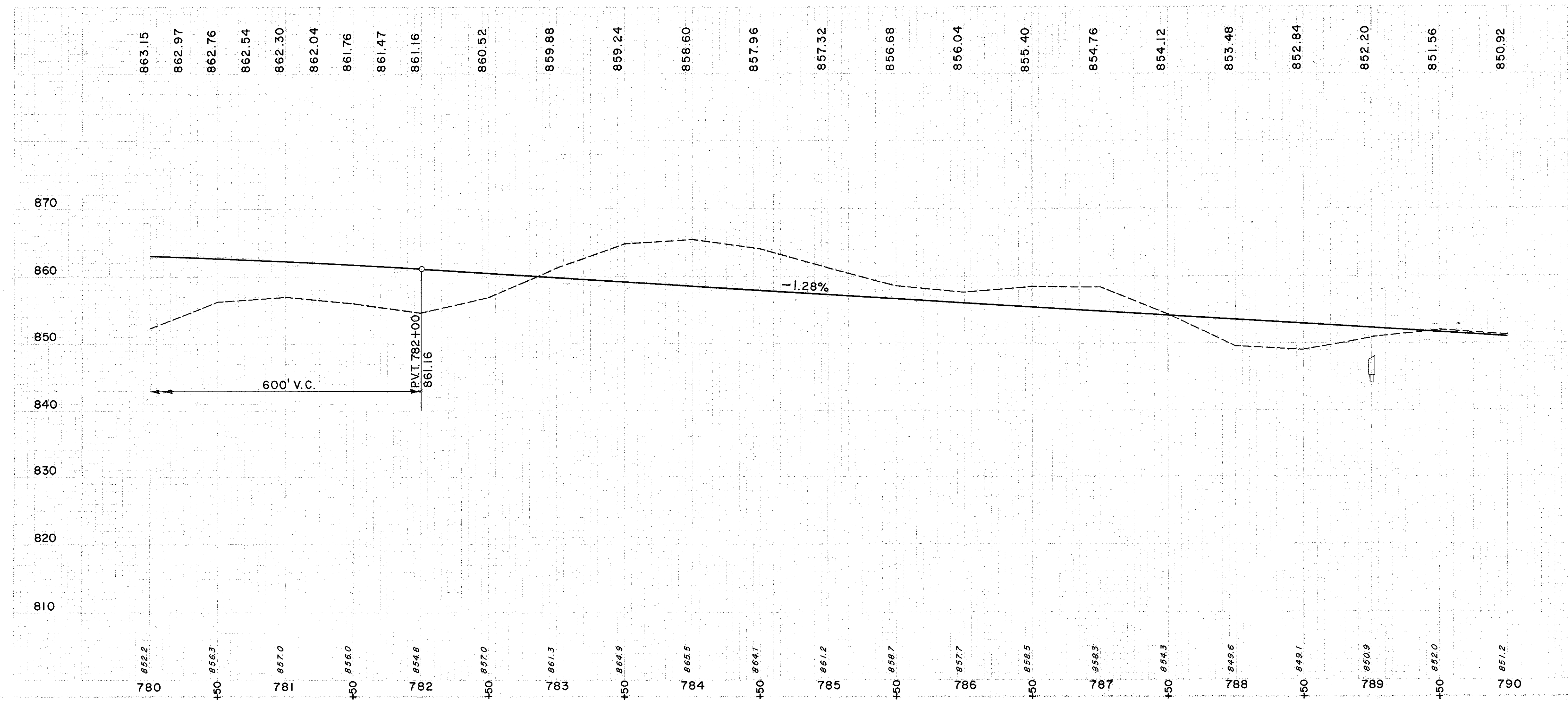
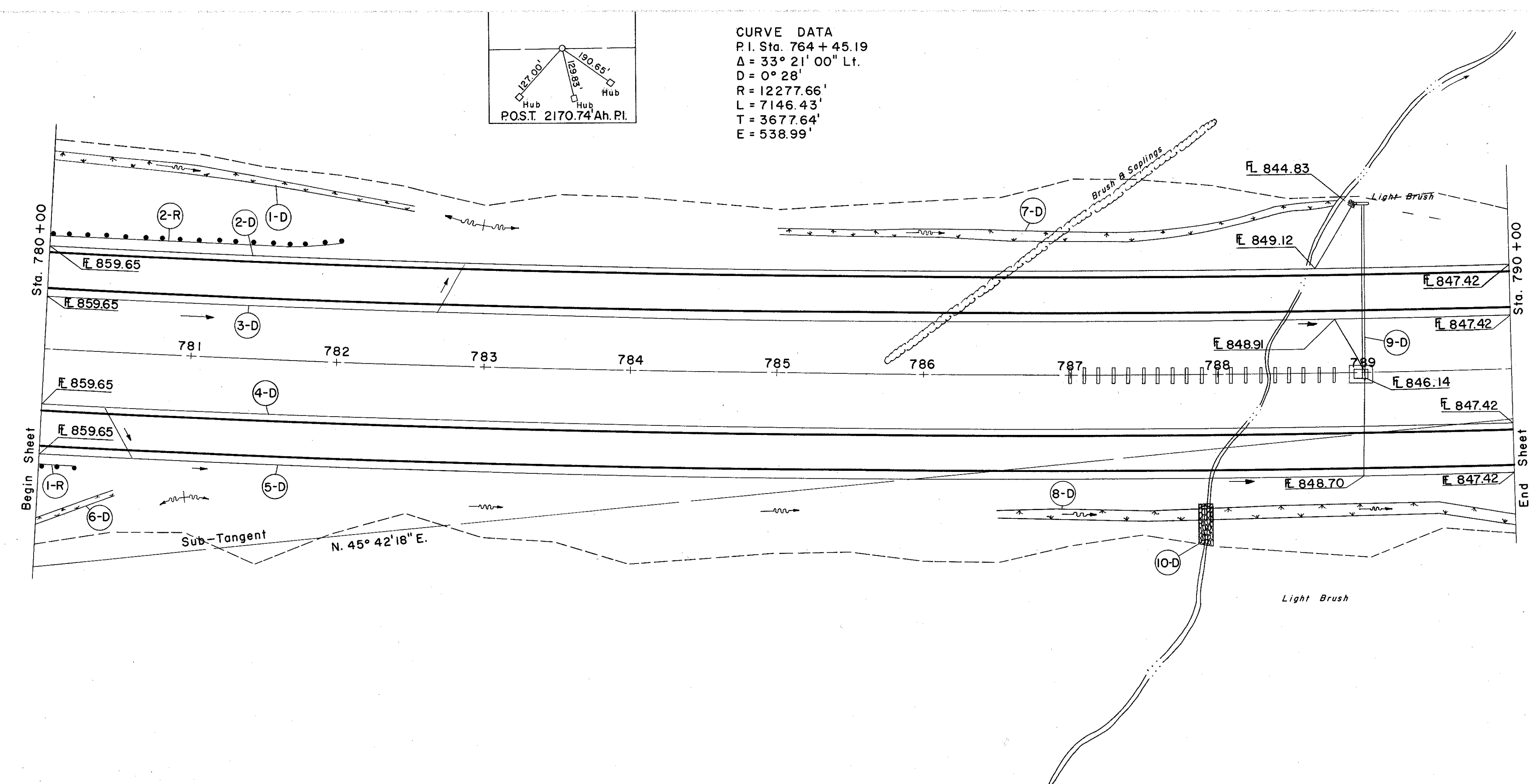

(D) DRAINAGE

REF. NO.	STATION	SIDE OF SODDING	SODDING LEFT DITCH		SODDING RIGHT DITCH		I-2	I-4	I-5	I-8	I-10	S-29	E-2	S-4	S-1
			DEPTH OF SODDING	WIDTH OF SODDING	DEPTH OF SODDING	WIDTH OF SODDING									
1-D	780+00	LT													
2-D	780+00	RT													
3-D	780+00	RT													
4-D	780+00	RT													
5-D	780+00	RT													
6-D	780+00	RT													
7-D	785+50	RT													
8-D	786+50	RT													
9-D	789+00	RT													
10-D	788+00	LT													
		SUBTOTAL		318											
		SODDING LEFT DITCH		350		361									
		SODDING RIGHT DITCH		112											

(E) ROADWAY

REF. NO.	STATION	SIDE	I-15 GUARD RAIL STEEL BEAM TYPE (DEEP) NO. 2-B	
			RT	LT
1-R	780+00	RT	25	200
2-R	780+00	LT	200	225
		TOTAL		225

STATION	DEPTH OF SODDING	SLOPES		LENGTH OF SODDING	S.Y.
		F	B		
780+00	.4	6:1	6:1	6.8	129
782+50	.15	4:1	6:1	3.5	189
785+00	.2	8:1	6:1	4.8	339
788+85	.3	4:1	6:1	5.0	55
		SUBTOTAL		318	
786+50	.5	8:1	6:1	11.0	229
790+00	.4	8:1	6:1	9.6	146

EXCAVATION = 23,790 C.Y.
EMBANKMENT = 10,083 C.Y.
EMBANKMENT + 22% = 12,301 C.Y.