

LAKE COUNTY
LAK-I-20.03

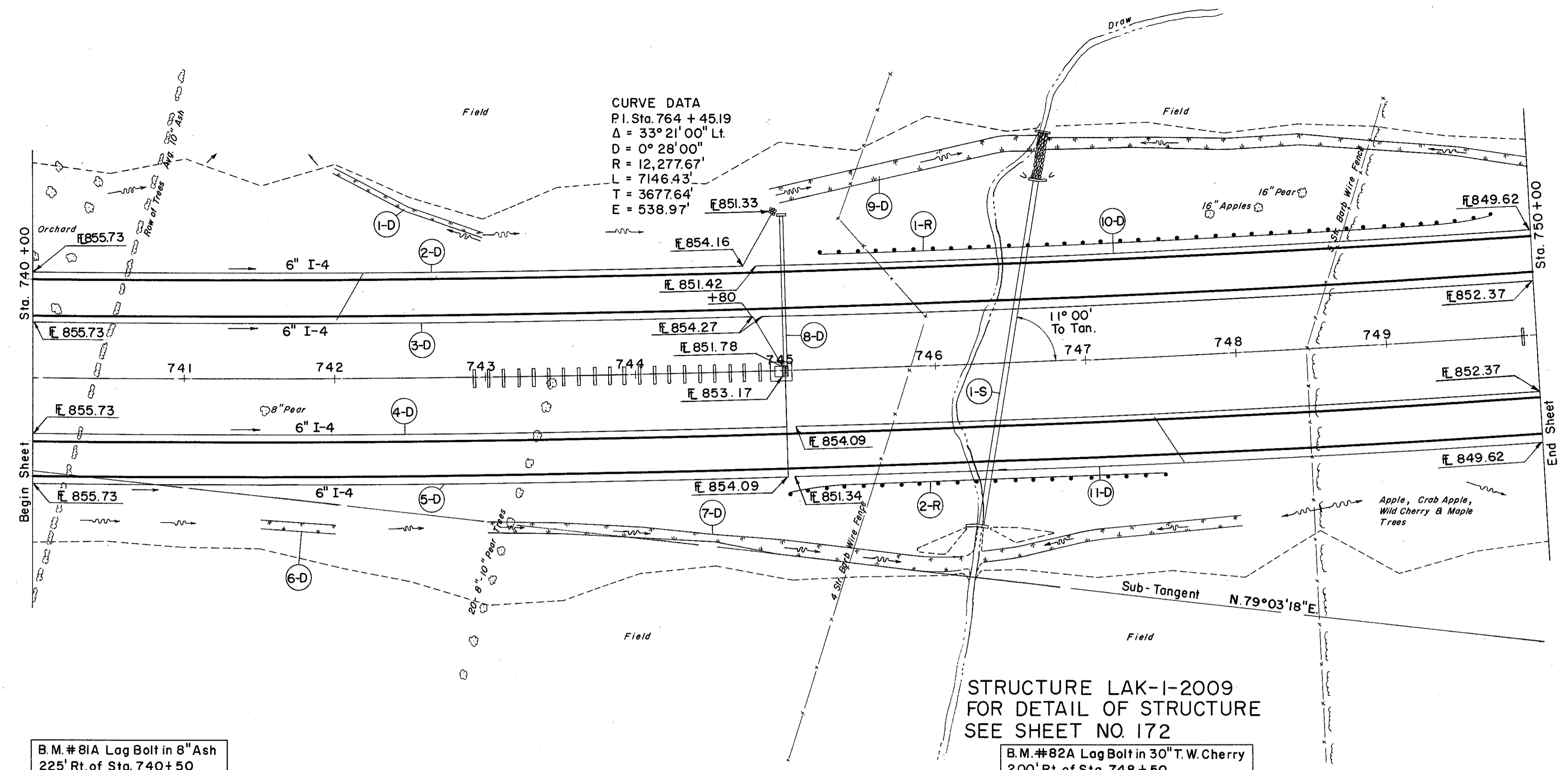

B.M. #81A Log Bolt in 8" Ash
225' Rt. of Sta. 740 + 50
Elev. 863.02

B.M. #82A Log Bolt in 30" T.W. Cherry
200' Rt. of Sta. 748 + 50
Elev. 858.63

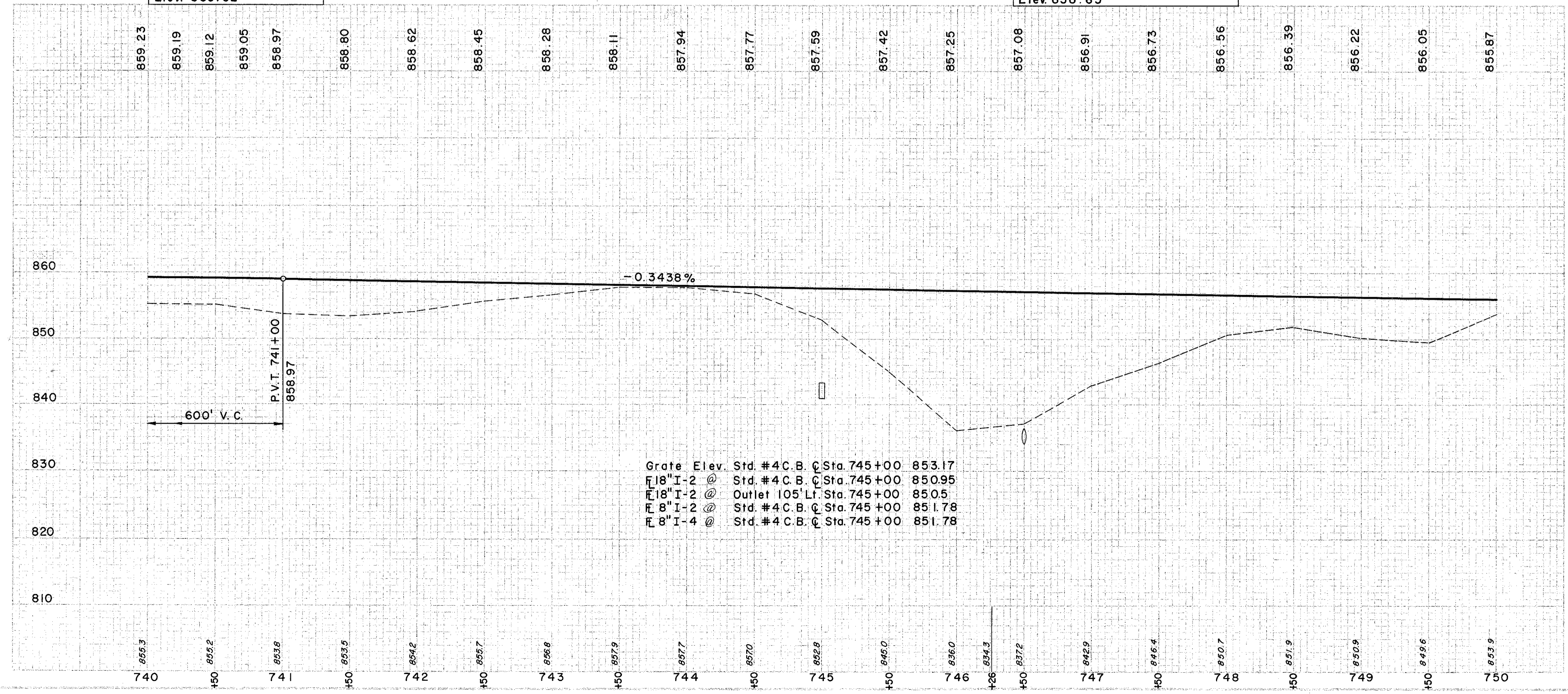

| | | | |
|-------------|-----------------|-------------|--------|
| Grate Elev. | Std. #4 C.B. | Sta. 745+00 | 853.17 |
| 18" I-2 | Std. #4 C.B. | Sta. 745+00 | 850.95 |
| 18" I-2 | Outlet 105' Lt. | Sta. 745+00 | 850.5 |
| 8" I-2 | Std. #4 C.B. | Sta. 745+00 | 851.78 |
| 8" I-4 | Std. #4 C.B. | Sta. 745+00 | 851.78 |

① DRAINAGE

| REF NO. | STATION | SIDE OR | SLOPES | | I-2 | I-4 | I-5 | I-8 | I-10 | E-2 | E-3 | I-10 | S-1 | S-4 | S-29 |
|---------|---------|---------|--------|-------|-----|------|-----|-------------------|------|------|-----|------|------|------|------|
| | | | WIDTH | DEPTH | | | | | | | | | | | |
| I-D | 742+00 | LT. | 6.1 | 0.5 | 10 | 538 | 6" | 6"x6" INCR. TEE | 50 | 50 | 7 | 24 | 22.4 | 1080 | 0.3 |
| 2-D | 740+00 | LT. | 6.1 | 0.6 | 10 | 1027 | 6" | 6"x8" CATCH BASIN | 44 | 44 | 7 | 24 | 22.4 | 1080 | 0.3 |
| 3-D | 740+00 | LT. | 6.1 | 0.6 | 10 | 996 | 6" | 6"x8" CATCH BASIN | 56.6 | 56.6 | 7 | 24 | 22.4 | 1080 | 0.3 |
| 4-D | 740+00 | RT. | 6.1 | 0.5 | 10 | 500 | 6" | 6"x8" CATCH BASIN | 249 | 249 | 7 | 24 | 22.4 | 1080 | 0.3 |
| 5-D | 740+00 | RT. | 6.1 | 0.4 | 10 | 103 | 6" | 6"x8" CATCH BASIN | 450 | 450 | 7 | 24 | 22.4 | 1080 | 0.3 |
| 6-D | 741+50 | RT. | 6.1 | 0.4 | 10 | 524 | 6" | 6"x8" CATCH BASIN | 250 | 250 | 7 | 24 | 22.4 | 1080 | 0.3 |
| 7-D | 743+00 | RT. | 6.1 | 0.4 | 10 | 532 | 6" | 6"x8" CATCH BASIN | 700 | 700 | 7 | 24 | 22.4 | 1080 | 0.3 |
| 8-D | 745+00 | LT. | 6.1 | 0.4 | 10 | 524 | 6" | 6"x8" CATCH BASIN | 700 | 700 | 7 | 24 | 22.4 | 1080 | 0.3 |
| 9-D | 745+00 | LT. | 6.1 | 0.4 | 10 | 532 | 6" | 6"x8" CATCH BASIN | 700 | 700 | 7 | 24 | 22.4 | 1080 | 0.3 |
| 10-D | 744+76 | LT. | 6.1 | 0.4 | 10 | 532 | 6" | 6"x8" CATCH BASIN | 700 | 700 | 7 | 24 | 22.4 | 1080 | 0.3 |
| 11-D | 745+04 | RT. | 6.1 | 0.4 | 10 | 532 | 6" | 6"x8" CATCH BASIN | 700 | 700 | 7 | 24 | 22.4 | 1080 | 0.3 |

ROADWAY

| REF NO. | STATION | SIDE OR | SLOPES | | I-15 | I-10 | E-2 | E-3 | I-10 | S-1 | S-4 |
|---------|---------|---------|--------|-------|------|------|-----|-----|------|------|-----|
| | | | WIDTH | DEPTH | | | | | | | |
| I-S | 746+49 | RT. | 6.1 | 0.2 | 180 | 180 | 7 | 24 | 22.4 | 1080 | 244 |
| TOTAL | | | | | 180 | 180 | 7 | 24 | 22.4 | 1080 | 244 |

SODDING RIGHT DITCH

| STATION | DEPTH | WIDTH | LENGTH | AREA | S.Y. |
|----------|-------|-------|--------|------|------|
| 741+50 | 0.5 | 8.0 | 50 | 44 | 44 |
| 743+00 | 0.6 | 8.0 | 150 | 142 | 142 |
| 744+50 | 0.5 | 8.0 | 50 | 39 | 39 |
| 745+00 | 0.4 | 5.0 | 120 | 67 | |
| 746+25 | 0.4 | 5.0 | 175 | 97 | 97 |
| 748+00 | 0.4 | 5.0 | 358 | 358 | 358 |
| SUBTOTAL | | | | | 6939 |

Excavation = 6,939 C.Y.
 Embankment = 41,370 C.Y.
 Embankment @ 22' = 50,471 C.Y.