

LAKE COUNTY
LAK-1-20.03

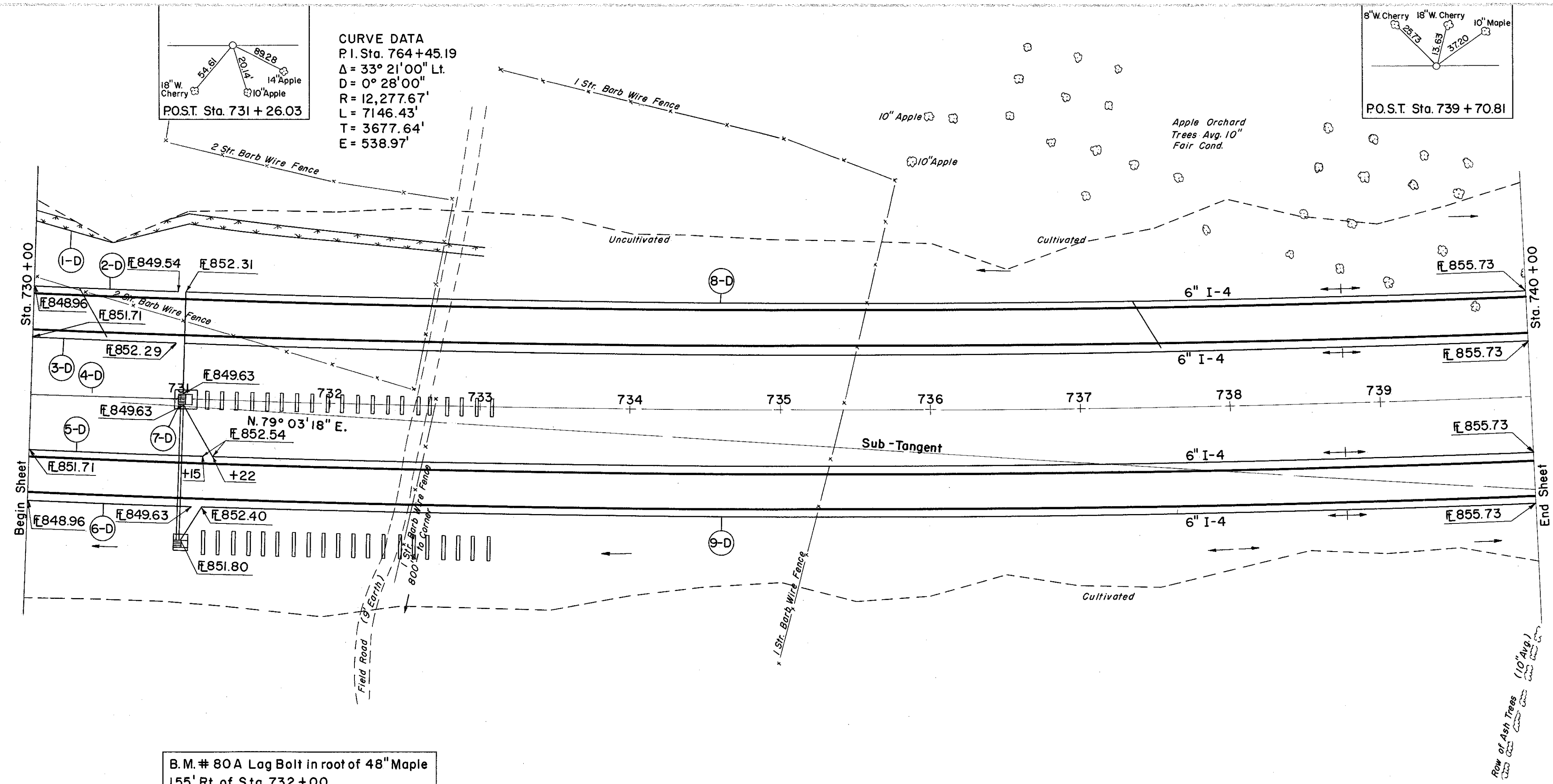

B.M. # 80A Lag Bolt in root of 48" Maple
155' Rt. of Sta. 732+00
Elev. 861.63

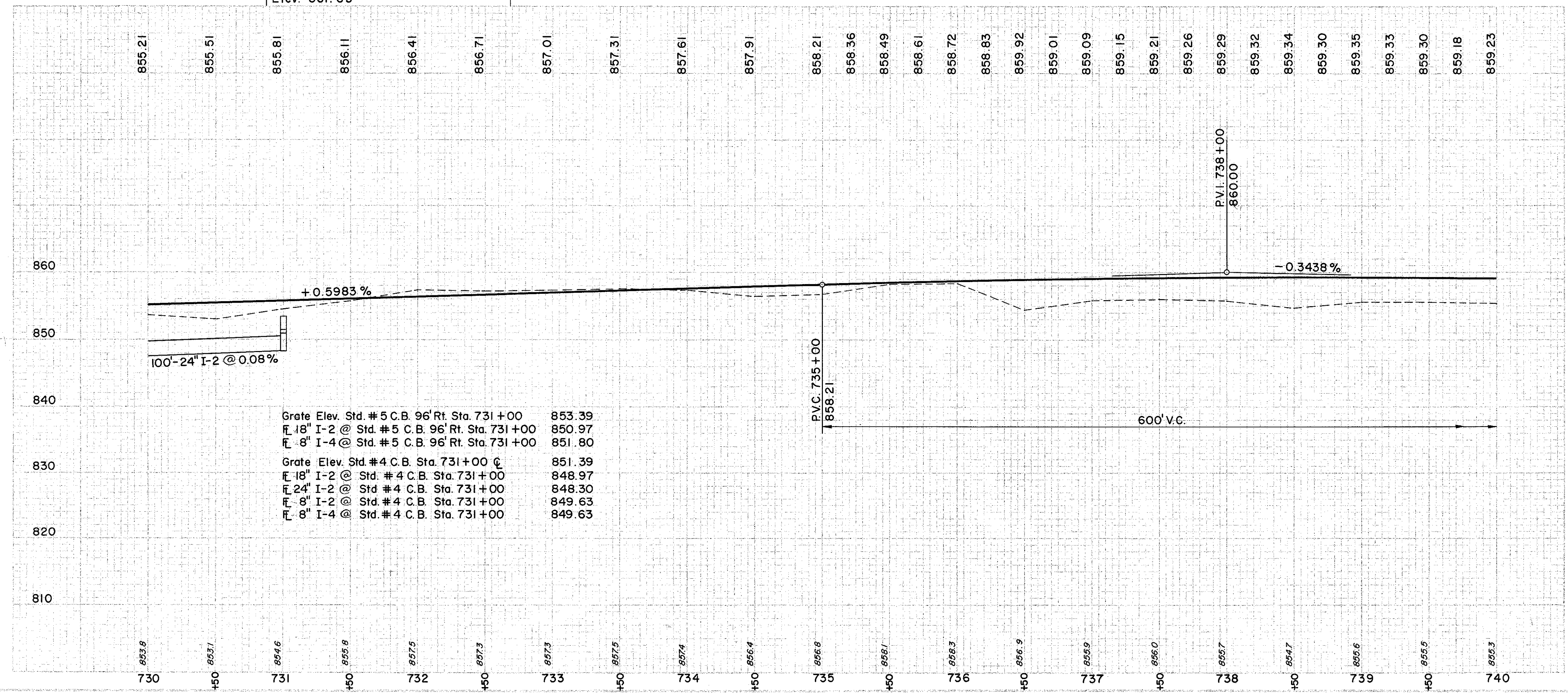

Grate Elev. Std. # 5 C.B. 96' Rt. Sta. 731+00	853.39
℄ 18" I-2 @ Std. # 5 C.B. 96' Rt. Sta. 731+00	850.97
℄ 8" I-4 @ Std. # 5 C.B. 96' Rt. Sta. 731+00	851.80
Grate Elev. Std. # 4 C.B. Sta. 731+00	851.39
℄ 18" I-2 @ Std. # 4 C.B. Sta. 731+00	848.97
℄ 24" I-2 @ Std. # 4 C.B. Sta. 731+00	848.30
℄ 8" I-2 @ Std. # 4 C.B. Sta. 731+00	849.63
℄ 8" I-4 @ Std. # 4 C.B. Sta. 731+00	849.63

④ DRAINAGE

REF. NO.	STATION	SIDE OR		I-2		I-4		I-5		I-8		I-10	
		FROM	TO	C.M.P. OUTLET PIPE	CL.A STORM SEWER UNDER PAVT. SEC.	CL.A STORM SEWER UNDER PAVT. SEC.	CL.A STORM SEWER UNDER PAVT. SEC.	CL.A STORM SEWER UNDER PAVT. SEC.	CL.A STORM SEWER UNDER PAVT. SEC.	CL.A STORM SEWER UNDER PAVT. SEC.	CL.A STORM SEWER UNDER PAVT. SEC.	CL.A STORM SEWER UNDER PAVT. SEC.	CL.A STORM SEWER UNDER PAVT. SEC.
1-D	730+00	733+00	LT	8"	8"	8"	8"	6"	6"	6"	6"	6"	6"
2-D	730+00	730+96	LT	10	24	96	132	6" x 8" INCREASER	6" x 8" x 8" TEE	6"	6"	6"	6"
3-D	730+00	740+00	LT	10	24	96	1027	6"	6"	6"	6"	6"	6"
4-D	730+00	731+00	RT	10	24	96	111	6"	6"	6"	6"	6"	6"
5-D	730+00	740+00	RT	10	24	96	936	6"	6"	6"	6"	6"	6"
6-D	730+00	731+11	RT	10	24	96	901	6"	6"	6"	6"	6"	6"
7-D	731+00	731+11	RT	10	24	96	901	6"	6"	6"	6"	6"	6"
8-D	731+00	740+00	LT	10	24	96	901	6"	6"	6"	6"	6"	6"
9-D	731+00	740+00	RT	10	24	96	901	6"	6"	6"	6"	6"	6"

STATION	SLOPES		SODDING		S.Y.
	DEPTH OF SLOPES	WIDTH OF SODDING	LENGTH	LENGTH	
730+00	0.4	6.1	7	50	19
730+50	0.0	4.1	0	50	12.5
731+00	0.3	4.1	4.5	200	100
733+00	0.3	4.1	4.5	200	131.5

EXCAVATION	10,424 C.Y.
EMBANKMENT	8,388 C.Y.
EMBANKMENT + 22'	10,233 C.Y.