

LAKE COUNTY
LAK-1-2003

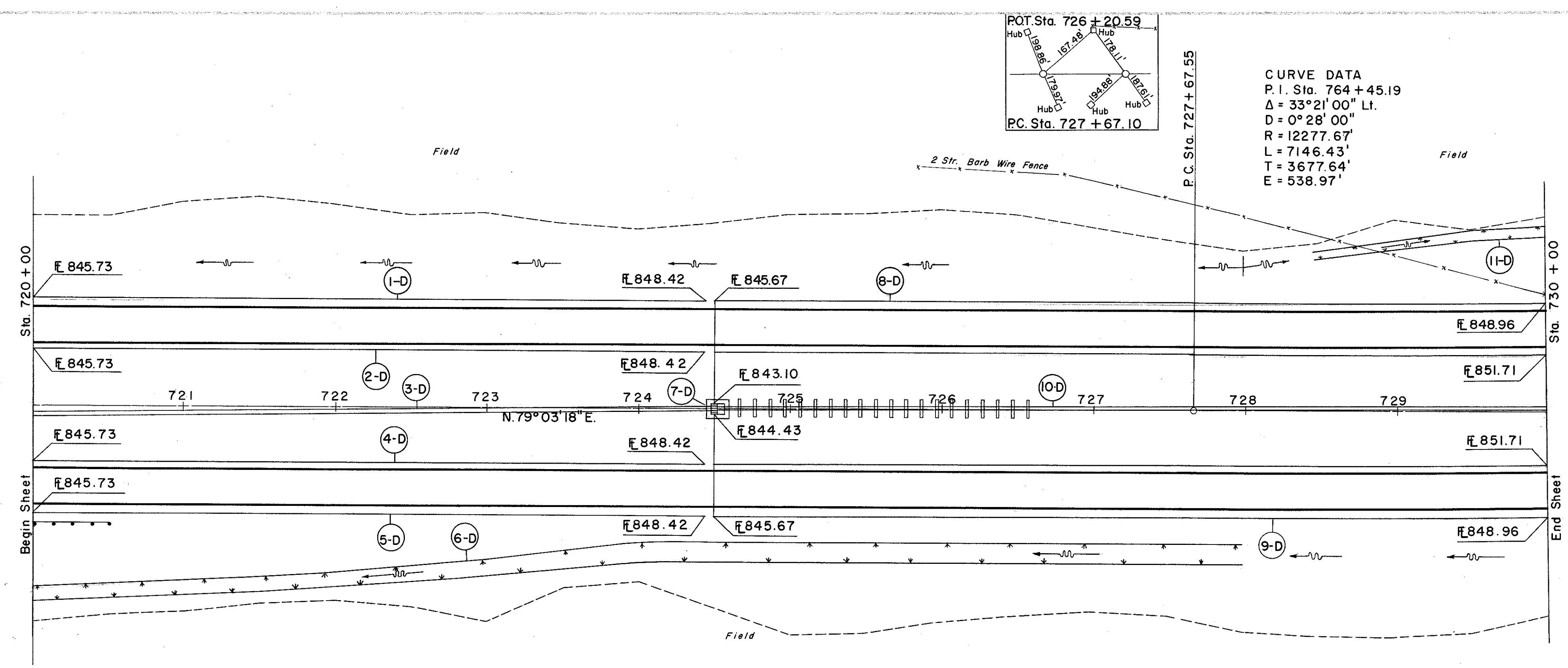

B.M. # 79A Lag Bolt in root of 24" Maple
160' Lt. of Sta. 720+00
Elev. 856.86

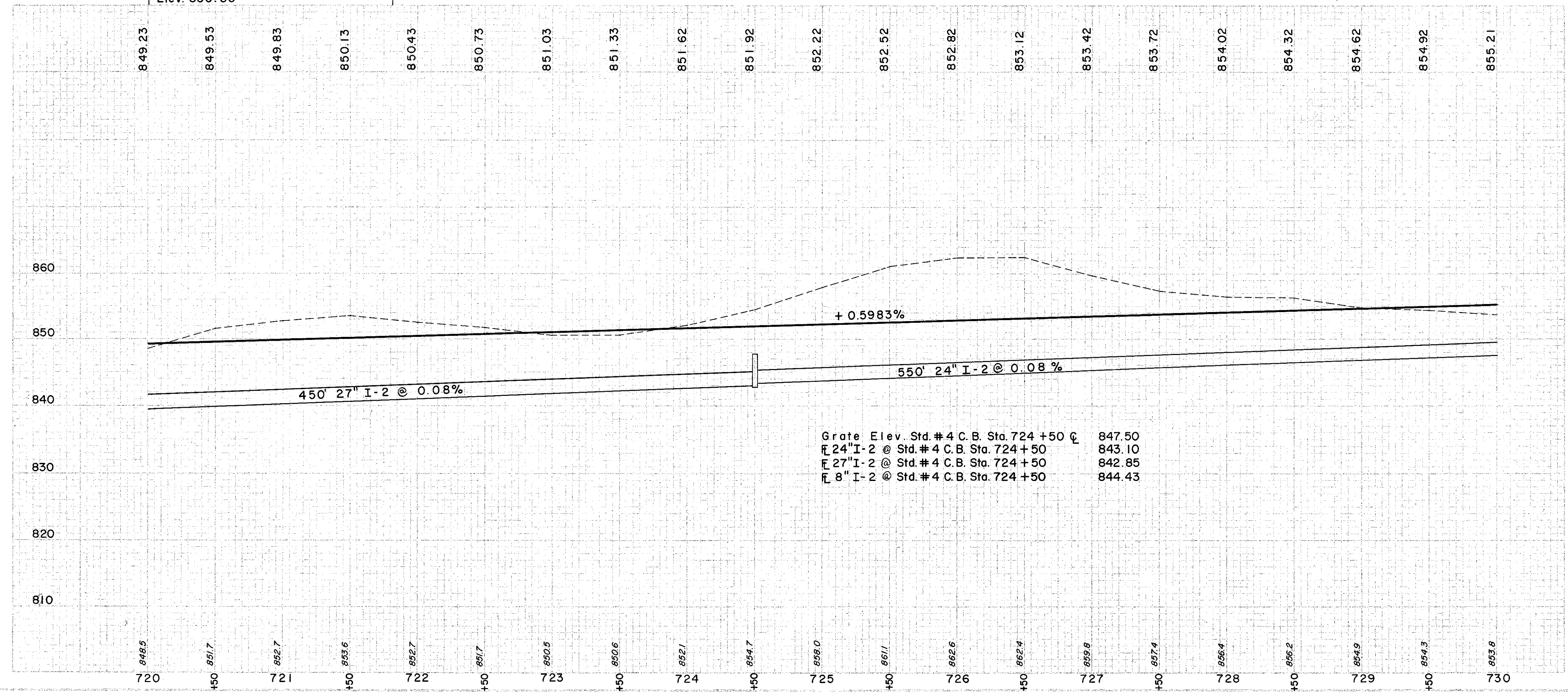

④ DRAINAGE

REF NO.	STATION	SIDE OR	I-2		I-4		I-5		I-8		L-10	
			FROM	TO	FROM	TO	FROM	TO	FROM	TO	FROM	TO
1-D	720+00	RT	446	446								
2-D	720+00	LT	10	24								
3-D	720+00	RT	448	448								
4-D	720+00	RT	10	24								
5-D	720+00	RT	446	446								
6-D	720+00	RT	32	32								
7-D	724+50	LT	32	32								
8-D	724+50	RT	548	548								
9-D	724+50	RT										
10-D	724+50	LT										
11-D	728+50	LT										
			SUBTOTAL		SUBTOTAL		SUBTOTAL		SUBTOTAL		SUBTOTAL	
			944		944		944		944		944	
			100		100		100		100		100	

STATION	SODDING RIGHT DITCH		SODDING LEFT DITCH	
	DEPTH OF SLOPES	WIDTH OF SODDING	DEPTH OF SLOPES	WIDTH OF SODDING
720+00	0.5	4.1	0.4	3.5
723+50	0.4	8.1	0.6	2.5
728+00	0.6	8.1	0.6	2.0
728+00	0.6	8.1	0.6	12.5
		SUBTOTAL		944
728+50	0.25	6.1	0.5	1.5
730+00	0.4	6.1	0.7	1.0
		SUBTOTAL		100

EXCAVATION	37,575 C.Y.
EMBANKMENT	1,898 C.Y.
EMBANKMENT	2,316 C.Y.