

LAKE COUNTY
LAK-1-2.16

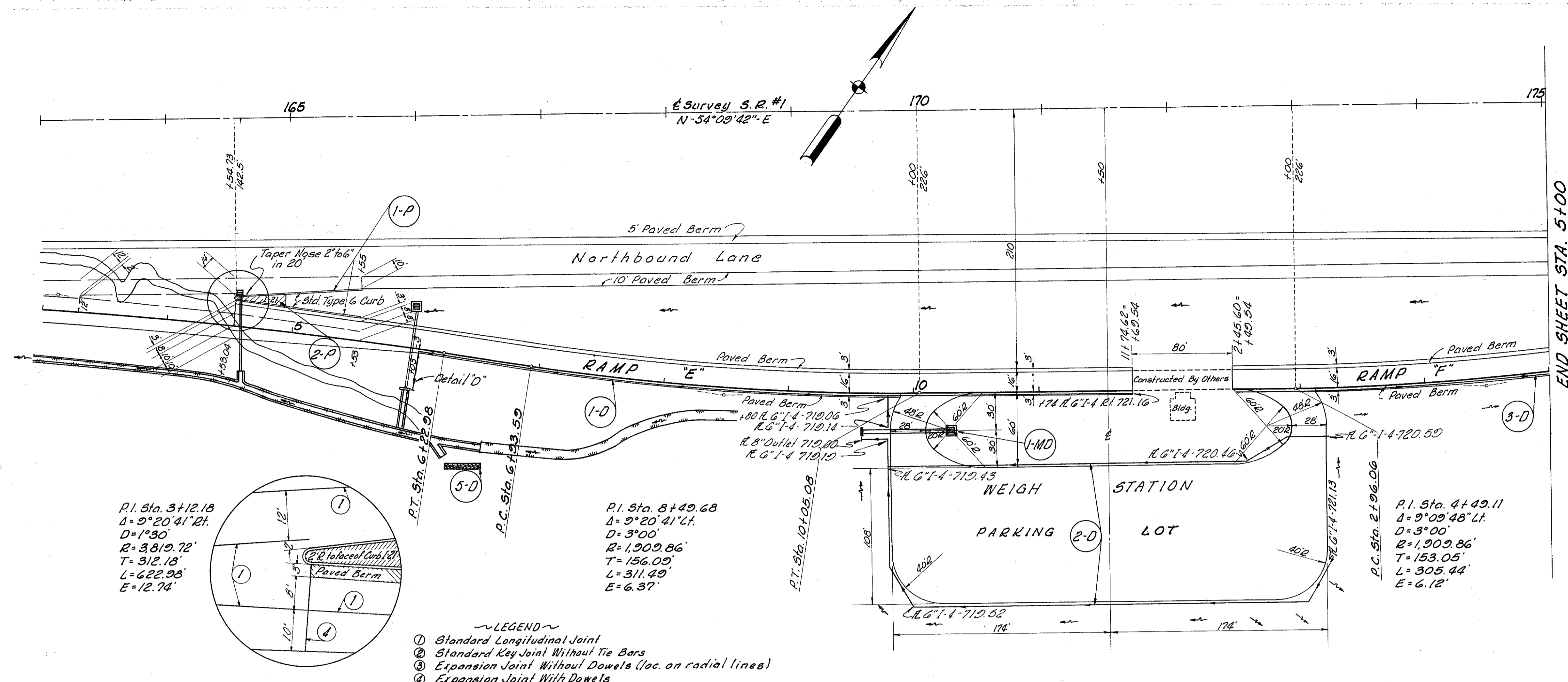

P.I. Sta. 3+12.18
Δ = 9°20'41" Lt.
D = 1°30'
R = 3819.72'
T = 312.18'
L = 622.95'
E = 12.74'

P.I. Sta. 8+49.68
Δ = 9°20'41" Lt.
D = 3°00'
R = 1909.86'
T = 156.09'
L = 311.49'
E = 6.37'

P.I. Sta. 4+49.11
Δ = 9°09'48" Lt.
D = 3°00'
R = 1909.86'
T = 153.05'
L = 305.44'
E = 6.12'

- ~LEGEND~
- ① Standard Longitudinal Joint
 - ② Standard Key Joint Without Tie Bars
 - ③ Expansion Joint Without Dowels (loc. on radial lines)
 - ④ Expansion Joint With Dowels

ROADWAY & PAVEMENT					
Ref. No.	Station		Side E	I-12	I-21
	From	To		Concrete Curb Type & Lin. Ft.	Conc. Med. Pavement Type & Lin. Ft.
1-P	4+51.04	5+55	Lt.	206.28	
2-P	4+51.54	4+92	Lt.		28
Totals				206.28	28

See Sheet No.	Ref. No.	From	To	Station		Side	I-5 Pipe Specials		I-4	I-4	I-2	I-2	I-2	I-2	I-2	I-2	I-2	I-2	I-2
				From	To		Under-drain Sec. M-G (M)	Bands											
105	1-MD	10+00	10+10	10+10	11+74	Rt.	1	1	10	10	10	10	10	10	10	10	10	10	10
206	2-D	0+100	0+120	0+120	0+120	Rt.	1	1	10	10	10	10	10	10	10	10	10	10	10
3-D	3-D	0+120	0+120	0+120	0+120	Rt.	1	1	10	10	10	10	10	10	10	10	10	10	10
5-D	5-D	0+120	0+120	0+120	0+120	Rt.	1	1	10	10	10	10	10	10	10	10	10	10	10
				Totals			1	1	10	10	10	10	10	10	10	10	10	10	10

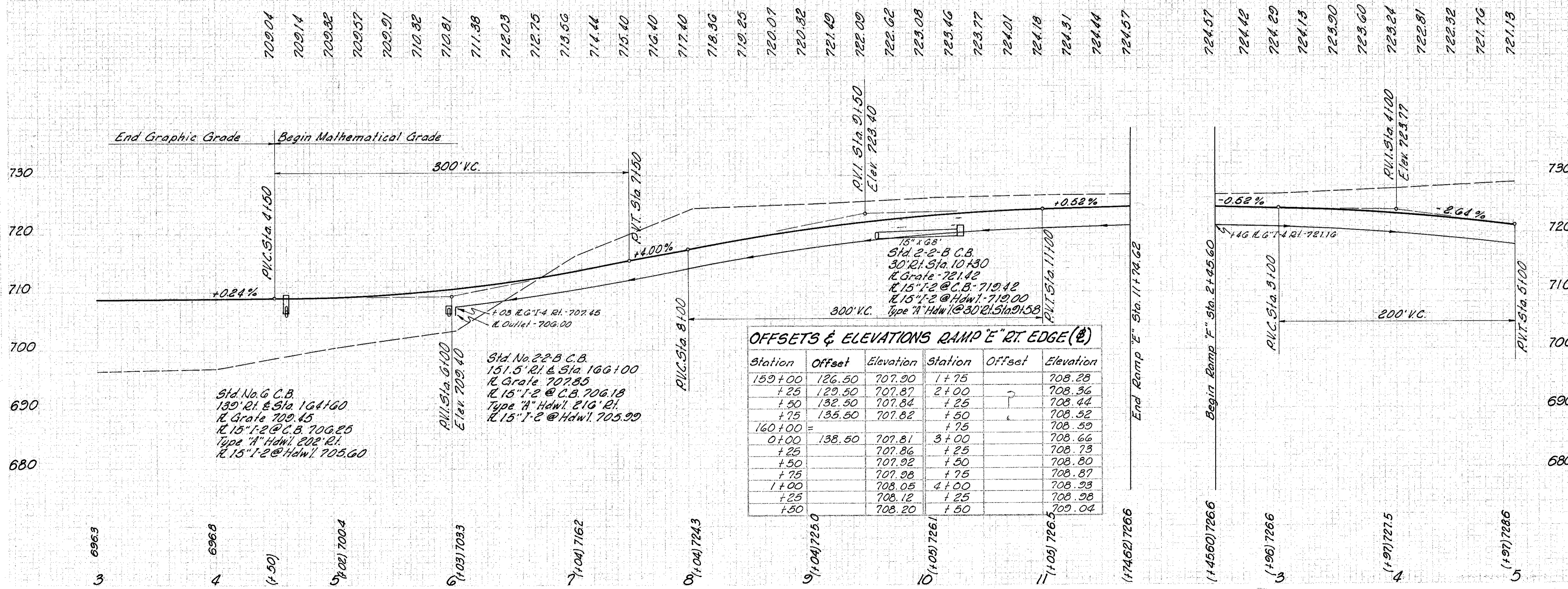

Station	Offset	Elevation	Station	Offset	Elevation
159+00	126.50	707.90	1+75		708.28
+25	129.50	707.87	2+00		708.36
+50	132.50	707.84	+25		708.44
+75	135.50	707.82	+50		708.52
160+00			+75		708.59
0+00	138.50	707.81	3+00		708.66
+25	707.86	+25			708.73
+50	707.92	+50			708.80
+75	707.98	+75			708.87
1+00	708.05	4+00			708.93
+25	708.12	+25			708.98
+50	708.20	+50			709.04

MICHAEL BAKER JR., CONSULTING ENGINEERS
ROCHESTER, PENNSYLVANIA

STATE OF OHIO
DEPARTMENT OF HIGHWAYS
STATE HIGHWAY NO. 1
C-43
WEIGH STATION
RAMP "E" STA. 3+00 TO STA. 11+74.62
RAMP "F" STA. 2+45.60 TO STA. 5+00

Designed	Drawn	Traced	Checked	Reviewed	Date	Revised
H.v.v.	J.A.H.	A.L.H.	B.P.			