

LAKE COUNTY
LAK 1-2.16

Lt. Edge Pav't		Rt. Edge Pav't	
Δ = 25°55'00"	D = 4°15'	Δ = 25°03'05"	D = 5°
R = 1348.14'	T = 285.56'	R = 1145.92'	T = 254.58'
L = 562.80'	E = 29.91'	L = 501.03'	E = 27.94'
PC Opp. 11+81.36	PT Opp. 16+86.91	PC Opp. 10+92.58	PT Opp. 16+00.61

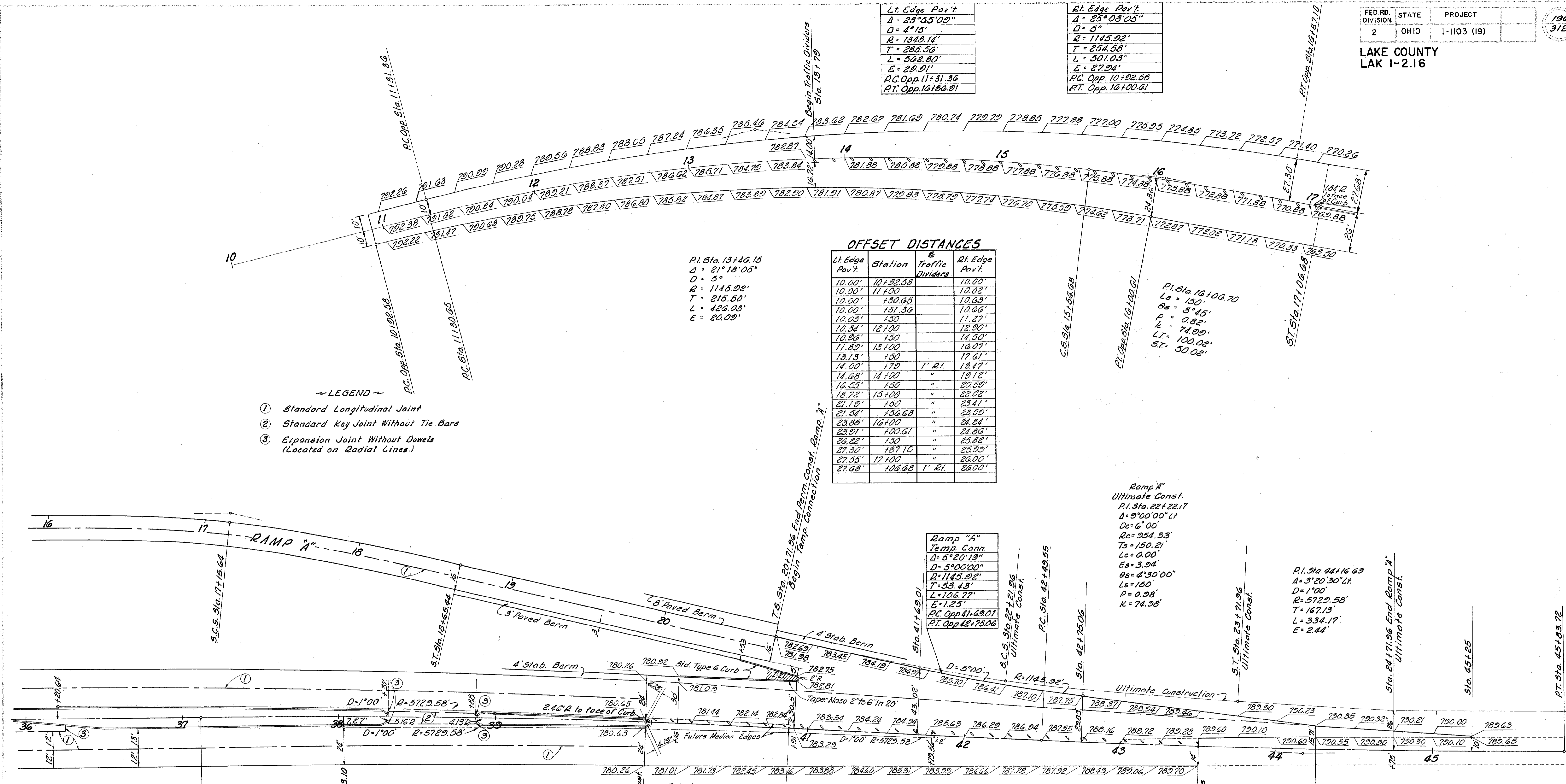

- ~ LEGEND ~
- ① Standard Longitudinal Joint
 - ② Standard Key Joint Without Tie Bars
 - ③ Expansion Joint Without Dowels (Located on Radial Lines.)

P.I. Sta. 13+46.15
 Δ = 21°18'05"
 D = 5°
 R = 1145.92'
 T = 215.50'
 L = 426.03'
 E = 20.09'

OFFSET DISTANCES

Lt. Edge Pav't	Station	Traffic Dividers	Rt. Edge Pav't
10.00'	10+92.58		10.00'
10.00'	11+00		10.02'
10.00'	130.65		10.63'
10.00'	131.56		10.66'
10.03'	130		11.27'
10.34'	12+00		12.90'
10.96'	130		14.50'
11.89'	13+00		16.07'
13.13'	130		17.61'
14.00'	179	1' 21"	18.47'
14.68'	14+00	"	19.12'
16.55'	130	"	20.59'
18.72'	15+00	"	22.02'
21.19'	130	"	23.41'
21.54'	136.68	"	23.59'
23.88'	16+00	"	24.84'
23.91'	100.61	"	24.86'
26.22'	130	"	25.82'
27.30'	187.10	"	25.99'
27.55'	17+00	"	26.00'
27.68'	106.68	1' 21"	26.00'

P.I. Sta. 16+06.70
 Δ = 150°
 Δs = 3°45'
 P = 0.82'
 k = 74.99'
 LT = 100.02'
 ST = 50.02'

Ramp "A"
 Ultimate Const.
 P.I. Sta. 22+22.17
 Δ = 9°00'00" Lt
 Dc = 6' 00"
 Rc = 254.93'
 Ts = 150.21'
 Lc = 0.00'
 Es = 3.94'
 Δs = 4°30'00"
 Ls = 150'
 P = 0.98'
 K = 74.98'

P.I. Sta. 44+16.69
 Δ = 3°20'30" Lt
 D = 1' 00"
 R = 5729.58'
 T = 167.13'
 L = 334.17'
 E = 2.44'

OFFSET DISTANCES

Lt. Edge Pav't	Lt. Edge Pav't. Ramp A	Lt. Edge Median	Station	Rt. Edge Median	Rt. Edge Pav't.	Lt. Edge Pav't. Ramp A	Lt. Edge Pav't. Rt. 91	Lt. Edge Median	Station	Rt. Edge Median	Rt. Edge Pav't.
		7.00'	36+20.64			54.86'	24.15'		41+00		24.03
		6.93	+50		7.00'	46.28	23.26		+50		21.66
		6.45	37+00			43.02	22.93		+69.01		20.76
		6.28	+11.81		7.00'	38.14	22.38		42+00		19.29
		5.67	+50		6.87	32.12	21.49		+49.55		16.94
		4.87	38+00		6.32	29.83	20.99		+75.06		15.74
		4.82	+09.10		6.27	27.76	20.38		43+00		14.72
		4.07	+50		5.53	23.27	18.84		+50		13.00
		3.27	39+00		4.73	18.34	16.86		44+00		
		2.48	+50		3.93	15.71	15.71		+25		
		1.73	+96.60		3.19	14.44			+50		
		26.73			40+50	28.19			45+00		
		25.17				26.26					
		59.05			+75.78				10.00'		
		36.91			+85.06				+25		

P.I. Sta. 39+00.00
 Δ = 3°45'45" Rt.
 D = 1' 00"
 R = 5729.58'
 T = 188.19'
 L = 376.25'
 E = 3.09'

MICHAEL BAKER, JR., CONSULTING ENGINEERS
 ROCHESTER, PENNSYLVANIA

STATE OF OHIO
 DEPARTMENT OF HIGHWAYS
 STATE HIGHWAY NO. I.C-43
 STATE ROUTE NO. 91
 PAVEMENT TRANSITION AND
 INTERSECTION DETAILS

Designed	Drawn	Traced	Checked	Reviewed	Date	Revised
H.v.V.	J.S.H.	A.L.H.	B.P.			