

LAKE COUNTY  
LAK-1-2.16

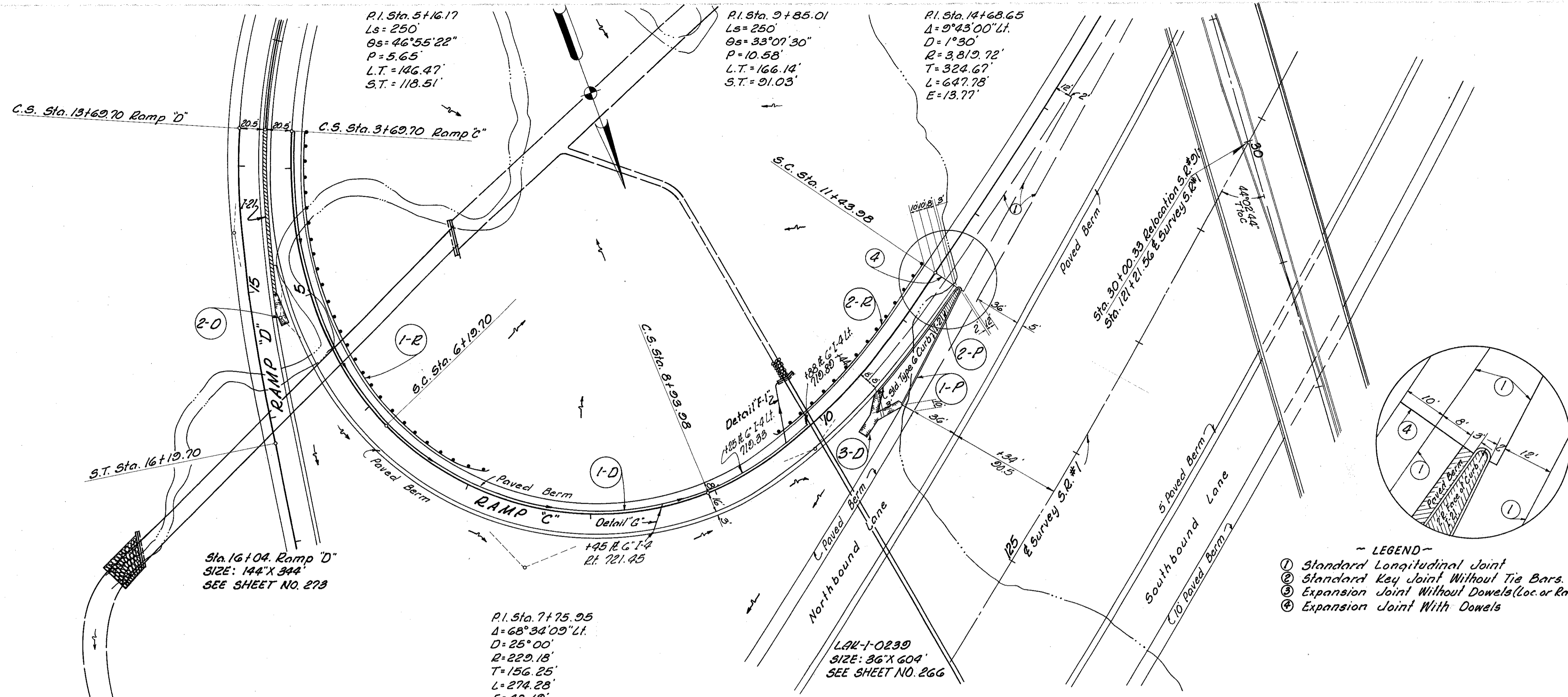

ROADWAY & PAVEMENT						
Ref. No.	Station		Side	I-7B	I-12	I-21
	From	To		Grd. Rail Conc. Curbs Conc. Med. Type G	Alt. Type / Sp. Yds.	
1-P	3160.70	7107.85	Lt.	326.21		
2-P	8166.10	11743.93	Lt.	173.00		
1-P	10734	11743.93			206.30	
2-P	11705	11743.93				23
Totals				501.21	206.30	23

- LEGEND -
- ① Standard Longitudinal Joint
  - ② Standard Key Joint Without Tie Bars
  - ③ Expansion Joint Without Dowels (Loc. or Rad Line)
  - ④ Expansion Joint With Dowels

See Sta. No.	Ref. No.	Station	Side		Sodding		
			From	To	Each	Sp. Yds.	
256	1-D	3170	Lt	676	10	2	35
	2-D	5100	Rt		15		
	3-D	10130	Rt		40		
Totals				676	10	2	35

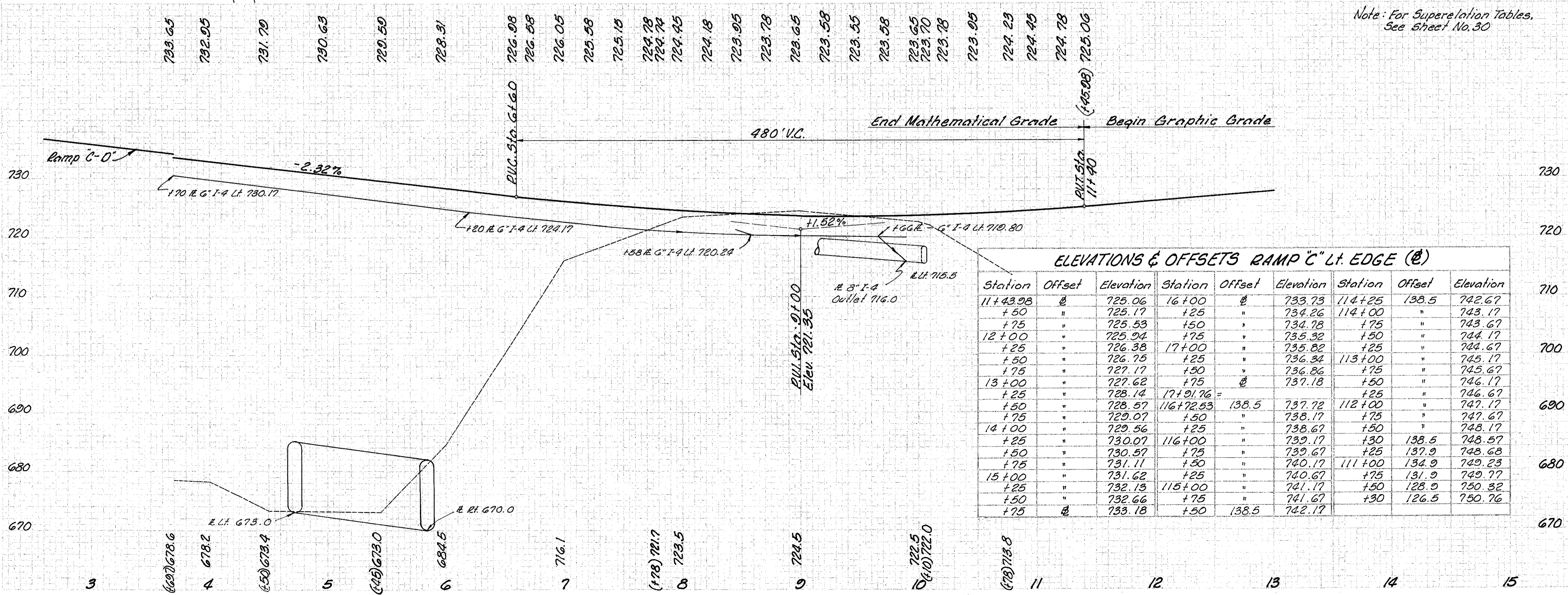

Note: For Superlevation Tables, See Sheet No. 30

MICHAEL BAKER JR., CONSULTING ENGINEERS  
ROCHESTER, PENNSYLVANIA

STATE OF OHIO  
DEPARTMENT OF HIGHWAYS  
STATE HIGHWAY NO. 1  
C-43  
S.R. NO. 91 INTERCHANGE RAMP "C"  
STA. 3+69.70 TO STA. 15+00

Designed	Drawn	Traced	Checked	Reviewed	Date	Revised
H.V.V.	J.S.	A.L.H.	B.P.			