

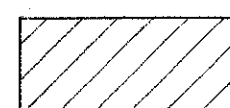

ESTIMATED QUANTITIES			
ITEM	DESCRIPTION	QUANTITY	
		MEASURED	ESTIMATED
519	PATCHING CONCRETE STRUCTURE AS PER PLAN	6 SF	18 SF

- LEGEND**
-  ITEM 202, PORTIONS OF STRUCTURE REMOVED, AS PER PLAN
  -  ITEM 519, PATCHING CONCRETE STRUCTURE, AS PER PLAN

- NOTES:**
- CONSTRUCTION JOINT PREPARATION: REMOVE CONCRETE TO A ROUGH SURFACE. PRIOR TO CONCRETE PLACEMENT, ABRASIVELY CLEAN JOINT SURFACE TO REMOVE LOOSE DISINTEGRATED CONCRETE. THEN THE JOINT SURFACE AND ANY EXPOSED REINFORCING STEEL SHALL BE THOROUGHLY CLEANED OF ALL DIRT, DUST, OR OTHER FOREIGN MATERIAL BY THE USE OF WATER, AIR UNDER PRESSURE, OR OTHER METHODS THAT PRODUCE SATISFACTORY RESULTS. CONCRETE BONDING SURFACES SHALL BE WET WITHOUT FREE WATER AS CONCRETE IS PLACED.
  - SUBSTRUCTURE CONCRETE REMOVAL SHALL BE BY MEANS OF APPROVED PNEUMATIC HAMMERS EMPLOYING POINTED AND BLUNT CHISEL TOOLS. HYDRAULIC HOE-RAM TYPE HAMMERS WILL NOT BE PERMITTED. THE WEIGHT OF THE HAMMER SHALL NOT BE MORE THAN 35 POUNDS FOR REMOVAL WITHIN 18 INCHES OF PORTIONS TO BE PRESERVED. OUTSIDE THE 18 INCH LIMIT A HAMMER HEAVIER THAN 35 POUNDS, BUT NOT TO EXCEED 90 POUNDS, MAY BE USED AT THE APPROVAL OF THE ENGINEER. PNEUMATIC HAMMERS SHALL NOT BE PLACED IN DIRECT CONTACT WITH REINFORCING STEEL THAT IS TO BE RETAINED IN THE REBUILT STRUCTURE.
  - FOR NEW BACKWALL AND CONCRETE PARAPET REPLACEMENT DETAILS, SEE SHEETS 9/52 AND 10/52.
  - ALL ELEVATIONS SHOWN WITH REFERENCE TO THE EXISTING ABUTMENTS ARE APPROXIMATE.
  - FOR ADDITIONAL NOTES, SEE SHEET 1/52.

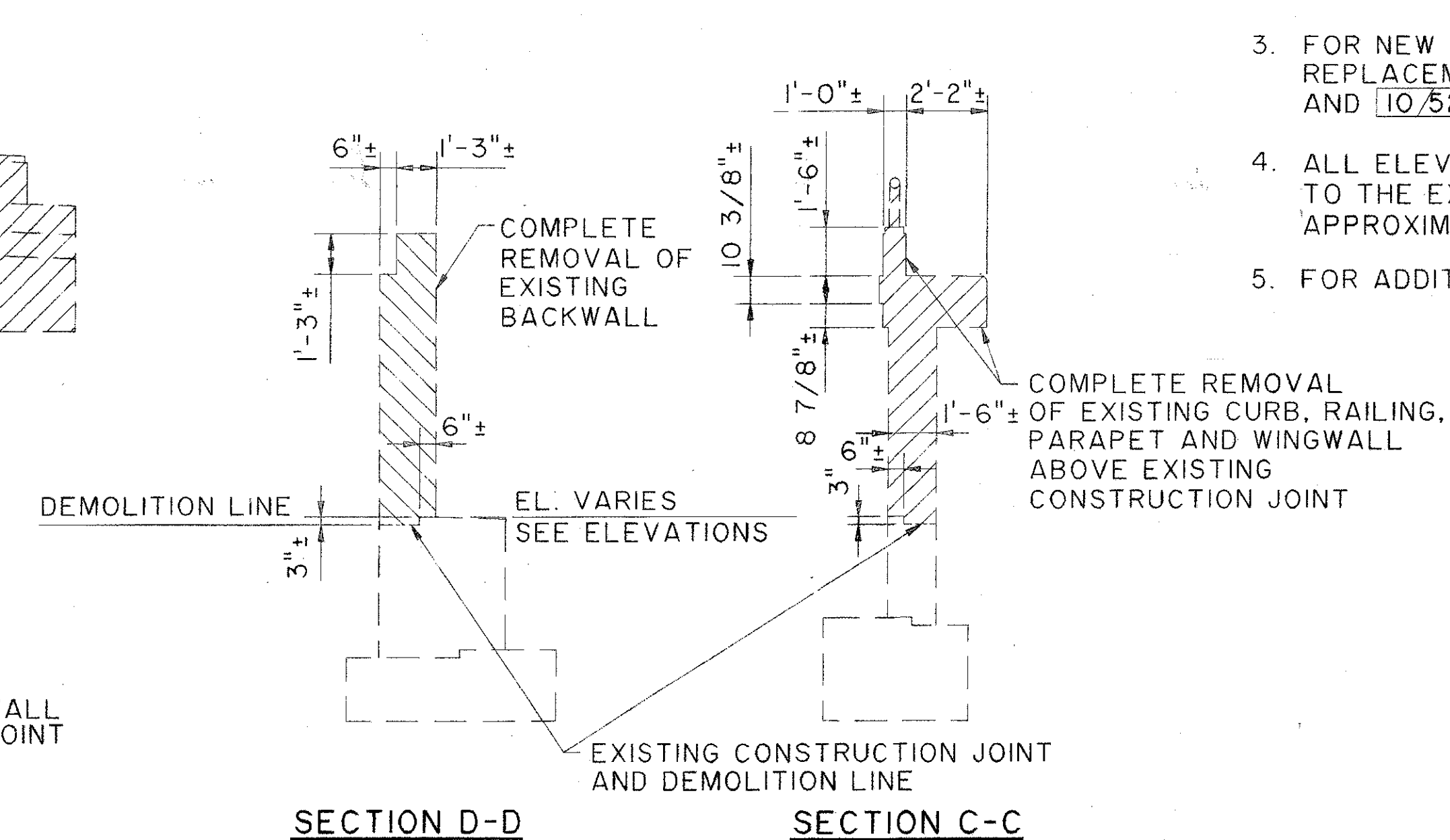
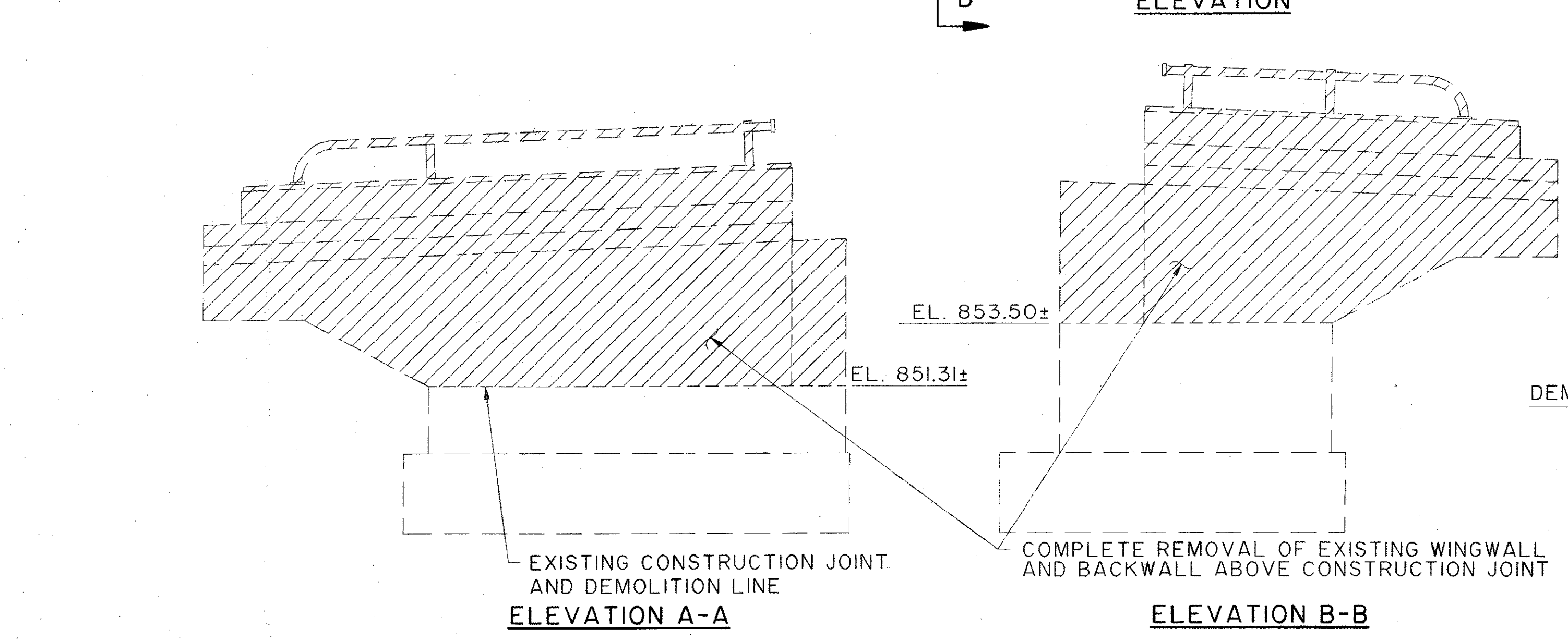
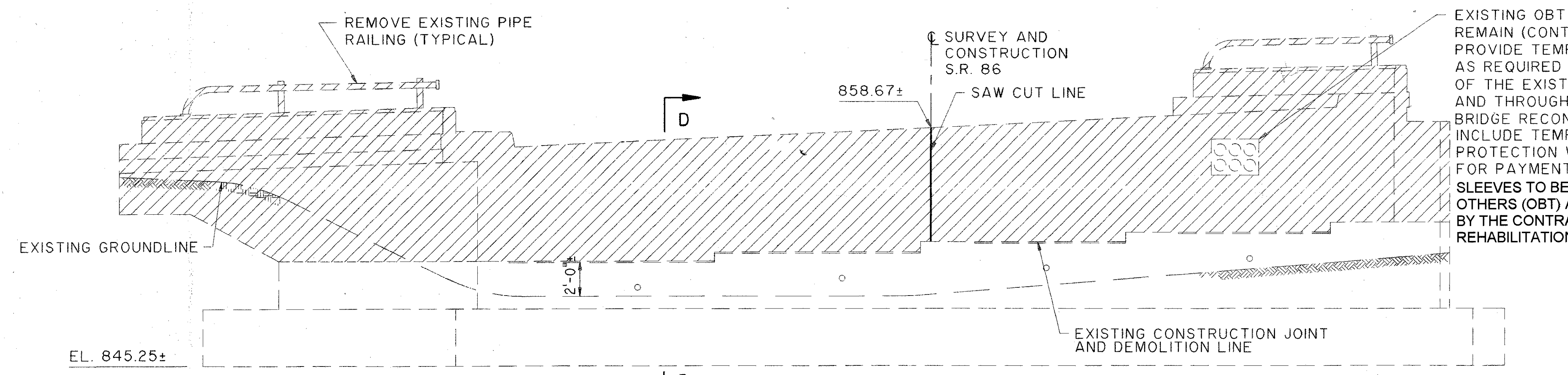
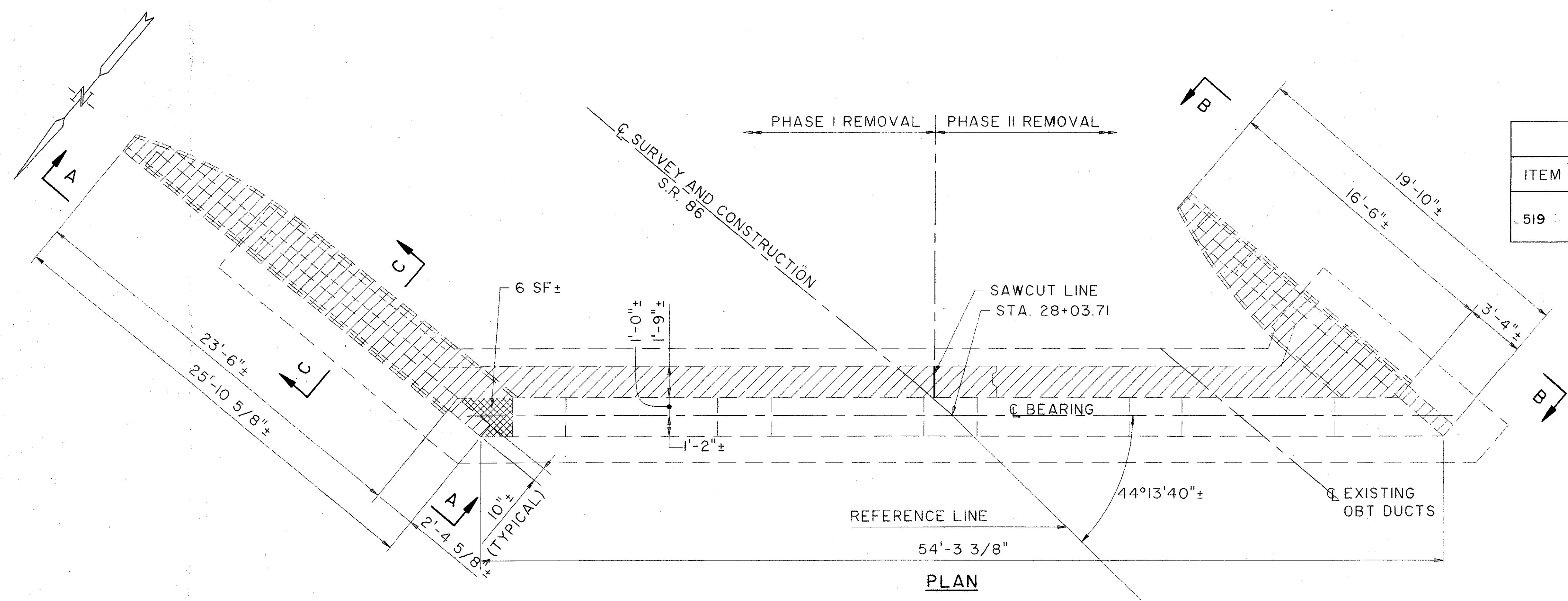

THE OSBORN ENGINEERING COMPANY 7/52  
CONSULTING ENGINEERS  
CLEVELAND, OHIO 44114

**REAR ABUTMENT DEMOLITION**  
BRIDGE NO. LAK-90-1742  
S.R. 86 OVER I-90

LAKE COUNTY						OHIO
DESIGNED	DRAWN	TRACED	CHECKED	REVIEWED	DATE	REVISED
LYH	BFG		JRS	GA	2/94	O.D.T. 6/17/94

Files: K:\VCL\2007\0185\STRUCT\01855729  
 Plot: 5/20/07 11:48  
 Drawn By: Date: 5/20/07 11:48 (1:12)

S.R. 86