

**BENCHMARK**  
 STA. 15+64.09, 38.83' RT.  
 TOP OF IRON PIN EL. 807.76

**I-90 CURVE DATA**  
 PI STA. 16+20.16  
 $\Delta = 24^\circ 21' 30''$   
 $R = 12277.67'$   
 $D = 0^\circ 28' 00''$   
 $T = 2649.85'$   
 $L = 5219.64'$   
 $E = 282.70'$

**BENCHMARK**  
 STA. 24+63.20, 26.54' RT.  
 TOP OF IRON PIN EL. 800.97

OHIO  
 F.H.W.A. REGION 5  
 LAK-90-17.42/25.15/27.76

**LEGEND**

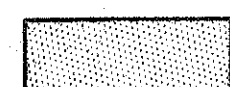
-  ITEM 660, SODDING, REINFORCED
-  ITEM 838, GABION, WITH ADDITIONAL COATING

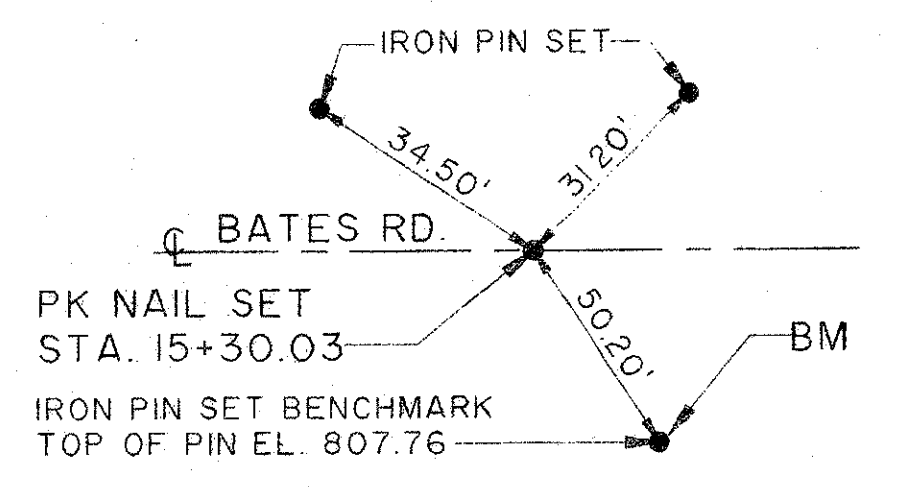

**HORIZONTAL CONTROL POINT NO. 1**  
 STA. 15+30.03

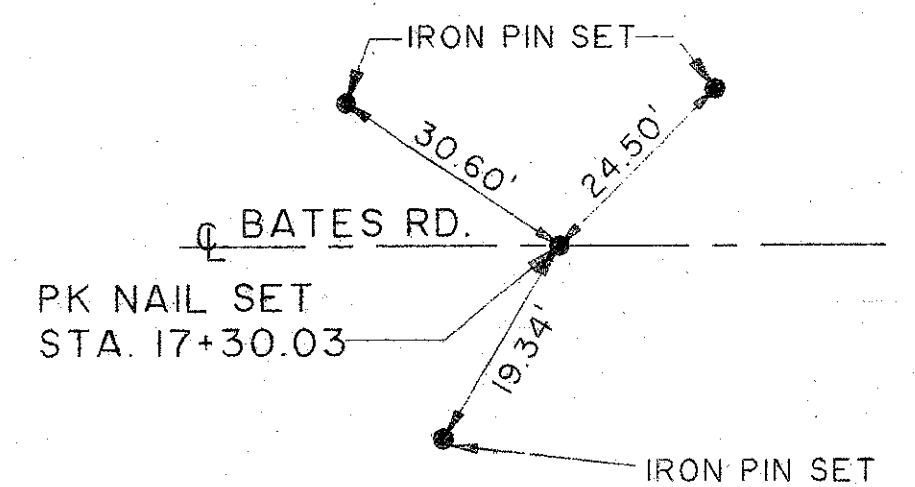

**HORIZONTAL CONTROL POINT NO. 2**  
 STA. 17+30.03

FOR ESTIMATED QUANTITIES SEE SHEET 27

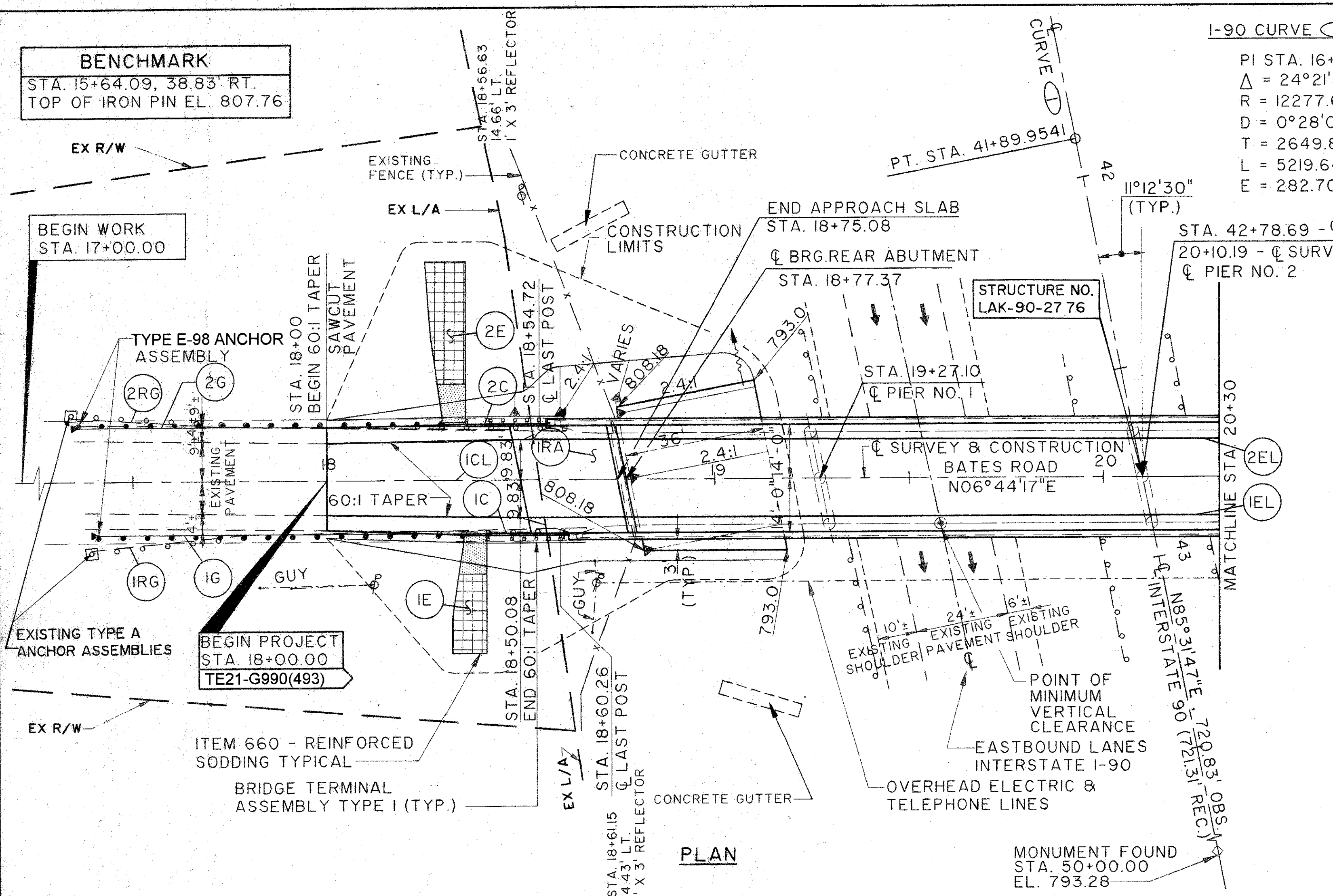

**PLAN**

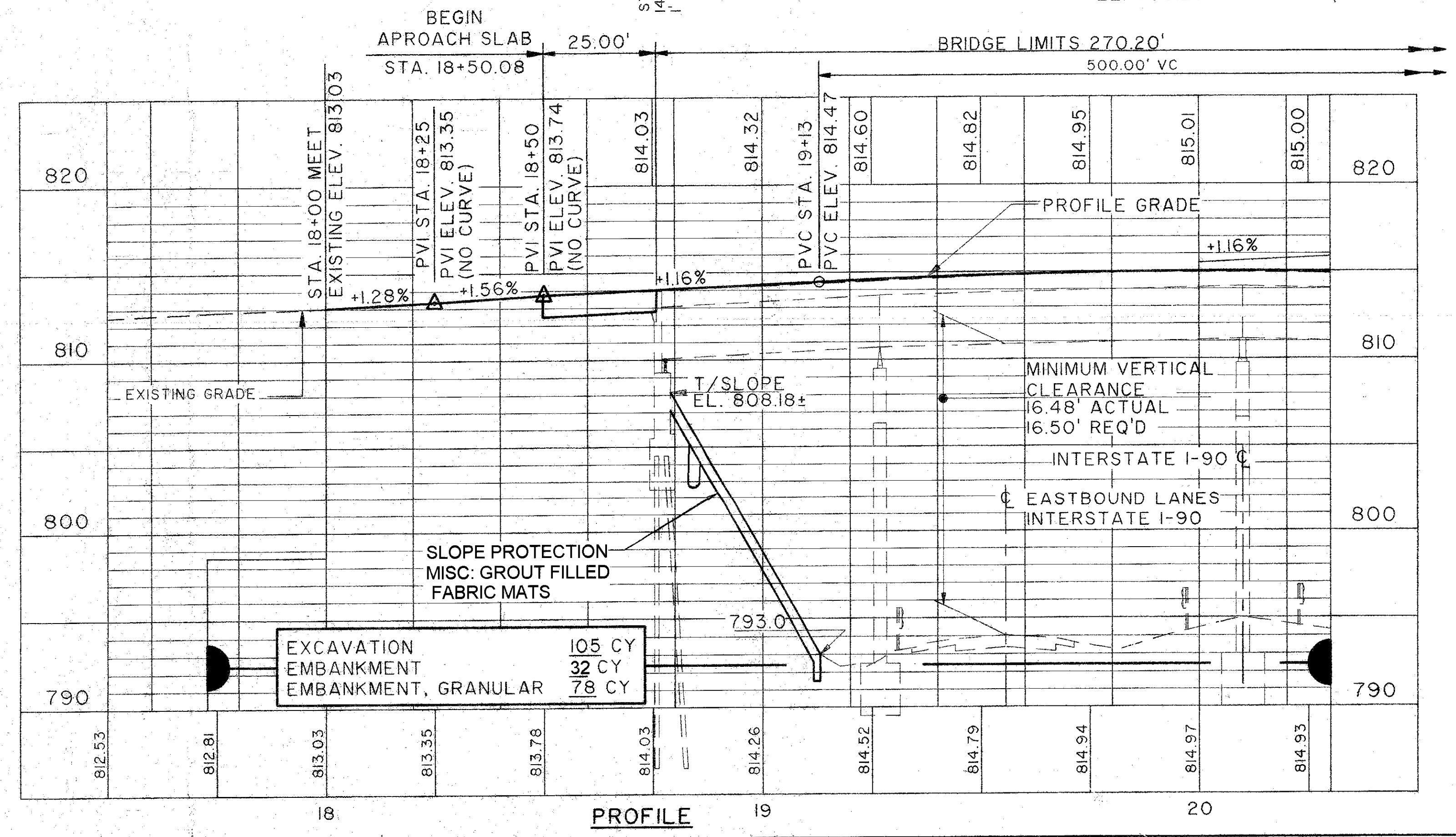

**PROFILE**

EXISTING STRUCTURE	
TYPE:	FOUR SPAN CONTINUOUS WIDE FLANGED ROLLED STEEL BEAM STRINGERS WITH REINFORCED CONCRETE DECK AND SUBSTRUCTURE
SPAN LENGTHS:	49'-9"±, 83'-1"±, 83'-0"±, & 49'-10"± C/C BEARINGS
ROADWAY WIDTH:	24'-0" FACE-TO-FACE OF CURB W/ 2'-0" SAFETY CURBS ON EACH SIDE
LOADING:	HS15-44
LOAD FREQUENCY:	CF-130
SKEW:	11°-12'-30"± RIGHT FORWARD
ALIGNMENT:	TANGENT
WEARING SURFACE:	3/4"± DENSE CONCRETE
APPROACH SLABS:	AS-1-54 (25'-0" LONG)
RAILINGS:	CONCRETE PARAPET W/ PIPE RAILING
YEAR BUILT:	1958
STRUCTURE FILE #:	4305043
PROPOSED STRUCTURE	
PROPOSED WORK:	NEW COMPOSITE REINFORCED CONCRETE DECK, NEW ABUTMENT BACKWALLS, NEW WINGWALLS, RESET ROCKER BEARINGS, NEW STRIP SEAL EXPANSION JOINTS, PATCH AND SEAL SUBSTRUCTURES, NEW APPROACH SLABS.
TYPE:	FOUR SPAN CONTINUOUS COMPOSITE WIDE FLANGED, ROLLED STEEL BEAM STRINGERS WITH NEW REINFORCED CONCRETE DECK AND MODIFIED SUBSTRUCTURE
SPAN LENGTHS:	49'-9"±, 83'-1"±, 83'-0"±, & 49'-10"± C/C BEARINGS
ROADWAY WIDTH:	28'-0" TOE-TOE OF CONCRETE PARAPET
LOADINGS:	HS20-44 CASE II AND ALTERNATE MILITARY LOADS
SKEW:	11°-12'-30"± RIGHT FORWARD
ALIGNMENT:	TANGENT
WEARING SURFACE:	1" MONOLITHIC CONCRETE
APPROACH SLABS:	AS-1-81 (25'-0" LONG)
CROWN:	3/16" / FOOT
RAILINGS:	CONCRETE PARAPET W/ CHAIN LINK FENCE

**PLAN AND PROFILE STA. 17+50 TO STA. 20+30**

File name: K:\001\0007\0185\STRUCT\0185S102  
 Plot: Scale: 1" = 40' / 05-20-94 (16)  
 Plot Date: 05-20-94 (16)

BATES RD.