

**BENCHMARK**  
 STA. 103+46.07, 24.26' LT.  
 TOP OF IRON PIN EL. 846.29

**BENCHMARK**  
 STA. 105+44.18, 25.42' LT.  
 TOP OF IRON PIN EL. 835.95

CALC. APG  
 BY: DATE 5/94  
 CHK'D BY: GA  
 DATE 5/94  
 OHIO REGION 5  
 25  
 92

LAKE COUNTY  
 LAK-90-17.42/25.15/27.76

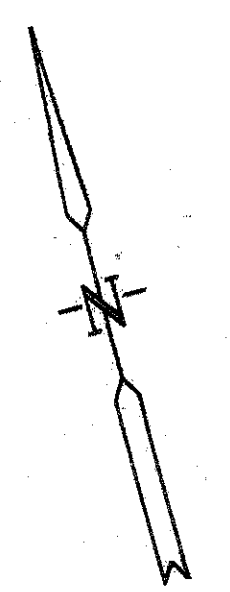

**LEGEND**  
 FOR LEGEND, SEE SHEET 24

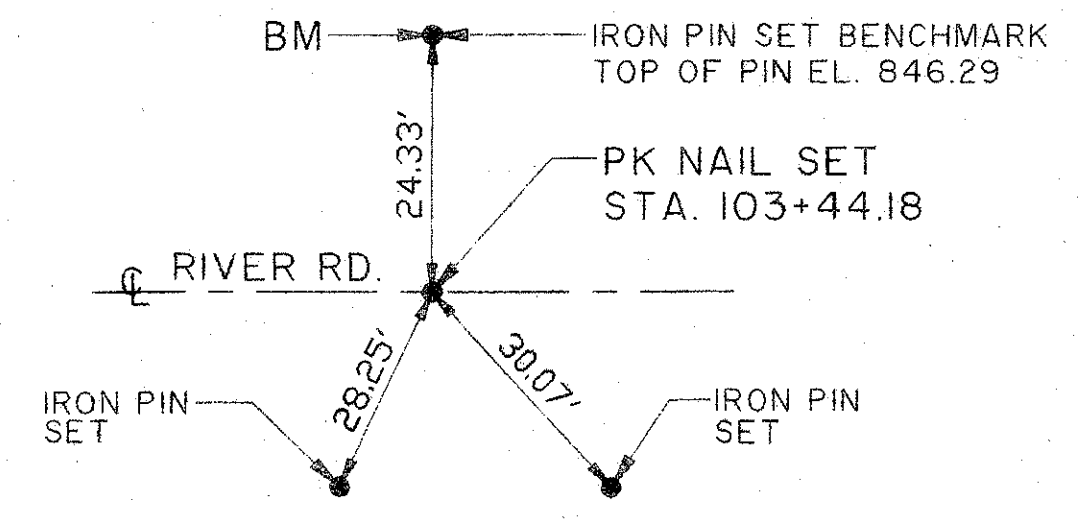
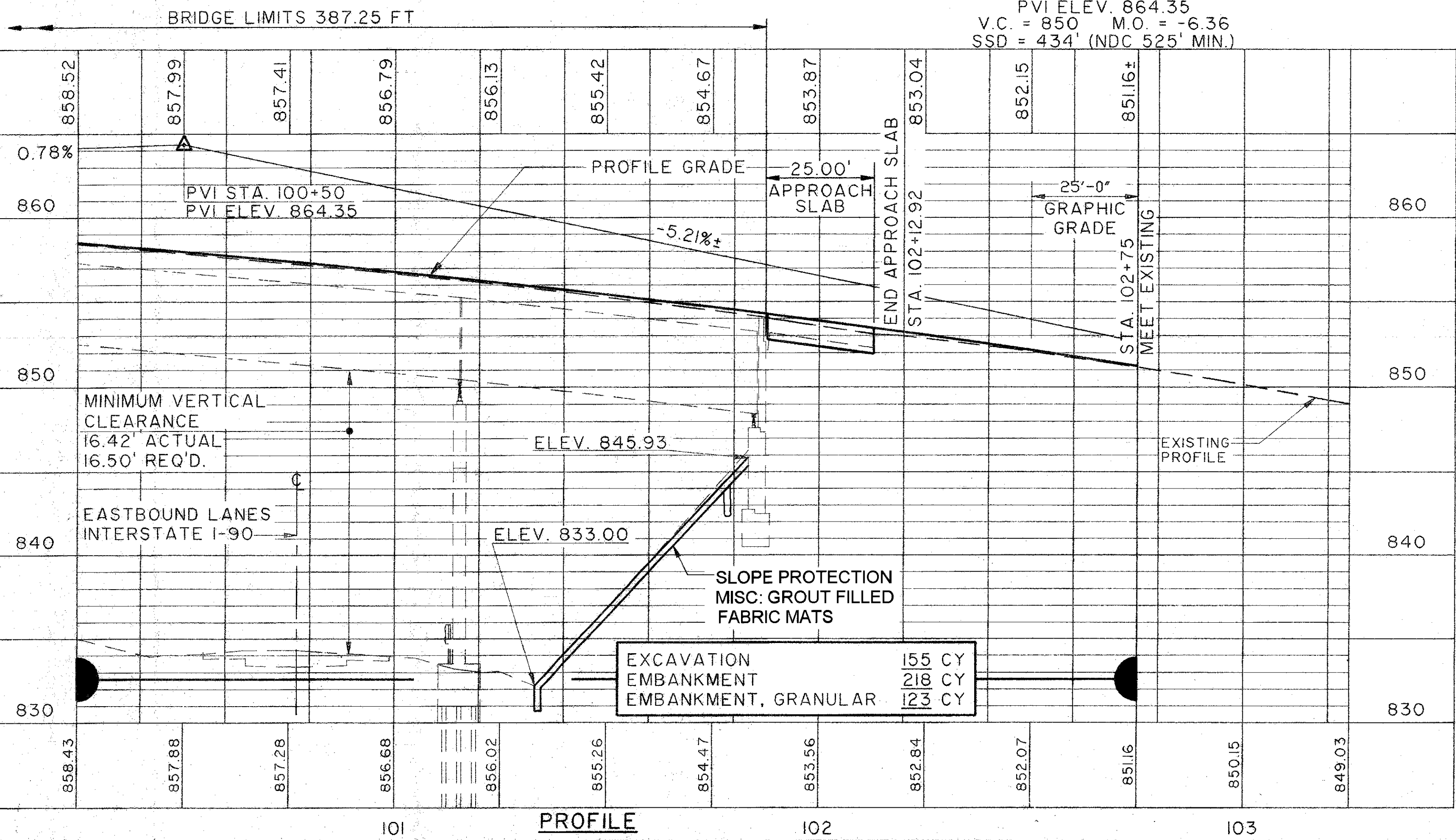
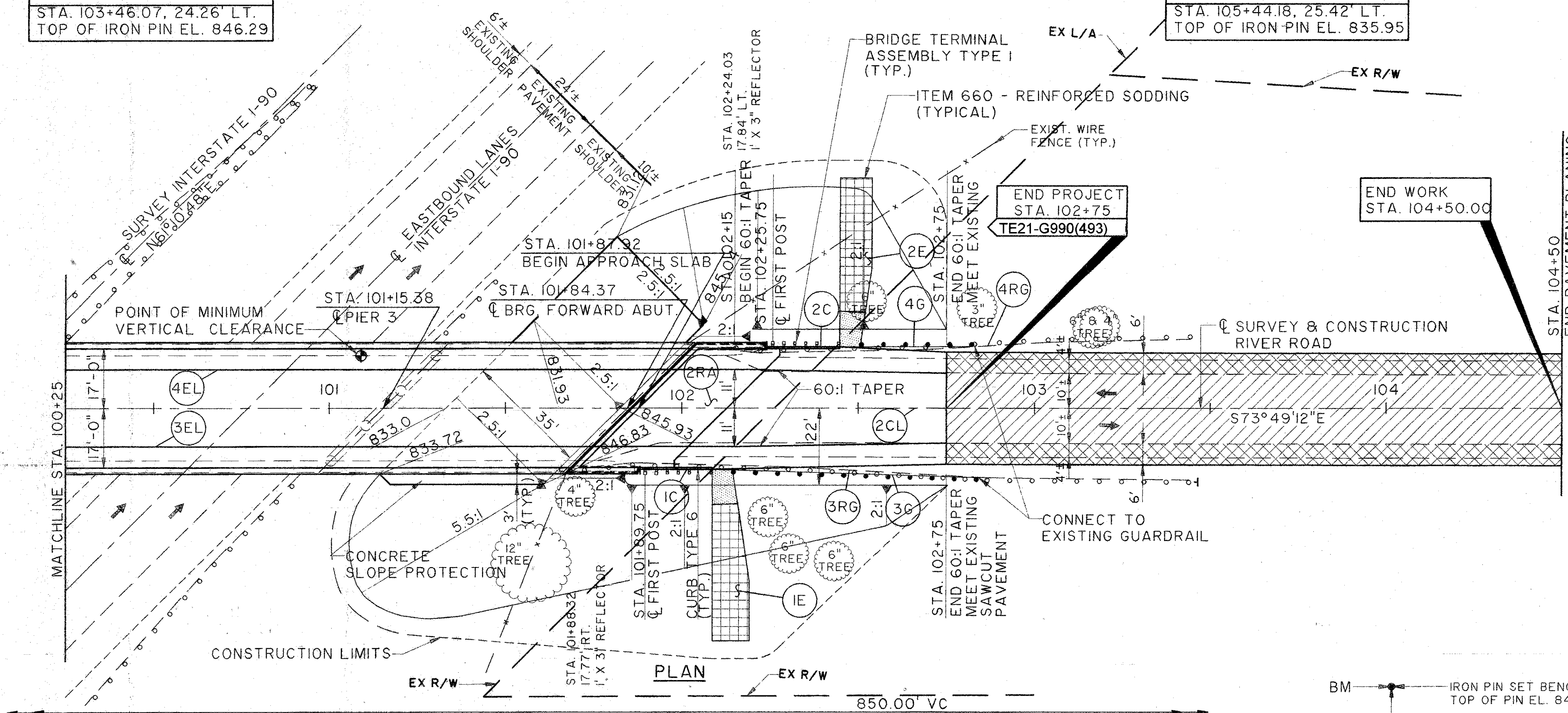

HORIZONTAL CONTROL POINT NO. 2  
 STA. 103+44.18

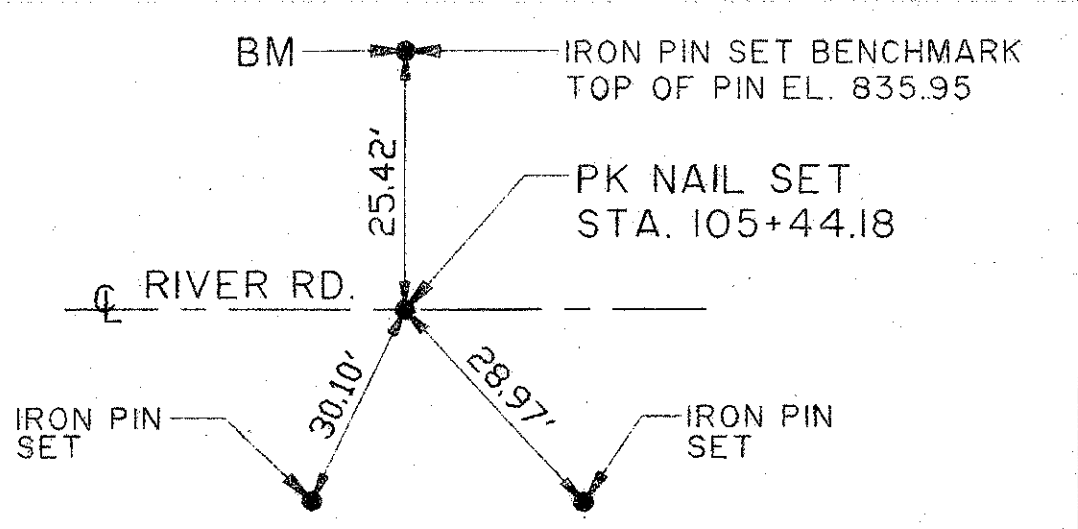

HORIZONTAL CONTROL POINT NO. 3  
 STA. 105+44.18

STATION	FROM	TO	ITEM	QUANTITY	UNIT	TOTAL
605			AGGREGATE DRAIN		LN FT	238
			S-DW			
			STATION			
			BARRIER REFLECTORS TYPE A2		EACH	20
			BRIDGE TERMINAL ASSEMBLY TYPE 1		EACH	4
			GUARD RAIL TYPE 5		LN FT	400
			GUARD RAIL REMOVED		LN FT	462
			APPROACH SLAB REMOVED		SQ YD	168
			S-DW			
			STATION			
			GABION W/ ADDITIONAL COATING		CU YD	8
			SODDING, REINFORCED		SQ YD	69
			CENTER LINE TYPE 2		MILE	.12
			EDGE LINE TYPE 2		MILE	.24
			CURB TYPE 6		LN FT	30
			S-DW			
			STATION			
			RIVER ROAD			
			TOTAL			

PLAN AND PROFILE STA. 100+25 TO 104+50

Reference: K:\M01\7007\01a2\STRUC\701855203  
 Drawn By: Date: 05-20-94 (10)