

FOR TEMPORARY POWER SERVICE: SEE NOTE 11 ON SHEET 13. CEI WILL CHARGE THE CONTRACTOR TO PROVIDE POWER SERVICE FROM AFAR. NO EXISTING AVAILABLE POWER SERVICE IS NEAR BY. CEI WILL PROVIDE SERVICE TO ONE SUPPORT POLE WITH THE CONTROLLER (SEE SHEET 15). THE CONTRACTOR IS RESPONSIBLE FOR ALL POWER SERVICES TO THE OTHER SIGNALS AND LUMINAIRES ON THIS SITE.

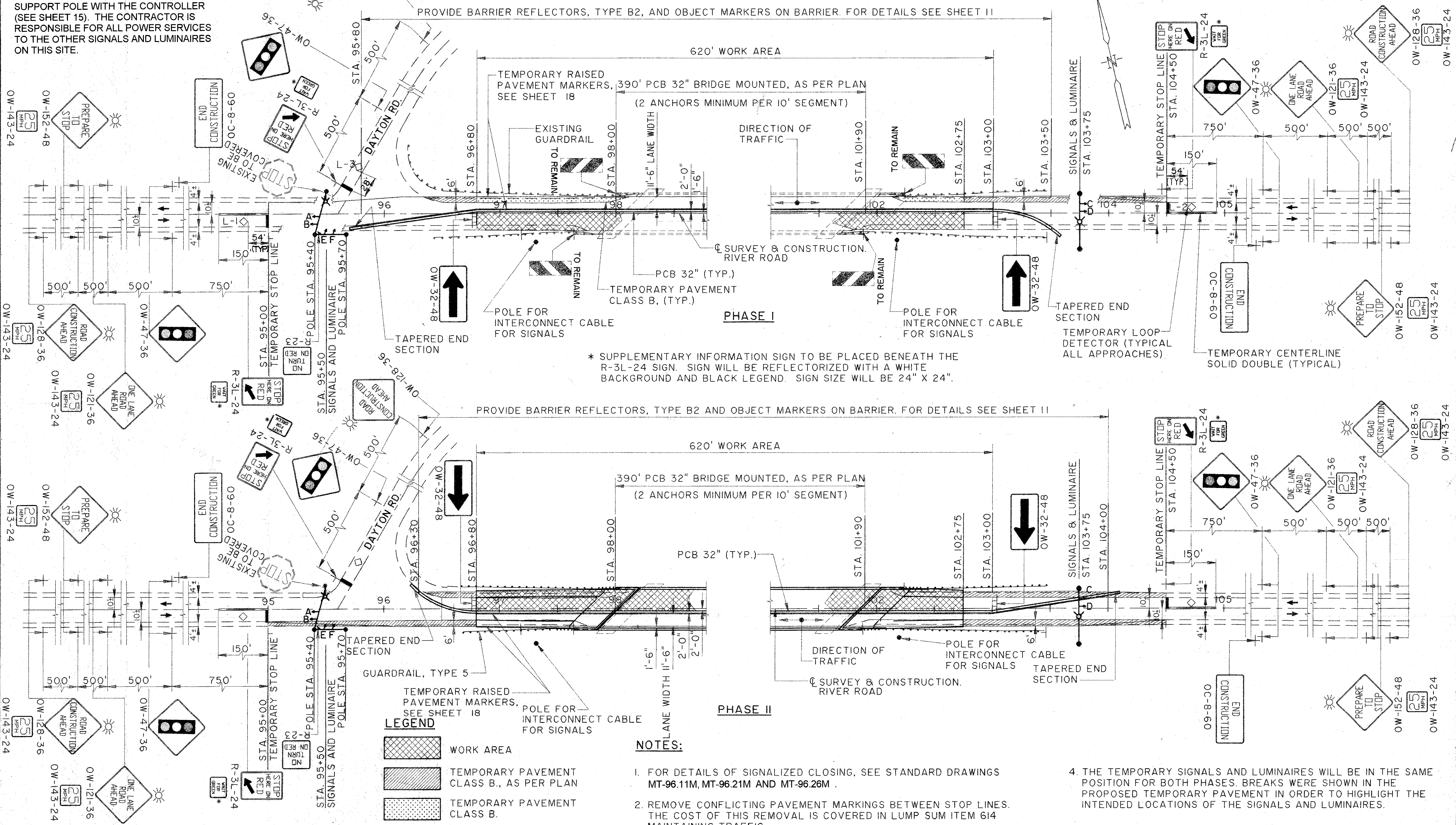

LEGEND

- WORK AREA
- TEMPORARY PAVEMENT CLASS B., AS PER PLAN
- TEMPORARY PAVEMENT CLASS B.
- TYPE "A" WARNING LIGHT
- PORTABLE CONCRETE BARRIER
- MAGNETIC LOOP DETECTOR

- NOTES:**
- FOR DETAILS OF SIGNALIZED CLOSING, SEE STANDARD DRAWINGS MT-96.11M, MT-96.21M AND MT-96.26M.
 - REMOVE CONFLICTING PAVEMENT MARKINGS BETWEEN STOP LINES. THE COST OF THIS REMOVAL IS COVERED IN LUMP SUM ITEM 614 MAINTAINING TRAFFIC.
 - INITIAL TIMING FOR THE SIGNALIZED CLOSING SHALL BE AS SHOWN ON SHEET. FOR ADDITIONAL DETAILS SEE SHEET 17. ALL CHANGES IN SIGNAL TIMING SHALL BE APPROVED BY THE ENGINEER.
 - THE TEMPORARY SIGNALS AND LUMINAIRES WILL BE IN THE SAME POSITION FOR BOTH PHASES. BREAKS WERE SHOWN IN THE PROPOSED TEMPORARY PAVEMENT IN ORDER TO HIGHLIGHT THE INTENDED LOCATIONS OF THE SIGNALS AND LUMINAIRES.

SHEET CROSS REFERENCE
 FOR PHASED BRIDGE CONSTRUCTION SECTION SEE SHEET 76

File Name: K:\MUT\0007\0185\STRUCT\0185S078
 Drawn By: Date: 10-17-94 (13)