

LAKE COUNTY
LAK-1-14.55

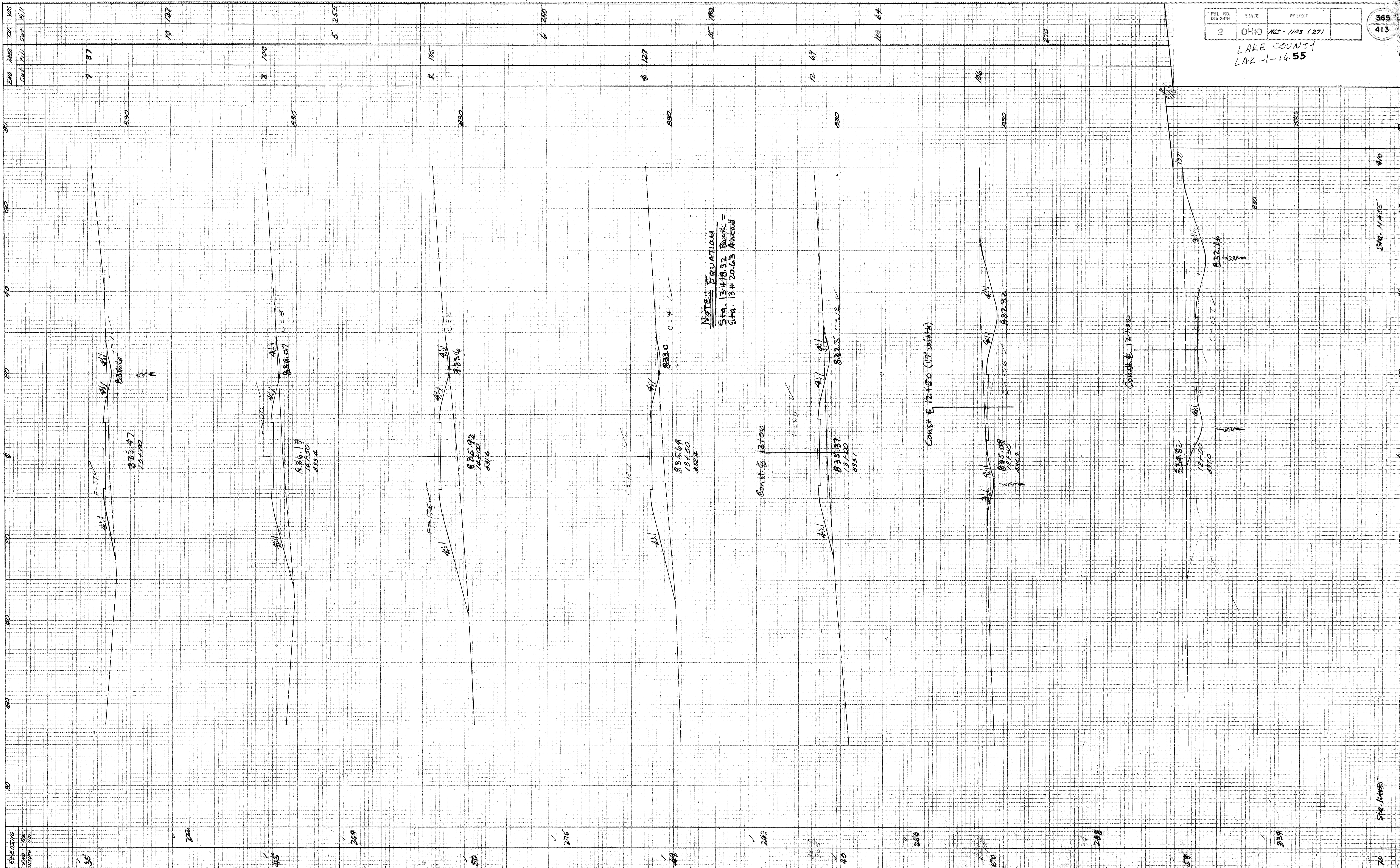

END	AREA	CH.	W.S.
7	37		
3	100		
2	175		
4	127		
12	69		
110	67		
270			

SEIZING	SR	VS
35		
45		
50		
215		
247		
40		
248		
50		
248		
70		

Checked by D.F. 4-2-58
K.T.M. 4-2-58

PATTERSON Drive Reloc Sta 12+00 to 15+00

Sta. 11+55