

LAKE COUNTY
SEC. LAK-1-12.89
LAK-90-13.88-17.54

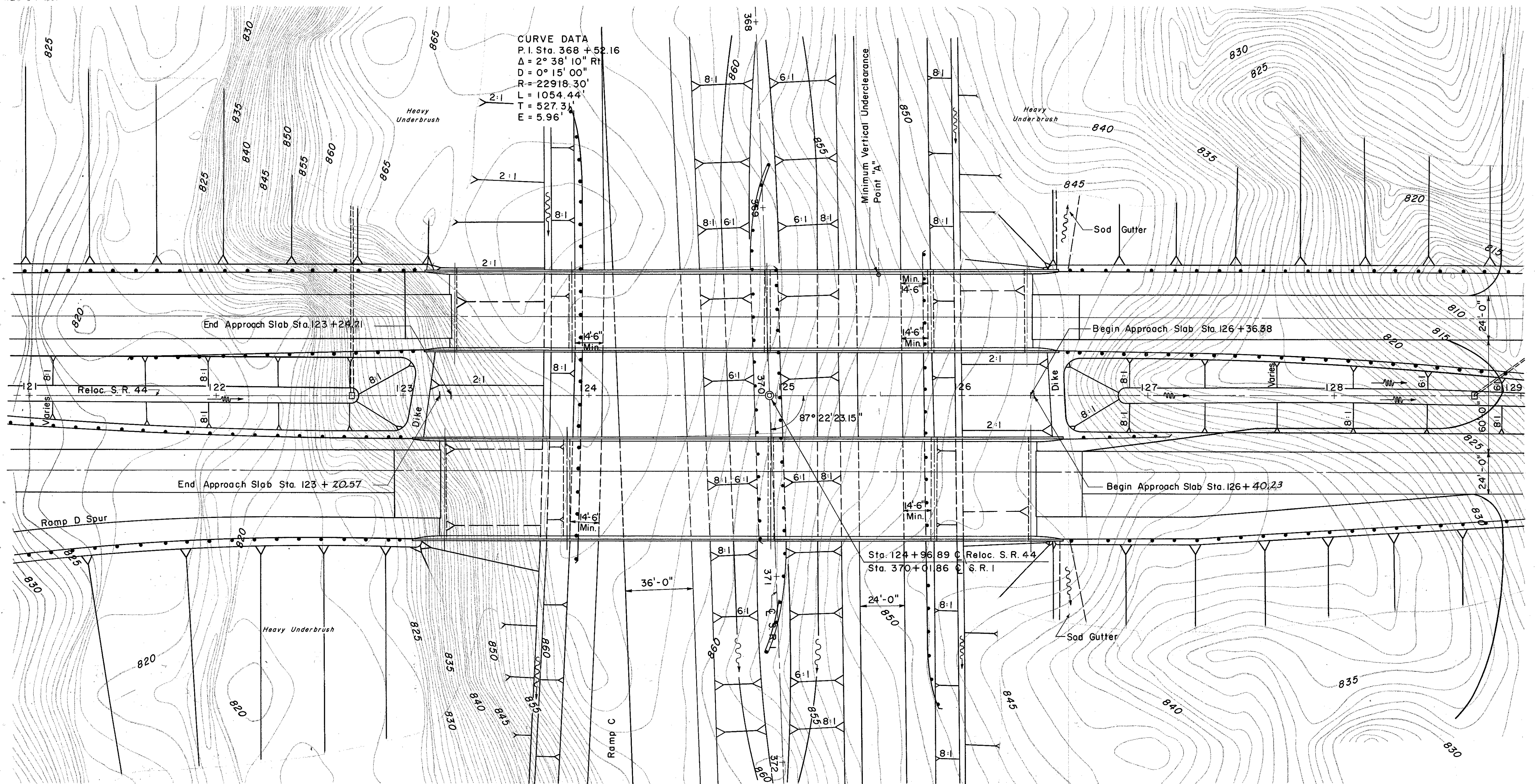
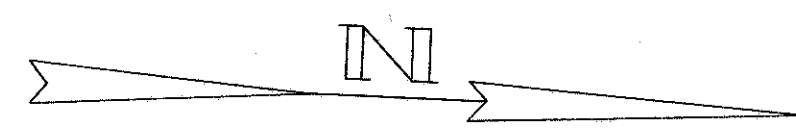

FOUNDATION SOUNDINGS: Foundation design and foundation quantities are based on a study of rod soundings and soil sampling soundings made at the site. This sounding information may be inspected in the Interstate Projects Office and in the Division Office, but the state does not guarantee the accuracy thereof. All grading shall be in accordance with the grading plan sheet 331.

PROPOSED STRUCTURE

TYPE: Continuous Plate Girder with Conc. Reinf. Deck & Substructure.
SPAN: East Bridge 66'-0", 110'-0", 87'-0", 52'-2".
 West Bridge 63'-0", 105'-0", 87'-0", 52'-2".
ROADWAY: North Bound Lanes 54'-0" f/f Parapets. South Bound Lanes 42'-0" f/f Parapets.
LOAD FREQUENCY: C.F. 2000 Adequate for A.A.S.H.O. Alternate Loading.
SKREW: 00°00'00"
WEARING SURFACE: 1" Monolithic Concrete.
APPROACH SLAB: 25'-0" (Long) (AS-1-54)
ALIGNMENT: S.R. 1, 2°38'10" Rt. Curve
 S.R. 44 Tangent

- B.M. # 40 Lag Bolt in root of 6" Poplar
118' Rt. of Sta. 366 + 85
Elev. 860.06
- B.M. # 41 Lag Bolt in root of 14" Walnut
102' Rt. of Sta. 372 + 21
Elev. 856.75

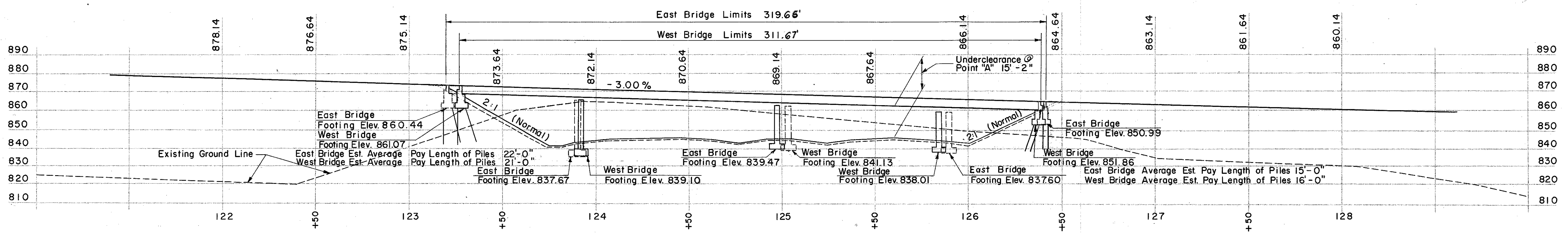

SEC. C-32 FED. AID PROJ. NO. ACI-1103 (21)

PREPARED BY
CAPITOL ENGINEERING ASSOCIATES, DILLSBURG, PA.
FOR
STATE OF OHIO
DEPARTMENT OF HIGHWAYS

SITE PLAN
BRIDGE NO. LAK-1-1370
S.R.1 UNDER RELOC. S.R. 44
LAKE COUNTY
STA. 370+01.86

DESIGNED	DRAWN	TRACED	CHECKED	REVISED	DATE	REVISED
----------	-------	--------	---------	---------	------	---------