

MICROFILMED  
DEC 10 1987

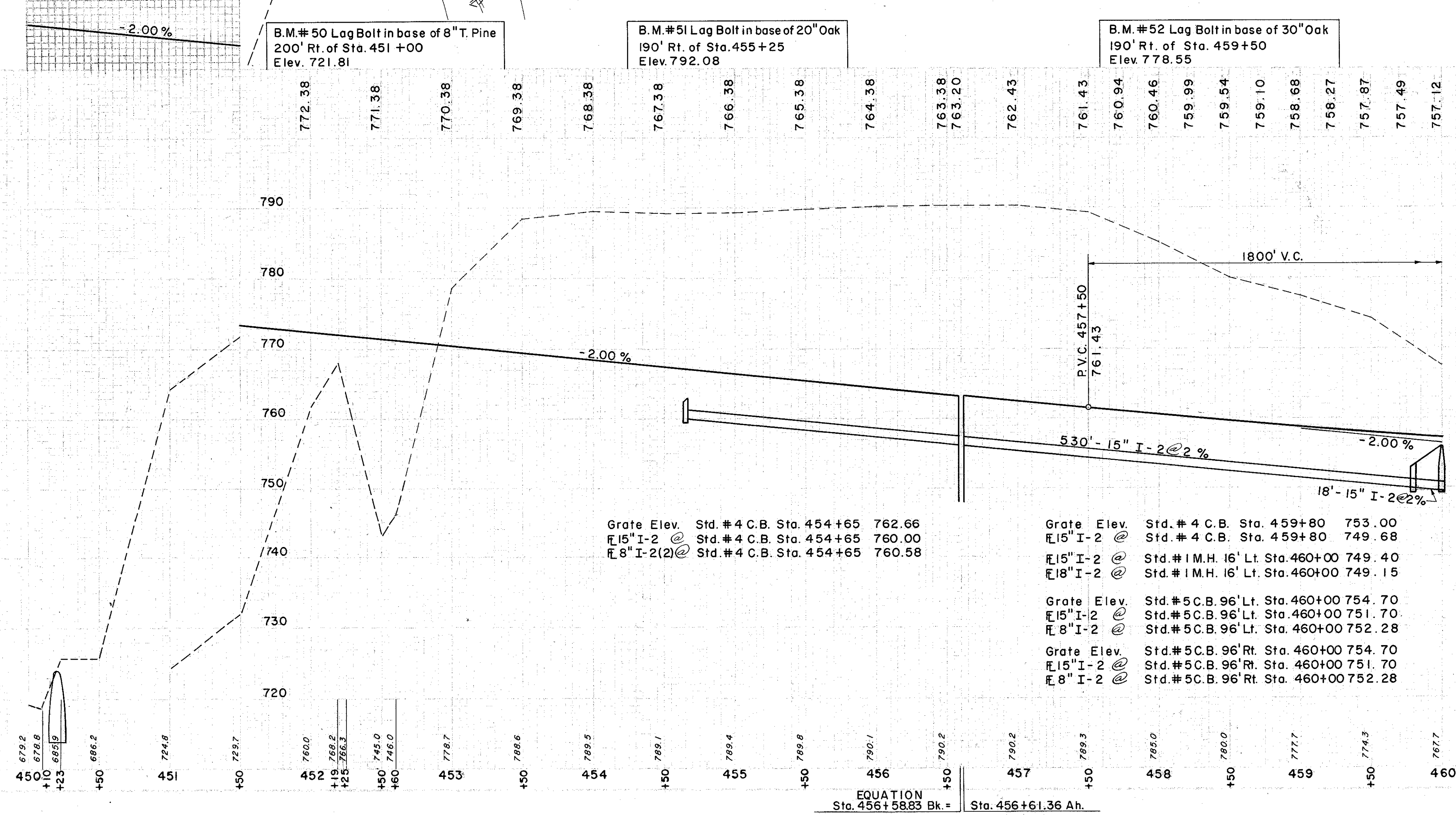
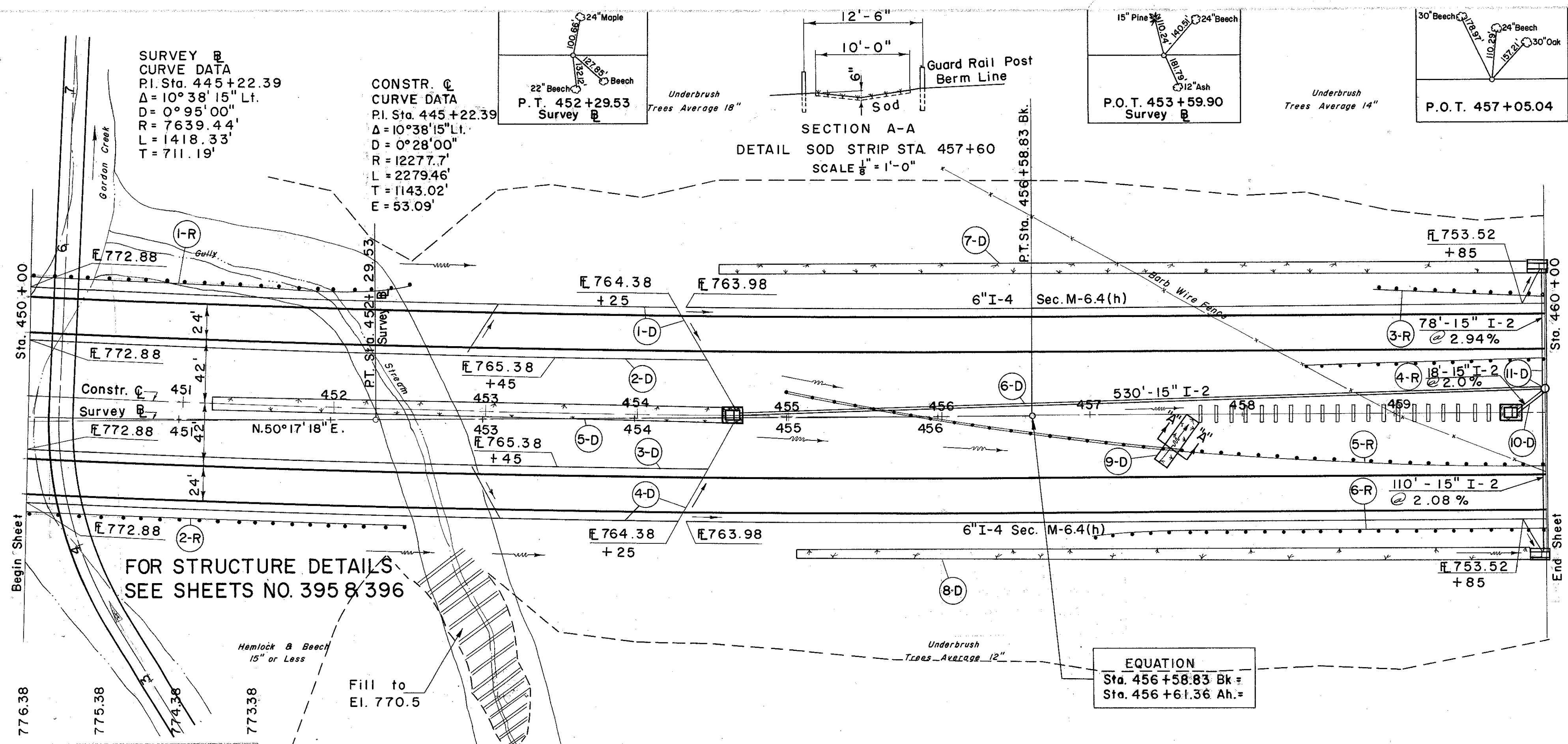

(D) DRAINAGE

REF. STATION NO.	FROM	TO	PIPE SIZE	SLOPE	LENGTH	S. Y.	STANDARD	STANDARD #	M. H.	BASIN	S. Y.
I-2	450+00	452+50	8"	2.1	250	112.5	1	1	1	1	1
I-2	452+50	454+00	8"	2.1	150	112.5	1	1	1	1	1
I-2	454+00	456+00	8"	2.1	200	112.5	1	1	1	1	1
I-2	456+00	458+00	8"	2.1	200	112.5	1	1	1	1	1
I-2	458+00	460+00	8"	2.1	200	112.5	1	1	1	1	1
I-2	460+00	460+00	8"	2.1	0	0	1	1	1	1	1
SUBTOTAL											428
I-4	450+00	452+50	6"	2.0	250	112.5	1	1	1	1	1
I-4	452+50	454+00	6"	2.0	150	112.5	1	1	1	1	1
I-4	454+00	456+00	6"	2.0	200	112.5	1	1	1	1	1
I-4	456+00	458+00	6"	2.0	200	112.5	1	1	1	1	1
I-4	458+00	460+00	6"	2.0	200	112.5	1	1	1	1	1
I-4	460+00	460+00	6"	2.0	0	0	1	1	1	1	1
SUBTOTAL											428
I-5	450+00	452+50	6"	2.0	250	112.5	1	1	1	1	1
I-5	452+50	454+00	6"	2.0	150	112.5	1	1	1	1	1
I-5	454+00	456+00	6"	2.0	200	112.5	1	1	1	1	1
I-5	456+00	458+00	6"	2.0	200	112.5	1	1	1	1	1
I-5	458+00	460+00	6"	2.0	200	112.5	1	1	1	1	1
I-5	460+00	460+00	6"	2.0	0	0	1	1	1	1	1
SUBTOTAL											428
I-10	450+00	452+50	6"	2.0	250	112.5	1	1	1	1	1
I-10	452+50	454+00	6"	2.0	150	112.5	1	1	1	1	1
I-10	454+00	456+00	6"	2.0	200	112.5	1	1	1	1	1
I-10	456+00	458+00	6"	2.0	200	112.5	1	1	1	1	1
I-10	458+00	460+00	6"	2.0	200	112.5	1	1	1	1	1
I-10	460+00	460+00	6"	2.0	0	0	1	1	1	1	1
SUBTOTAL											428
TOTAL											1300

(R) ROADWAY

REF. STATION NO.	FROM	TO	PIPE SIZE	SLOPE	LENGTH	S. Y.
1-R	450+00	452+50	18"	2.0	250	112.5
2-R	452+50	454+00	18"	2.0	150	112.5
3-R	454+00	456+00	18"	2.0	200	112.5
4-R	456+00	458+00	18"	2.0	200	112.5
5-R	458+00	460+00	18"	2.0	200	112.5
6-R	460+00	460+00	18"	2.0	0	0
SUBTOTAL						428
TOTAL						1300

STATION	DEPTH OF SODDING	WIDTH OF DITCH	LENGTH	S. Y.
454+50	2	8	1	2.1
460+00	4	8	1	2.1
SUBTOTAL				428
455+00	2	8	1	2.1
460+00	4	8	1	2.1
SUBTOTAL				389
451+50	3	8	1	8.1
454+65	3.5	8	1	8.1
SUBTOTAL				352
TOTAL				1169

152,324 C.Y.  
155,955 C.Y.  
183,247 C.Y.