

LAKE COUNTY  
LAK-1-12.89

*This sheet supersedes sheet no. 20 of the original plan.*

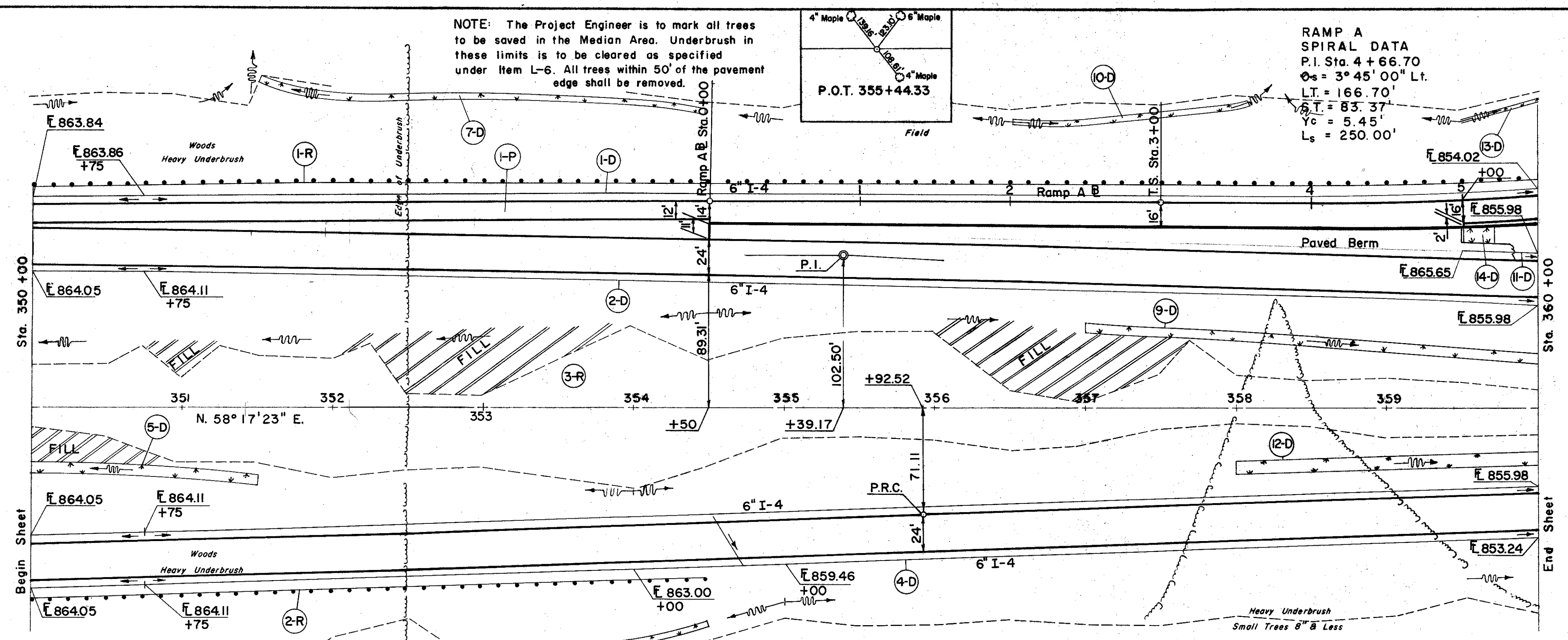

NOTE: The Project Engineer is to mark all trees to be saved in the Median Area. Underbrush in these limits is to be cleared as specified under Item L-6. All trees within 50' of the pavement edge shall be removed.

4" Maple  
6" Maple  
P.O.T. 355+44.33

RAMP A  
SPIRAL DATA  
P.I. Sta. 4+66.70  
Cs = 3° 45' 00" Lt.  
LT = 166.70'  
ST = 83.37'  
Yc = 5.45'  
Ls = 250.00'

CURVE DATA FOR TRANSITION RT. LANES  
CONTROL ON MEDIAN EDGE  
P.I. 102.5' Lt. Sta. 355+39.17  
D = 2° 38' 10" Rt.  
R = 0° 06' 00"  
L = 57295.80'  
T = 2636.11'  
T = 1318.29'

CURVE DATA FOR TRANSITION LT. LANES  
CONTROL ON MEDIAN EDGE  
P.I. 102.5' Rt. Sta. 340+66.23  
P.R.C. 71.11' Rt. Sta. 355+92.52  
P.T. 42.00' Rt. Sta. 375+91.64  
A = 2° 21' 25.07" Lt.  
D = 0° 09' 15.93"  
R = 37102.88'  
L = 1526.29'  
T = 763.25'

B.M. #39 Lag Bolt in base of 10" W. Cherry  
80' Rt. of Sta. 358+00  
Elev. 867.28

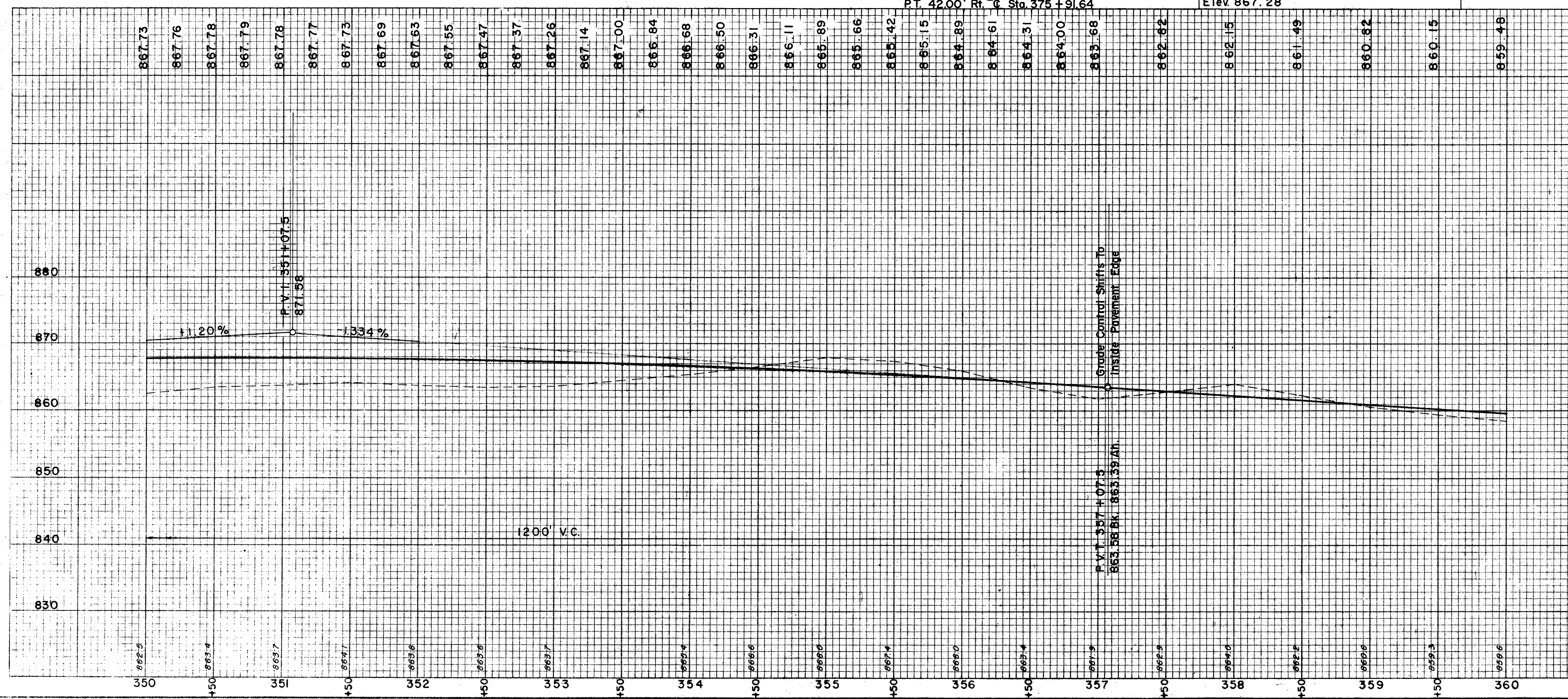

(R) ROADWAY

REF. NO.	STATION	SIDE	TO	UNITS
I-15	350+00	LT	1000	450
2-D	350+00	RT	354+50	450
3-R	350+00	RT	360+00	57
TOTAL				1450

REF. NO.	STATION	SIDE	TO	UNITS
I-15	350+00	LT	1000	450
2-D	350+00	RT	354+50	450
3-R	350+00	RT	360+00	57
TOTAL				1450

(D) DRAINAGE

REF. NO.	STATION	SIDE	TO	UNITS
I-4	350+00	LT	1000	112
6" PIPE UNDER-DRAIN (SHALLOW) (DEEP)	350+00	RT	400	110
6" PIPE UNDER-DRAIN (DEEP)	350+00	RT	400	60
6" PIPE UNDER-DRAIN (DEEP)	350+00	RT	400	215
6" PIPE UNDER-DRAIN (DEEP)	350+00	RT	400	57
6" PIPE UNDER-DRAIN (DEEP)	350+00	RT	400	206
6" PIPE UNDER-DRAIN (DEEP)	350+00	RT	400	19
6" PIPE UNDER-DRAIN (DEEP)	350+00	RT	400	14
SUBTOTAL				221

STATION	SODDING LEFT DITCH		S.Y.
	DEPTH OF SODDING FT.	WIDTH OF SODDING FT.	
351+50	4.5	4.1	145
354+50	1.4	4.1	57
358+00	1.8	4.1	19
354+50	1.7	4.1	221
SUBTOTAL			221

STATION	SODDING RIGHT DITCH		S.Y.
	DEPTH OF SODDING FT.	WIDTH OF SODDING FT.	
350+00	5	4.1	110
351+50	6.5	4.1	60
353+00	2.6	4.1	60
354+50	1.5	4.1	170
SUBTOTAL			170

STATION	SODDING LEFT MEDIAN		S.Y.
	DEPTH OF SODDING FT.	WIDTH OF SODDING FT.	
357+00	3.5	6.1	215
360+00	4.2	6.1	7.1
SUBTOTAL			215

EXCAVATION	= 9,805	C.Y.
EMBANKMENT	= 33,885	C.Y.
EMBANKMENT +175%	= 39,815	C.Y.

STATION	SODDING RIGHT MEDIAN	S.Y.
350+00	4.2	112
351+50	3.5	206
358+00	4	96
360+00	4	318
SUBTOTAL		318

27 Oct. '58