

E-M

W-3

LAK-90-1487

FED. RD. DIVISION	STATE	PROJECT
2	OHIO	STATE

1/6

APR 16 1965
GROUND PHOTOGRAPH

LAKE COUNTY
LAK-1-12.89
PART - II

STATE OF OHIO DEPARTMENT OF HIGHWAYS

LAK - 1 - 12.89 PART - II

LAKE COUNTY

CONCORD TOWNSHIP

CONVENTIONAL SIGNS

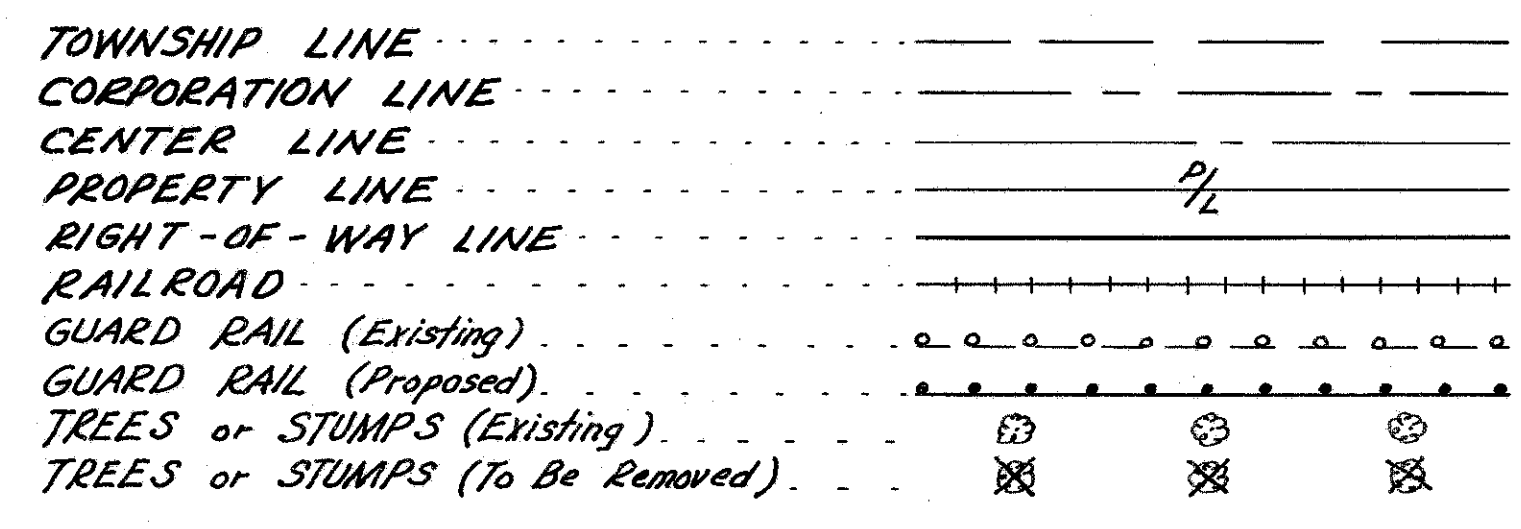

INDEX TO SHEETS

TITLE SHEET	1
TYPICAL SECTION, CALCULATIONS, GENERAL NOTES & GENERAL SUMMARY	2
PLAN & PROFILE, RIGHT-OF-WAY	3
CROSS SECTIONS	4, 5
SPECIFICATIONS FOR WATER LINE	6

LINE DATA

	LENGTH OF PROJECT	0 Lin. Ft. or	0 Mi.
BEGIN WORK	STA. 103+80		
END WORK	STA. 107+90		
	TOTAL LENGTH OF WORK	410 Lin. Ft. or	0.077 Mi.

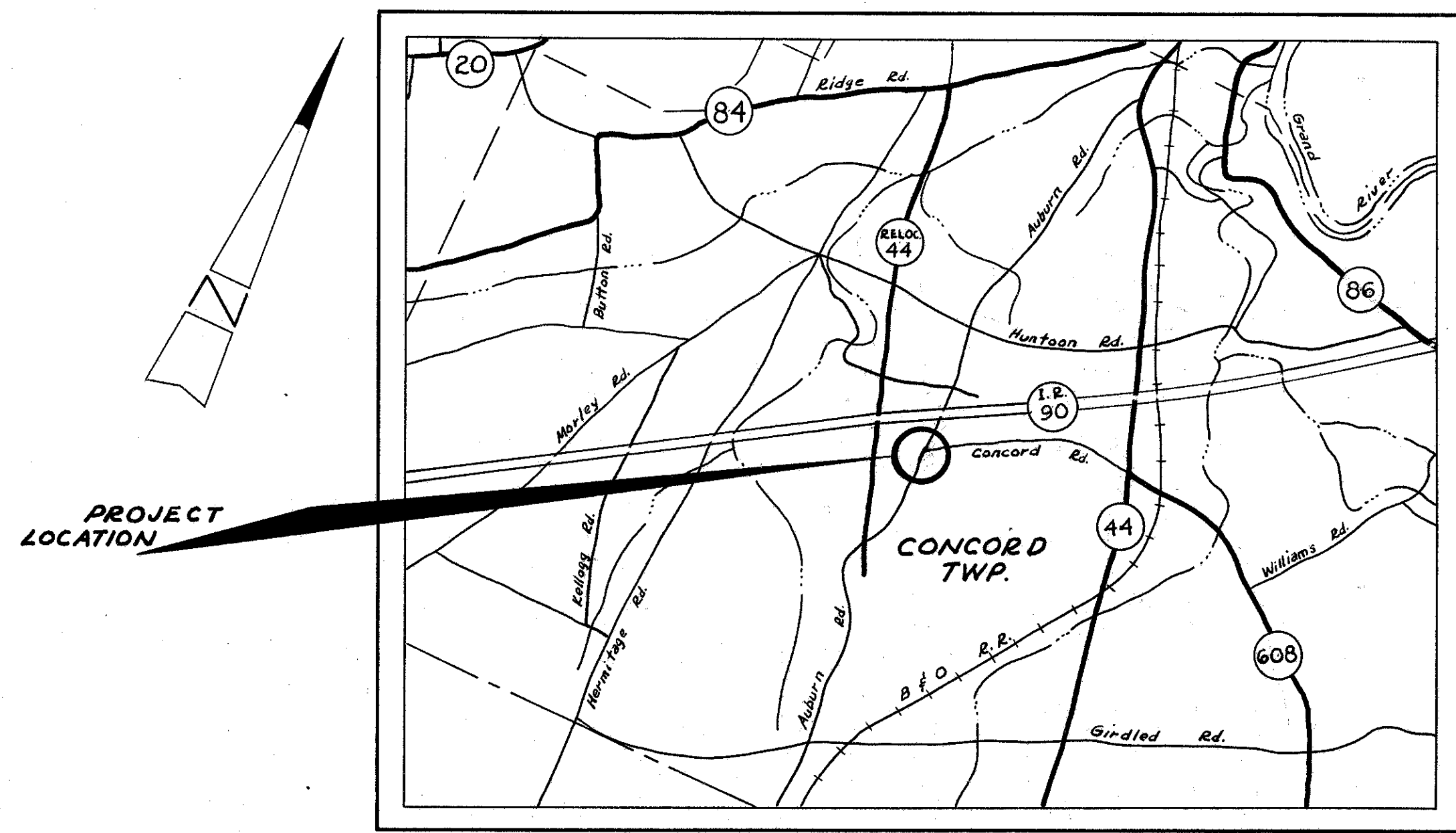

Delivery Point Painesville, Ohio Average Haul 2 Miles

LOCATION PLAN

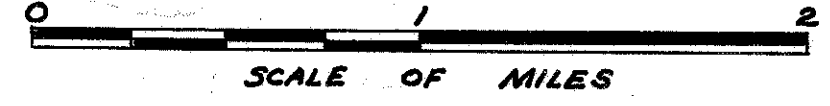
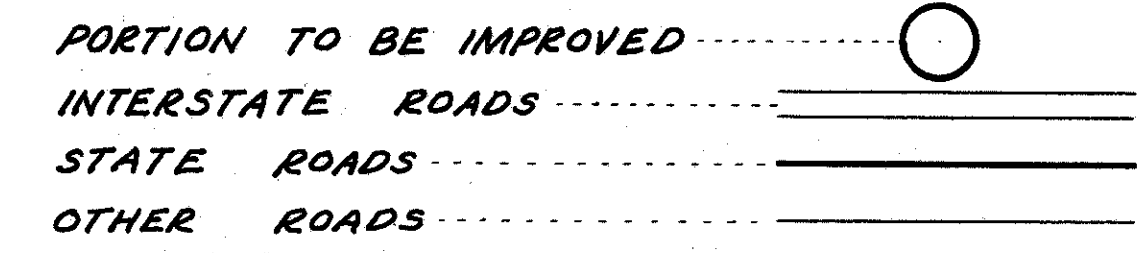

SCALE

PLAN 1" = 50'
 PROFILE HORIZONTAL 1" = 50'
 PROFILE VERTICAL 1" = 10'

The Standard Specifications of the State of Ohio Department of Highways including changes and Supplemental Specifications listed in the proposal shall govern this improvement.
 The right of way for this improvement will be provided by the State of Ohio.
 I hereby approve these plans and declare that the making of this improvement will not require the closing to traffic of the state highway and that provisions for the maintenance and safety of traffic will be as set forth on the plans and estimates.

Approved [Signature]
 Date 11/17/61 Division Deputy Director

Approved _____
 Date _____ Engineer of Bridges

Approved [Signature]
 Date 12-6-61 Engineer of Location & Design

Approved [Signature]
 Date 12-7-61 Deputy Director 1st Design & Construction

Approved [Signature]
 Date 12-6-61 Deputy Director of Right of Way

Approved [Signature]
 Date 2-5-62 Deputy Director of Planning & Programming

Approved [Signature]
 Date 2-5-62 First Assistant Director

Approved [Signature]
 Date 2-5-62 Director of Highways

STANDARD DRAWINGS			
L-3	4-1-50	G-7.07	6-1-56
L-3A	4-1-50	I-15 No.1	11-15-60
RI-1	7-15-58	L-1	4-1-50
T-35	1-2-56		

SUPPLEMENTAL SPECIFICATIONS		
I-124	Rev 3-20-61	

FILE No.	LAKE COUNTY LAK.1-12.89 PART.II
Date of Letting	
Contract No.	

00236

APR 16 1965
GROUND PHOTOGRAPH